



MOLLYMOOK MEN'S SHED PARKCARE ACTION PLAN

Document Number: D14/62134 • **Adopted:** 14/10/2014 • **Minute Number:** D14/268911 •
File: 37850E • **Produced By:** Assets and Works Group • **Review Date:** 14/10/2017

CONTACT INFORMATION

Group Name:	Mollymook Men's Shed	
Contact:	John Vine	
Address:	10 Wallaroy Drive, Burrill Lake	
Telephone:	4455 1197	
Reserve Name:	Callemondah Close	
Reserve Number:	SNW970	
Land Tenure:	Council Land	Comm. Land Type: Park

1. PARKCARE GROUP GOALS

To enhance and maintain the visual integrity and enhance the physical amenity of Callemondah Reserve.

2. SHOALHAVEN PARKCARE GROUP ACTIVITIES TABLE (to be in conjunction with attached site map)

NOTE: Priority should be rated as H = High (within 12 months); M = Medium (1-3 years); L = Low

GROUP ACTION	PRIORITY	METHOD	TIME
Clean park area, maintain native garden area	H	Hand tools	Ongoing
To maintain and paint existing parkland picnic tables	H	Hand tools	Ongoing

3. PARKCARE GROUP ACTION PLAN MAP

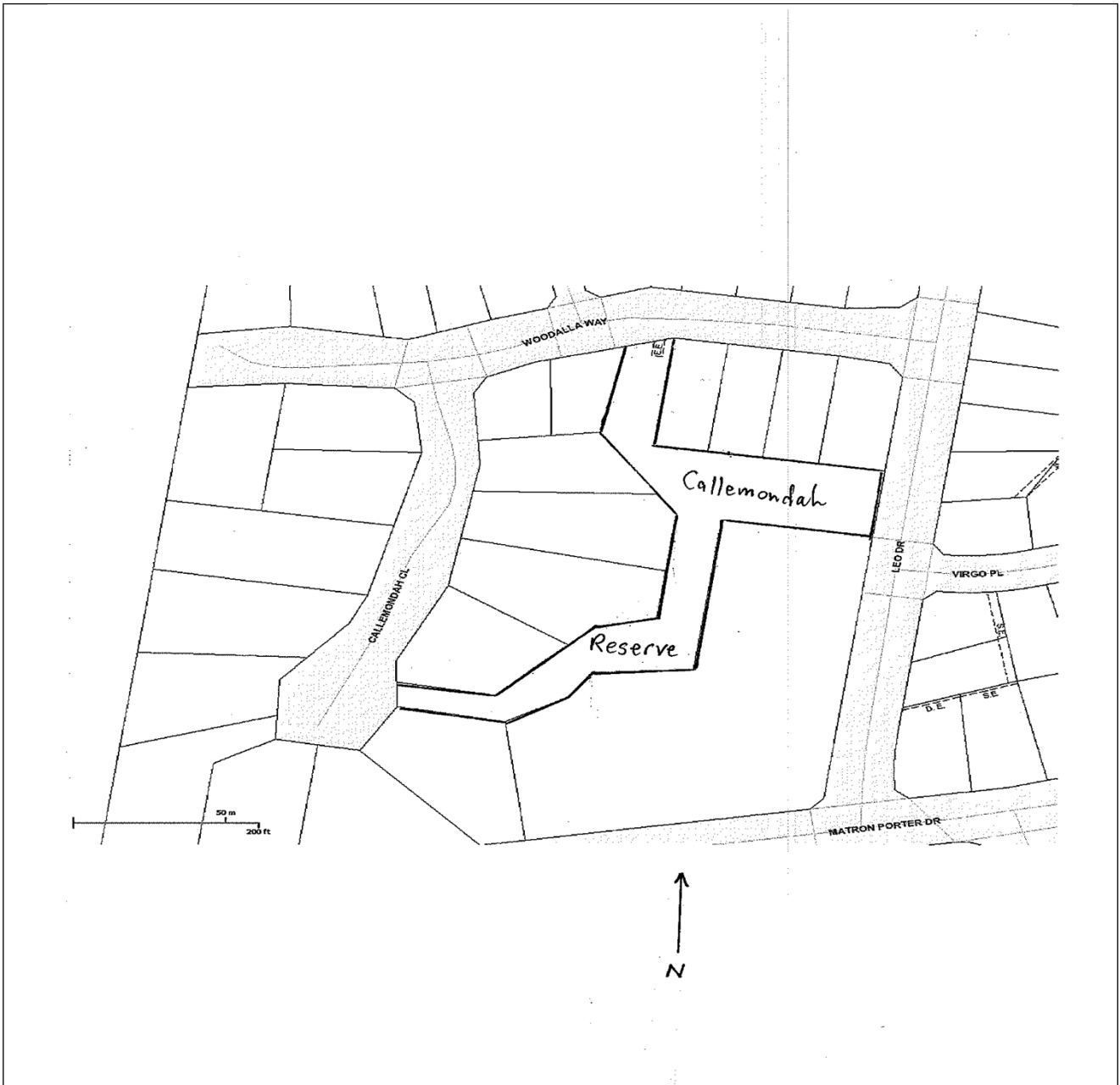

4. PARKCARE GROUP WHS & EQUIPMENT REQUIREMENTS

Type of Activity	SWMS name included
Landscape Construction & Maintenance	SWMS1200
Park Furnishings & Play Equipment Maintenance	SWMS1201
Roadside & Park Litter Collection	SWMS1172

5. COUNCIL SUPPORT

- Provision of building materials and paints as budget permits.
- Provision of landscape materials including plants and mulch as budget permits.
- Disposal of waste costs as necessary

6. HAS A SITE HAZARD AND RISK ASSESSMENT BEEN COMPLETED FOR THE PARKCARE SITE?

Yes

7. LIST THE PERSONAL PROTECTION EQUIPMENT REQUIRED FOR VOLUNTEERS WHILST WORKING ON THE SITE

PPE Equipment Required	Date issued
First Aid Kit	As requested
Gloves	As requested
Sunscreen	As requested
Insect repellent	As requested

8. POSSIBLE FUTURE FUNDING

Project	Funding source
None Proposed	

9. PLAN WILL BE REVIEWED EVERY THREE YEARS

10. PLEASE LIST OTHER LOCAL OR REGIONAL MANAGEMENT PLANS OR STRATEGIES THAT THIS PLAN RELATES TO

Name of document	Year it was produced	Produced by
Generic Plan of Management Parks No6	2005	SCC

11. RECOMMENDED PLANTING/REVEGETATION SPECIES LIST

OVERSTOREY TREES	
Botanical	Common
Nil	
SHRUBS	
Botanical	Common
Nil	
UNDERSTOREY (grasses, herbs, climbers)	
Botanical	Common
Nil	

12. SITE WEED LIST

Noxious	Environmental	Control Method
	Biddens Spp	By Hand
	Fishbone fern	By Hand
	Lonicera japonica	By Hand
	Osteospermum spp.	By Hand
	Senna bicapularis	By Hand

13. PARKCARE SITE SPECIES LIST

OVERSTOREY TREES	
Botanical	Common
Corymbia gummifera	Red Bloodwood
Eucalyptus eugenoides	Yellow Stringybark
Eucalyptus pilularis	BlackButt
Glochidion ferdinandi	Cheese Tree
Syncarpia glommulifera	Turpentine
SHRUBS	
Botanical	Common
Acacia parramattensis	Parramatta wattle
Acacia spp.	Blue Wattle
Allocasuarina littoralis	Black oak
Banksia ericifolia	Heath leaved Banksia
Banksia spinulosa	Hairpin Banksia
Callistemon viminalis	Weeping Bottlebrush
Dodonaea triquetra	Hop Bush
Epacris spp.	Heath
Grevillea spp.	
Hakea spp.	

Kunzea ambigua	Tick Bush
Lambertia formosa	Mountain Devil
Omalanthus populolius	Bleeding heart
Pittosporum undulatum	Sweet Pittosporum
Westringia spp.	Native rosemary
UNDERSTOREY (grasses, herbs, orchids)	
Botanical	Common
Gahnia spp	
Juncus spp	
Lomandra longifolia	Matt Rush
Themeda australis	Kangaroo Grass
UNDERSTOREY (vines & climbers)	
Botanical	Common
Hardenbergia violacea	Purple Coral Pea
Kennedia rubicunda	Running postman
Smilax glycyphylla	Sweet Sarsaparilla

Parkcare Group Name:.....

Coordinator Name:.....

Signature:

Date:/...../.....

