



MOLLYMOOK MEN'S SHED PARKCARE ACTION PLAN

Document Number: D14/62134 • **Adopted:** 14/10/2014 • **Minute Number:** D14/268911 •
File: 37850E • **Produced By:** Assets and Works Group • **Review Date:** 14/10/2017

CONTACT INFORMATION

| | | |
|------------------------|---------------------------------|------------------------------|
| Group Name: | Mollymook Men's Shed | |
| Contact: | John Vine | |
| Address: | 10 Wallaroy Drive, Burrill Lake | |
| Telephone: | 4455 1197 | |
| Reserve Name: | Callemondah Close | |
| Reserve Number: | SNW970 | |
| Land Tenure: | Council Land | Comm. Land Type: Park |

1. PARKCARE GROUP GOALS

To enhance and maintain the visual integrity and enhance the physical amenity of Callemondah Reserve.

2. SHOALHAVEN PARKCARE GROUP ACTIVITIES TABLE (to be in conjunction with attached site map)

NOTE: Priority should be rated as H = High (within 12 months); M = Medium (1-3 years); L = Low

| GROUP ACTION | PRIORITY | METHOD | TIME |
|---|-----------------|---------------|-------------|
| Clean park area, maintain native garden area | H | Hand tools | Ongoing |
| To maintain and paint existing parkland picnic tables | H | Hand tools | Ongoing |

3. PARKCARE GROUP ACTION PLAN MAP

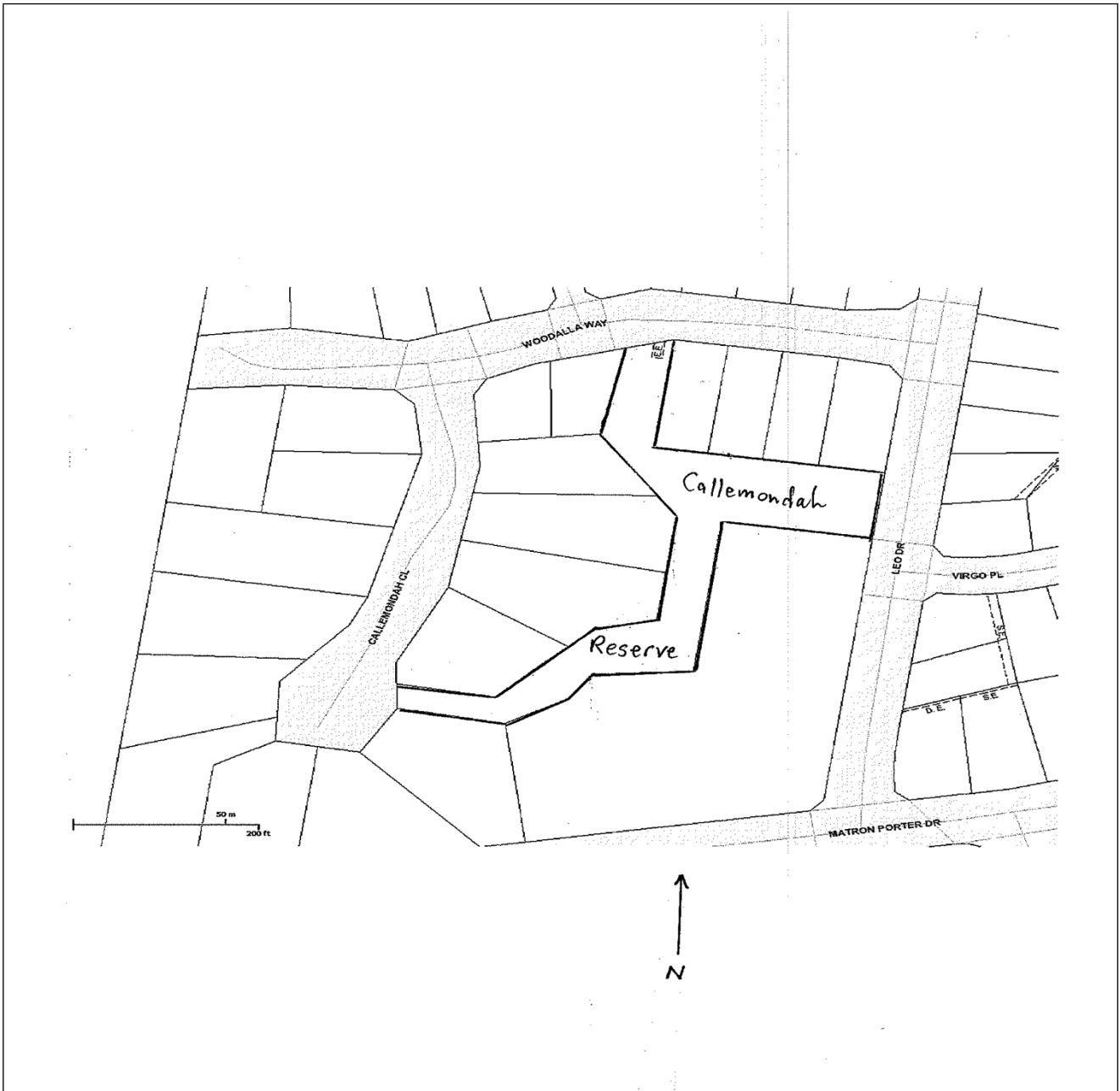

4. PARKCARE GROUP WHS & EQUIPMENT REQUIREMENTS

| Type of Activity | SWMS name included |
|---|--------------------|
| Landscape Construction & Maintenance | SWMS1200 |
| Park Furnishings & Play Equipment Maintenance | SWMS1201 |
| Roadside & Park Litter Collection | SWMS1172 |

5. COUNCIL SUPPORT

- Provision of building materials and paints as budget permits.
- Provision of landscape materials including plants and mulch as budget permits.
- Disposal of waste costs as necessary

6. HAS A SITE HAZARD AND RISK ASSESSMENT BEEN COMPLETED FOR THE PARKCARE SITE?

Yes

7. LIST THE PERSONAL PROTECTION EQUIPMENT REQUIRED FOR VOLUNTEERS WHILST WORKING ON THE SITE

| PPE Equipment Required | Date issued |
|------------------------|--------------|
| First Aid Kit | As requested |
| Gloves | As requested |
| Sunscreen | As requested |
| Insect repellent | As requested |

8. POSSIBLE FUTURE FUNDING

| Project | Funding source |
|---------------|----------------|
| None Proposed | |

9. PLAN WILL BE REVIEWED EVERY THREE YEARS

10. PLEASE LIST OTHER LOCAL OR REGIONAL MANAGEMENT PLANS OR STRATEGIES THAT THIS PLAN RELATES TO

| Name of document | Year it was produced | Produced by |
|--------------------------------------|----------------------|-------------|
| Generic Plan of Management Parks No6 | 2005 | SCC |

11. RECOMMENDED PLANTING/REVEGETATION SPECIES LIST

| OVERSTOREY TREES | |
|---|---------------|
| Botanical | Common |
| Nil | |
| SHRUBS | |
| Botanical | Common |
| Nil | |
| UNDERSTOREY (grasses, herbs, climbers) | |
| Botanical | Common |
| Nil | |

12. SITE WEED LIST

| Noxious | Environmental | Control Method |
|----------------|----------------------|-----------------------|
| | Biddens Spp | By Hand |
| | Fishbone fern | By Hand |
| | Lonicera japonica | By Hand |
| | Osteospermum spp. | By Hand |
| | Senna bicapularis | By Hand |

13. PARKCARE SITE SPECIES LIST

| OVERSTOREY TREES | |
|--------------------------|----------------------|
| Botanical | Common |
| Corymbia gummifera | Red Bloodwood |
| Eucalyptus eugenoides | Yellow Stringybark |
| Eucalyptus pilularis | BlackButt |
| Glochidion ferdinandi | Cheese Tree |
| Syncarpia glommulifera | Turpentine |
| SHRUBS | |
| Botanical | Common |
| Acacia parramattensis | Parramatta wattle |
| Acacia spp. | Blue Wattle |
| Allocasuarina littoralis | Black oak |
| Banksia ericifolia | Heath leaved Banksia |
| Banksia spinulosa | Hairpin Banksia |
| Callistemon viminalis | Weeping Bottlebrush |
| Dodonaea triquetra | Hop Bush |
| Epacris spp. | Heath |
| Grevillea spp. | |
| Hakea spp. | |

| | |
|--|--------------------|
| Kunzea ambigua | Tick Bush |
| Lambertia formosa | Mountain Devil |
| Omalanthus populolius | Bleeding heart |
| Pittosporum undulatum | Sweet Pittosporum |
| Westringia spp. | Native rosemary |
| UNDERSTOREY (grasses, herbs, orchids) | |
| Botanical | Common |
| Gahnia spp | |
| Juncus spp | |
| Lomandra longifolia | Matt Rush |
| Themeda australis | Kangaroo Grass |
| UNDERSTOREY (vines & climbers) | |
| Botanical | Common |
| Hardenbergia violacea | Purple Coral Pea |
| Kennedia rubicunda | Running postman |
| Smilax glyciphylla | Sweet Sarsaparilla |

Parkcare Group Name:.....

Coordinator Name:.....

Signature:

Date:/...../.....

