



 **PLACESCORE**

*Shoalhaven*  
City Council

# JUNCTION COURT REVITALISATION

NSW DPIE YOUR HIGH STREET GRANT PROJECT  
V2 CONCEPT DESIGN

09 JULY 2021



**WELCOME MAT** EXTENDING ONTO KINGHORNE STREET WITH RUMBLE STRIPS ACROSS CARRIAGEWAY TO SLOW DOWN CARS

**PAINTED GROUND MURAL:** ARTWORK REFERENCING COLOURS OF THE BLACK COCKATOO, LEGIBLY INDICATING FOCUS OF JUNCTION COURT AS A PLACE TO STAY

**GROUP SEATING:** MODULAR TIMBER SEATING WITH/WITHOUT BACKS AND ARMRESTS UNDER EXISTING TREES. STRIP LIGHTING PROVISION UNDER SEATS.

**FUTURE OUTDOOR DINING ZONE:** POCKETS OF DINING SPACE BETWEEN EXISTING TREES

**WELCOME MAT** ACROSS EXISTING LOADING DOCK TO REINFORCE PEDESTRIAN PRIORITY AND EXTEND THE INVITATION OUTSIDE JUNCTION COURT

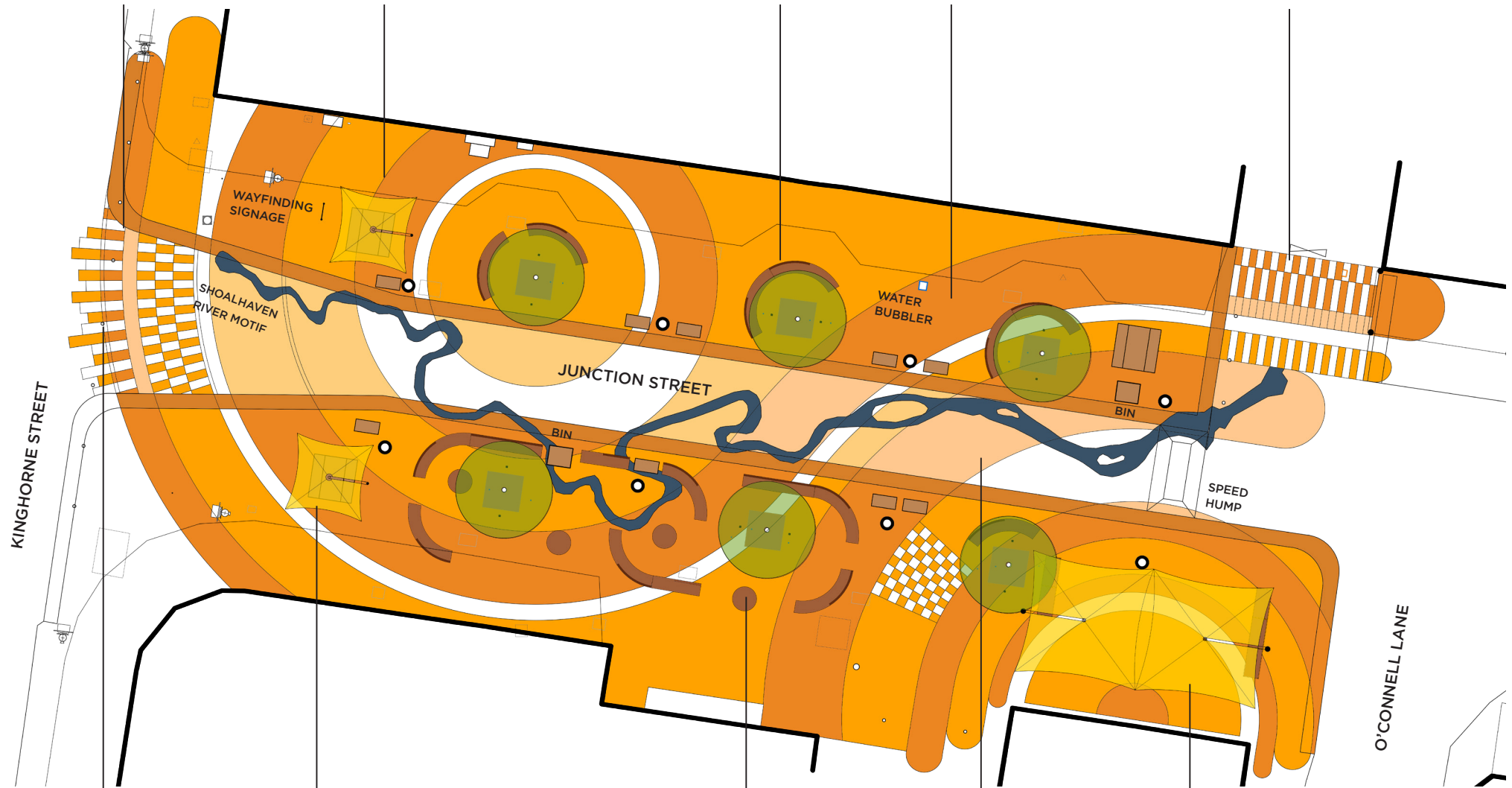

**REMOVABLE BOLLARDS** FOR TEMPORARY STREET CLOSURES IN EXISTING BOLLARD BOXES

**MULTIPURPOSE SPACE:** DAY TO DAY USE AS A SPACE TO SIT AND EAT UNDER SHELTER; PICNIC TABLES CAN BE MOVED WHEN LARGER SPACE REQUIRED FOR EVENTS

**PLAY ZONE:** PROTECTED SPACE FOR KIDS/ADULT PLAY WITH PLAYABLE SCULPTURES, GIANT CHESSBOARD AND GROUP SEATING

**SHARED ZONE:** NARROWED AND TREATED WITH DIFFERENT MATERIAL TO INDICATE SPACE WITH VEHICULAR MOVEMENT

**FLEXIBLE EVENT ZONE:** SPACE IN FRONT OF HERITAGE BUILDING, SHELTERED UNDER RETRACTABLE UMBRELLAS FOR RAINY DAY ACTIVITIES, EVENTS AND BUSKING

**REMOVABLE BOLLARDS** FOR TEMPORARY STREET CLOSURES IN EXISTING BOLLARD BOXES

**EXISTING TRAFFIC SIGNALS AND PUSH BUTTONS** ON EITHER SIDE OF SHARED ZONE RETAINED NON-COMPLIANT (DUE TO DISTANCE FROM SHARED ZONE)

**TACTILE AND PAINT BAND:** 600MM BAND OF TACTILE INDICATORS AND DARK PAINT TO DIFFERENTIATE SPACE WITH VEHICULAR MOVEMENT FROM THE STAYING PLACES

**EXISTING BOLLARDS** ALONG EITHER SIDE OF SHARED ZONE REMOVED AND REPLACED WITH OTHER OBJECTS ACTING AS BARRIERS (PLANTER BOXES AND BINS)

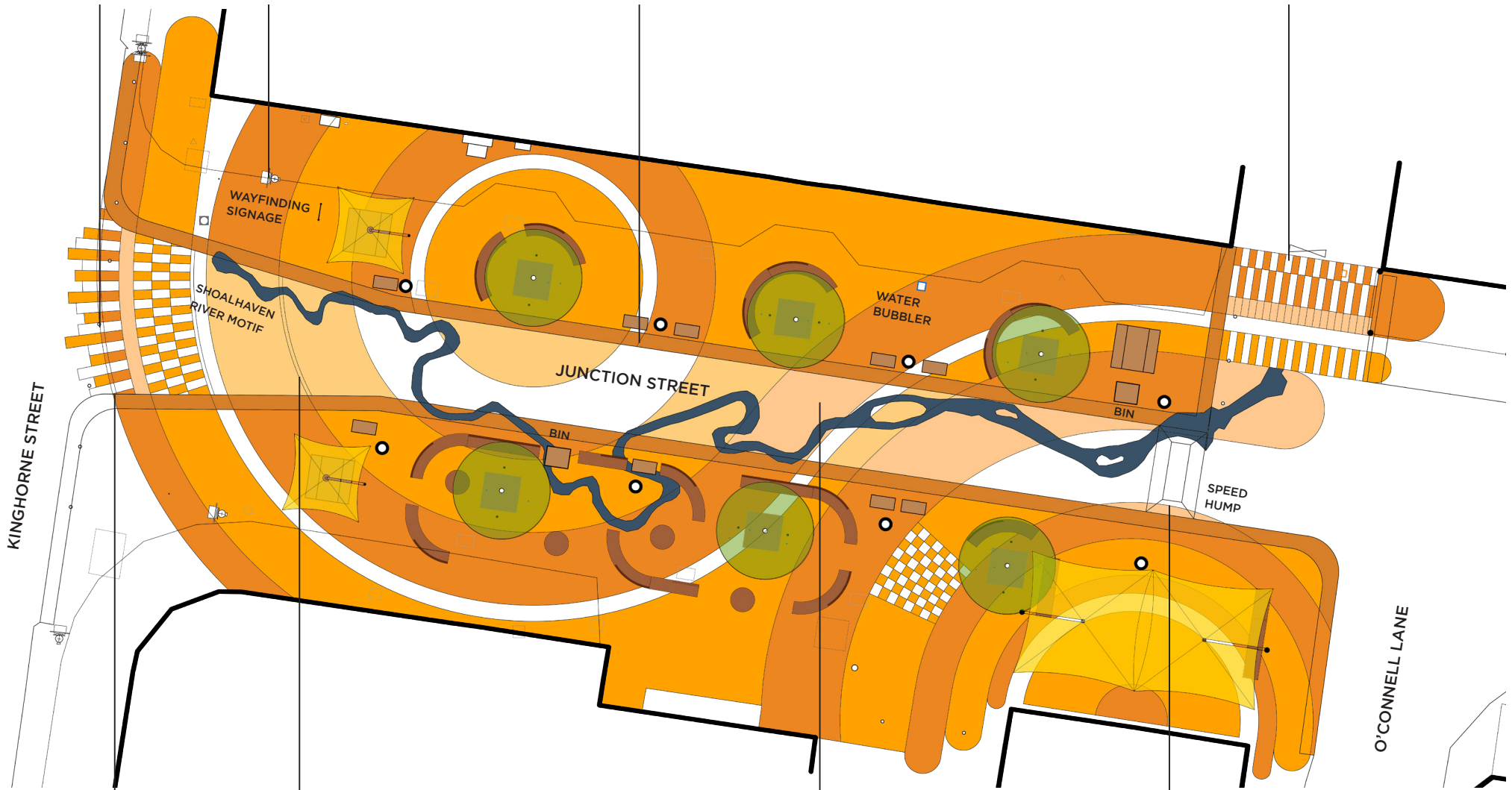

**ENTRY WIDTH OF SHARED ZONE:** 6.8M TO ACCOMMODATE SWEEPED PATHS OF 8.8M LONG VEHICLE TURNING FROM KINGHORNE STREET

**TRAFFIC CALMING:** RUMBLER STRIPS ACROSS SHARED ZONE, ALONG MURAL LINES TO SLOW DOWN CARS, NEAR KINGHORNE STREET ENTRY

**SHARED ZONE:** 3.6M WIDE AND TREATED WITH 'DURATHERM' MATERIAL THAT LOOKS DIFFERENT FROM THE PAINTED MURAL TO CLEARLY DIFFERENTIATE SPACE WITH VEHICULAR MOVEMENT FROM THE STAYING PLACES

**SPEED HUMP:** EXISTING SPEED HUMP REBUILT TO ALIGN WITH SHARED ZONE WIDTH

DARK PAINT BANDS WITH RUMBLE STRIPS ACROSS SHARED ZONE AT KINGHORNE STREET INTERSECTION

DARK ORANGE PAINT BAND OVER TACTILE INDICATORS ALONG EITHER SIDE OF SHARED ZONE

CIRCLE 1 AROUND EXISTING TREE WITH CONCENTRIC RINGS OF PAINT

EXISTING TREE PITS WITH POLY-BOUND POROUS PAVEMENT (FILTERPAVE)

SHOALHAVEN RIVER MOTIF HIGHLIGHTED WITH SOLID BLUE PAINT

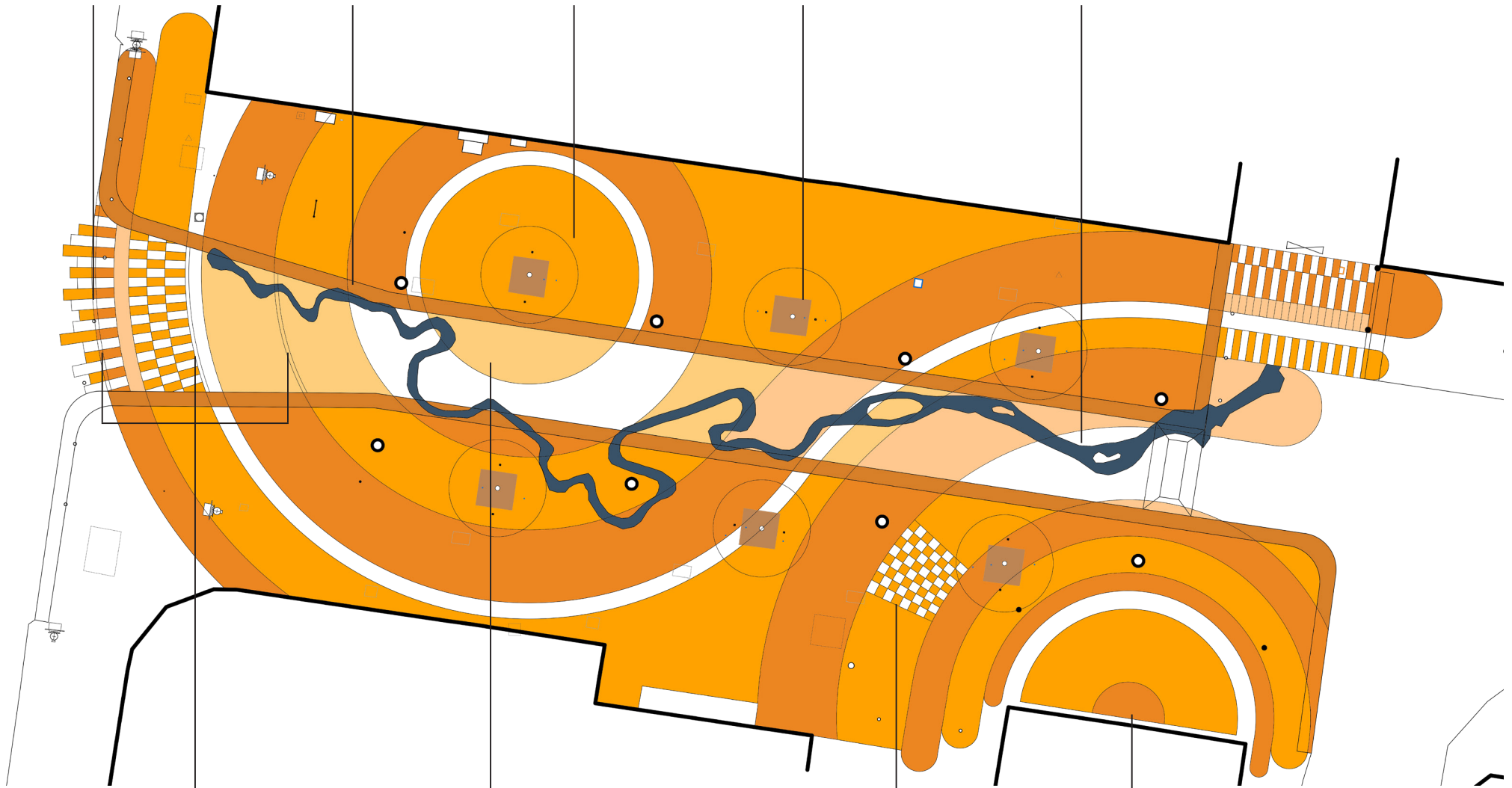

PAINTED RUMBLE STRIPS ACROSS SHARED ZONE ALONG MURAL LINES

'DURATHERM' YELLOW AND ORANGE MATERIAL WITHIN SHARED ZONE

CHESSBOARD PATTERN PAINTED AS PART OF THE GROUND MURAL

CIRCLE 2 WITH REFERENCE TO EXISTING HERITAGE BUILDING WITH CONCENTRIC RINGS OF PAINT





DURATHERM SURFACE FOR CARRIAGEWAY



TACTILE INDICATORS PAINTED OVER WITH BAND OF MURAL COLOURS



RUMBLE STRIP PAINTED WITH MURAL COLOURS ACROSS CARRIAGEWAY

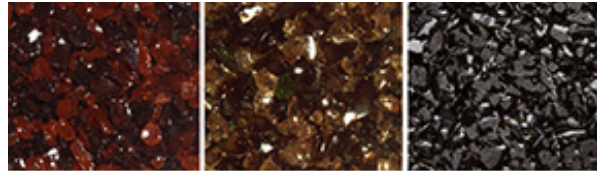

POLY-BOUND POROUS PAVEMENT FOR TREE PITS

FOR MORE INFORMATION  
PLEASE CONTACT PLACE SCORE

PLACESCORE.ORG  
+61 (2) 8021 7027