

# PROPOSED PEDESTRIAN REFUGE ELIZABETH DRIVE/FREDERICK STREET, VINCENTIA

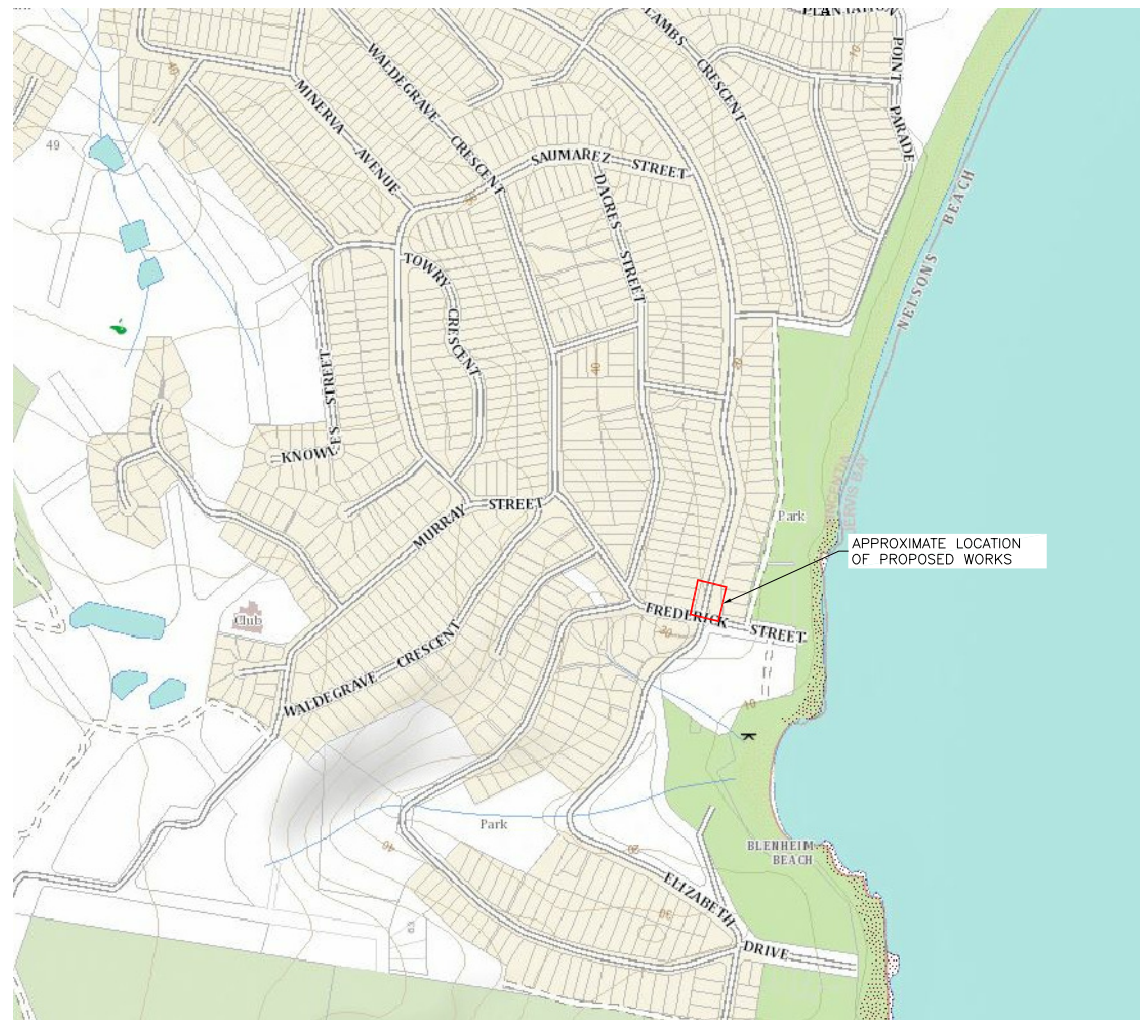

LOCALITY PLAN  
NOT TO SCALE



## SHEET INDEX

DRAWING No.	SCC REF. No.	DESCRIPTION
2156-C200	1529.XX	TITLE SHEET
2156-C201	1529.XX	SURVEY AND SERVICES PLAN
2156-C202	1529.XX	SGD11 PLAN AND SCHEDULE
2156-C203	1529.XX	EROSION AND SEDIMENT CONTROL PRINCIPLES PLAN
2156-C204	1529.XX	GENERAL ARRANGEMENT AND SIGNAGE AND LINEMARKING PLAN
2156-C205	1529.XX	KERB PLANS AND LONGITUDINAL SECTION
2156-C206	1529.XX	MK01 CROSS SECTIONS
2156-C207	1529.XX	CONSTRUCTION DETAILS

### GENERAL NOTES:

1. READ THESE NOTES IN CONJUNCTION WITH OTHER ENGINEERING DRAWINGS AND SPECIFICATIONS, AND WITH SUCH OTHER WRITTEN INSTRUCTIONS ISSUED. REFER TO CIVIL DRAWINGS FOR SETTING OUT AND DETAILED DIMENSIONS. REFER ANY DISCREPANCIES BETWEEN DOCUMENTATION TO SUPERINTENDENT BEFORE PROCEEDING WITH WORK.
2. SUBMIT DETAILS OF CHANGES TO SCOPE, WORK METHODS OR MATERIALS ETC FOR APPROVAL BEFORE PROCEEDING. APPROVAL DOES NOT AUTHORISE A VARIATION TO THE CONTRACT.
3. NOMINATION OF PROPRIETARY ITEMS DOES NOT INDICATE EXCLUSIVE PREFERENCE, BUT INDICATES REQUIRED PROPERTIES OF THE ITEM. SIMILAR ALTERNATIVES HAVING THE REQUIRED PROPERTIES MAY BE OFFERED FOR APPROVAL. APPROVAL DOES NOT AUTHORISE A VARIATION TO THE CONTRACT. INSTALL PROPRIETARY ITEMS IN ACCORDANCE WITH MANUFACTURERS REQUIREMENTS AND RECOMMENDATIONS.
4. DO NOT OBTAIN DIMENSIONS BY SCALING FROM DRAWING.
5. DIMENSIONS ARE IN METRES, LEVELS ARE IN METRES UNO, CHAINAGE ARE IN METRES UNO.
6. MAINTAIN STRUCTURES IN A STABLE CONDITION DURING CONSTRUCTION AND PROVIDE TEMPORARY BRACING AND/OR SUPPORT AS REQUIRED. PROVIDE SPREADERS AT LOADS AND/OR LIFTING POINTS WHERE REQUIRED. ENSURE NO PART IS OVERSTRESSED. DO NOT PLACE OR STORE BUILDING MATERIALS ON STRUCTURAL MEMBERS WITHOUT SUPERINTENDENTS APPROVAL. PROVIDE CALCULATIONS TO PROVE ADEQUACY OF STRUCTURE FOR PROPOSED CONSTRUCTION METHOD AND LOADS.
7. UNLESS NOTED OTHERWISE THESE DRAWING DO NOT DETAIL TEMPORARY WORKS. CONSTRUCTION METHODS AND TEMPORARY WORK ARE RESPONSIBILITY OF THE CONTRACTOR.
8. OBTAIN REQUIREMENTS FOR ADJOINING ELEMENTS TO BE FIXED TO OR SUPPORTED ON WORK AND PROVIDE FOR REQUIRED FIXINGS. DRAWINGS DO NOT SHOW DETAILS OF ALL FIXTURES, INSERTS, SLEEVES, RECESSES OR OPENINGS ETC REQUIRED. PROVIDE FOR TEMPORARY SUPPORT OF ADJOINING ELEMENTS DURING CONSTRUCTION.
9. WHERE NEW WORK ABUTS EXISTING PROVIDE SMOOTH TRANSITION FREE OF ABRUPT CHANGES.
10. BUILD FABRICATE AND PROCURE ONLY FROM DRAWING 'ISSUED FOR CONSTRUCTION'.

ISSUE	DESCRIPTION	DATE
1	FOR 80% DESIGN APPROVAL	29/06/22

FOR DESIGN APPROVAL  
NOT FOR CONSTRUCTION

FOOTPRINT (NSW) PTY. LTD. AUTHORISE THE USE OF THIS DRAWING ONLY FOR THE PURPOSE DEMONSTRATED BY THE STATUS STAMP SHOWN ABOVE.

SCALES

AS NOTED

ORIGINAL

A1

SURVEYOR: KEATLEY

DATUM: AHD

AZIMUTH: MGA2020

DRAWN: AB

DESIGNED: AB

DESIGNED DATE: JUN 2022

CHECKED: AB



PROPOSED PEDESTRIAN REFUGE  
ELIZABETH DRIVE/FREDERICK STREET, VINCENTIA

TITLE SHEET

DRAWING NO.  
2156-C200

ISSUE  
1

SHEET 1 OF 8



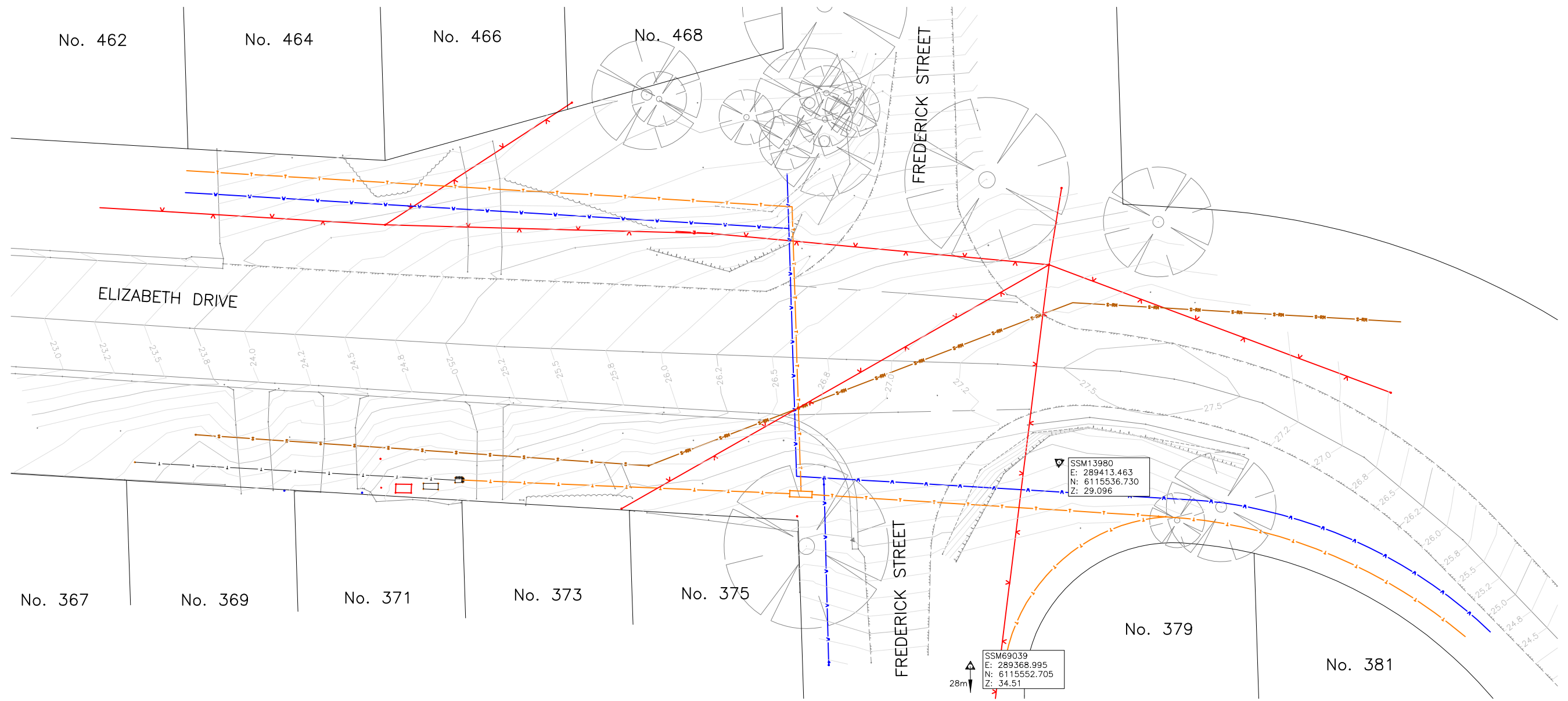

**SURVEY AND SERVICES PLAN**

SCALE 1:200 @ A1, 1:400 @ A3  
4 2 0 4 8 1:200



**EXISTING FEATURES LEGEND**

- EXISTING PROPERTY BOUNDARY
- EXISTING KERB AND GUTTER
- EXISTING EDGE OF BITUMEN
- EXISTING LINEMARKING
- EXISTING TOP OF BATTER
- EXISTING BOTTOM OF BATTER
- EXISTING FENCE
- EXISTING CONTOURS (0.5m INTERVAL)
- EXISTING EDGE OF VEGETATION/GARDEN
- EXISTING TREE (TO BE RETAINED UNO)

**EXISTING SERVICES LEGEND**

- EXISTING TELECOMMUNICATIONS SERVICES C
- EXISTING SEWER C
- EXISTING SEWER RISING MAIN D
- EXISTING WATER MAINS C
- EXISTING OVERHEAD POWER N/A

AS5488-2019  
QUALITY LEVEL



1	FOR 80% DESIGN APPROVAL	29/06/22
ISSUE	DESCRIPTION	DATE

**FOR DESIGN APPROVAL  
NOT FOR CONSTRUCTION**

FOOTPRINT (NSW) PTY. LTD. AUTHORISE THE USE OF THIS DRAWING ONLY FOR THE PURPOSE DEMONSTRATED BY THE STATUS STAMP SHOWN ABOVE.

SCALES	SURVEYOR: KEATLEY
AS NOTED	DATUM: AHD
ORIGINAL	AZIMUTH: MGA2020
A1	DRAWN: AB
	DESIGNED: AB
	DESIGNED DATE: JUN 2022
	CHECKED: AB

**footprint**  
sustainable engineering  
a. 15 meehan drive  
kiama downs nsw 2533  
p. 02 4237 6770  
m. 0430 421 661

**PROPOSED PEDESTRIAN REFUGE**  
ELIZABETH DRIVE/FREDERICK STREET, VINCENTIA

SURVEY AND SERVICES PLAN

DRAWING NO. 2156-C201
ISSUE 1
SHEET 2 OF 8

**1529.XX**

City Council



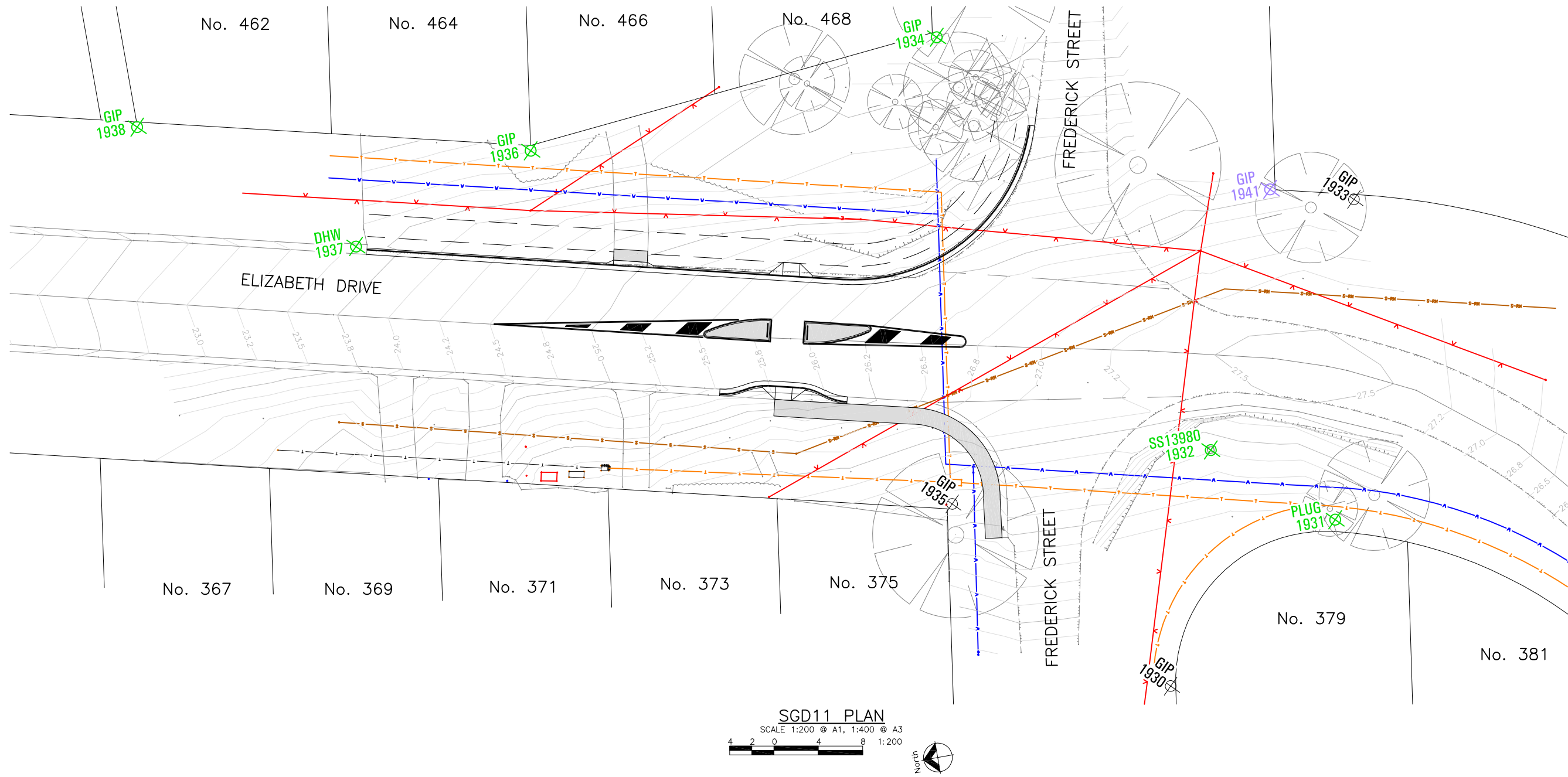

**SURVEY MARK PROTECTION:**

- IN ACCORDANCE WITH SECTION 24(1) OF THE SURVEYING AND SPATIAL INFORMATION ACT 2002 A PERSON MUST NOT REMOVE, DAMAGE, DESTROY, DISPLACE, OBLITERATE OR DEFACE ANY SURVEY MARK UNLESS AUTHORISED TO DO SO BY THE SURVEYOR GENERAL. IN THIS REGARD ANY PROPOSED CONSTRUCTION WORK THAT MAY AFFECT A STATE SURVEY MARK CANNOT BE UNDERTAKEN UNTIL A REGISTERED SURVEYOR IS ENGAGED TO ARRANGE ITS RELOCATION, IN ACCORDANCE WITH THE REQUIREMENTS OF THE NSW GOVERNMENT LAND AND PROPERTY INFORMATION.
- REFER TO SURVEY MARK AUDIT SCHEDULE FOR IMPACTED MARKS
- THE CONTRACTOR SHALL AT ALL TIMES BE RESPONSIBLE TO THE PROTECTION OF EXISTING SURVEY MARKS IN ACCORDANCE WITH THE REQUIREMENTS OF ANY PRESERVATION OF SURVEY INFRASTRUCTURE STRATEGY REPORT AND SPATIAL SERVICES CONDITIONAL APPROVAL.

Project Mark ID	SCIMS Mark ID	Type	Origin	Phase 1 - Investigation				Field Audit				Phase 2 - Proposed Impact			Phase 3 - Work As Executed			Comments				
				Coordinates				GDA				AHD				Pre-Construction Audit			Post Construction Field Audit			
				Datum	Easting	Northing	Zone	Coord Source	Class	PU	LU	RL	Class	PU	LU	Mark Status	Search Date		Mark Status	Project Impact	Inspection Date	Mark Impact
1930		GIP	DP216860	GDA2020	289393.118	6115543.999	56	Calculated							Not Found	14/02/2022	Not Found	Already Gone				
1931		PLUG	DP216860	GDA2020	289405.324	6115526.767	56	Traverse							Found Intact	14/02/2022	Found Intact	Safe				
1932	SS13980	SSM	SCIMS	GDA2020	289413.463	6115536.73	56	SCIMS	8	0.03	0.03	29.096	0.12	0.04	Found Intact	14/02/2022	Found Intact	Safe				
1933		GIP	DP203169	GDA2020	289433.495	6115520.075	56	Calculated							Destroyed	14/02/2022	Destroyed	Already Gone				
1934		GIP	DP28174	GDA2020	289454.445	6115554.632	56	Traverse							Found Intact	14/02/2022	Found Intact	Safe				
1935		GIP	DP28172	GDA2020	289412.729	6115560.575	56	Calculated							Not Found	14/02/2022	Not Found	Already Gone				
1936		GIP	DP28174	GDA2020	289450.723	6115592.504	56	Traverse							Found Intact	14/02/2022	Found Intact	Safe				
1937		DHW	UNKNOWN	GDA2020	289444.953	6115609.539	56	Traverse							Found Intact	14/02/2022	Found Intact	Safe				
1938		GIP	DP620101	GDA2020	289458.987	6115627.119	56	Traverse							Found Intact	14/02/2022	Found Intact	Safe				
1941		GIP	DP203169	GDA2020	289435.702	6115527.382	56	Calculated							Not Searched	14/02/2022	Not Found	Safe				

FOR DESIGN APPROVAL	NOT FOR CONSTRUCTION
1	FOR 80% DESIGN APPROVAL
ISSUE	DESCRIPTION
	DATE

FOR DESIGN APPROVAL  
NOT FOR CONSTRUCTION

FOOTPRINT (NSW) PTY. LTD. AUTHORISE THE USE OF THIS DRAWING ONLY FOR THE PURPOSE DEMONSTRATED BY THE STATUS STAMP SHOWN ABOVE.

SCALES	SURVEYOR: KEATLEY
AS NOTED	DATUM: AHD
ORIGINAL	AZIMUTH: MGA2020
A1	DRAWN: AB
	DESIGNED: AB
	DESIGNED DATE: JUN 2022
	CHECKED: AB

**footprint**  
sustainable engineering  
a. 15 meehan drive  
kiama downs nsw 2533  
p. 02 4237 6770  
m. 0430 421 661

**PROPOSED PEDESTRIAN REFUGE**  
ELIZABETH DRIVE/FREDERICK STREET, VICENTIA

SGD11 PLAN AND SCHEDULE

DRAWING NO.	1529.XX
1516-C202	
ISSUE	1
SHEET	3 OF 8

**GENERAL REQUIREMENTS**

THE FOLLOWING EROSION AND SEDIMENT CONTROL PLAN (ESCP) HAS BEEN DEVELOPED IN GENERAL ACCORDANCE WITH LANDCOM (2004) – MANAGING URBAN STORMWATER: SOILS AND CONSTRUCTION, OTHERWISE KNOWN AS "THE BLUE BOOK". THE CONTRACTOR SHALL BE AT ALL TIMES RESPONSIBLE FOR TAILORING THE EROSION AND SEDIMENT CONTROL PLAN TO SUIT SITE CONDITIONS. AS CONSTRUCTION PROGRESSES THE CONTRACTOR SHALL AMEND THE EROSION AND SEDIMENT CONTROL PLAN ACCORDINGLY. IT IS THE CONTRACTOR'S RESPONSIBILITY ALL TIMES TO ENSURE THAT THE EROSION AND SEDIMENT MANAGEMENT MEASURES COMPLY WITH THE REQUIREMENTS OF THE BLUE BOOK.

**SITE ESTABLISHMENT**

PRIOR TO THE COMMENCEMENT OF EARTHWORKS ON THE SITE THE FOLLOWING SHALL BE UNDERTAKEN AS A MINIMUM:

1. ERECT SAFETY FENCING WITH SIGNAGE CLEARLY INDICATING THAT THE SITE IS A CONSTRUCTION ZONE AND ACCESS IS RESTRICTED AS DEEMED NECESSARY.
2. ERECT CLEARLY VISIBLE BARRIER FENCING AT LOCATIONS SHOWN OR IF NOT SHOWN AT THE DISCRETION OF THE SITE SUPERINTENDENT TO ENSURE TRAFFIC IS CONTROLLED AND TO PROHIBIT UNNECESSARY SITE DISTURBANCE.
3. INSTALL STABILISED SITE ACCESS IN ACCORDANCE WITH STANDARD DRAWING SD6-14 AT EACH SITE ACCESS POINT TO PREVENT CONSTRUCTION EQUIPMENT FROM CARRYING SEDIMENT OFF THE SITE ONTO SURROUNDING ROADS AS REQUIRED.
4. INSTALL SEDIMENT AND EROSION CONTROL DEVICES IN ACCORDANCE WITH THE CONSTRUCTION DETAILS SPECIFIED IN THIS DRAWING SET AND/OR THE REQUIREMENTS OF THE 'BLUE BOOK'.

**CONSTRUCTION**

5. TOPSOIL FROM ALL AREAS TO BE DISTURBED, SHALL BE STRIPPED PRIOR TO CONSTRUCTION OF ANY WORKS AND STOCKPILED AND LATER RESPREAD TO AID REVEGETATION IN LOCATIONS WHERE SHOWN ON THIS DRAWING. TOPSOIL SHALL BE STOCKPILED IN WINDROWS OUTSIDE OF MAJOR FLOW AREAS.
6. ALL DRAINAGE WORKS SHALL BE CONSTRUCTED AND STABILISED AS EARLY AS POSSIBLE DURING DEVELOPMENT.
7. ALL TAIL-OUT DRAINS SHALL BE GRASSED AND TRAPEZOIDAL IN SECTION. HAY BALES SHALL BE PLACED AS A SEDIMENTATION CONTROL DEVICE WHERE REQUIRED.
8. ALL DISTURBED AREAS SHALL BE REVEGETATED AS SOON AS THE RELEVANT WORKS ARE COMPLETED. TOPSOIL SHALL BE AMELIORATED AND COMPOSTED TO LANDSCAPE ARCHITECTS SPECIFICATIONS.
9. INLET FILTERS WILL BE INSTALLED WHERE SHOWN TO PREVENT WATER FROM DIRECTLY ENTERING THE PERMANENT DRAINAGE SYSTEM UNLESS IT IS RELATIVELY SEDIMENT FREE. IF THE LOCATION OF INLET FILTERS ARE NOT SHOWN ON THE PLAN THEIR LOCATION SHALL BE AT THE DISCRETION OF THE SUPERINTENDENT.

**STOCKPILES**

10. SPOIL AND TOPSOIL STOCKPILES SHALL BE LOCATED NO CLOSER THAN 5m FROM EXISTING VEGETATION, CONCENTRATED WATER FLOW, ROADS AND HAZARD AREAS.
11. IF STOCKPILES ARE TO BE IN PLACE FOR LONGER THAN 10 DAYS THEN THEY SHALL BE STABILISED BY COVERING WITH MULCH OR WITH TEMPORARY VEGETATION.
12. STOCKPILES SHALL BE IN WINDROWS NO HIGHER THAN 2m HIGH AND SHALL HAVE BATTER SLOPES NO STEEPER THAN 1 IN 2. AN EARTH BANK SHALL BE INSTALLED ON THE UPSLOPE SIDE AND SEDIMENT FENCING SHALL BE INSTALLED ALONG THE LENGTH OF THE DOWNSLOPE SIDE ON ANY STOCKPILE.

**MAINTENANCE**

13. ALL SEDIMENT BASINS AND TRAPS SHALL BE CLEANED WHEN THE STRUCTURES ARE A MAXIMUM OF 60% FULL OF SOLID MATERIALS (INCLUDING DURING THE MAINTENANCE PERIOD) AND DISPOSED OF IN A MANNER THAT PREVENTS FURTHER POLLUTION OF THE SITE.
14. TEMPORARY SEDIMENT AND EROSION CONTROL DEVICES WILL BE RETAINED UNTIL AFTER THE LANDS THEY ARE PROTECTING, ARE COMPLETELY REHABILITATED.
15. THE CONTRACTOR WILL INSPECT THE SITE AT LEAST WEEKLY OR AFTER ANY STORM EVENT AND WILL:
  - ENSURE THAT DRAINS OPERATE PROPERLY AND TO EFFECT ANY NECESSARY REPAIRS;
  - REMOVE SPILLED SAND OR OTHER MATERIALS FROM HAZARD AREAS (E.G. LANDS CLOSER THAN FIVE METRES FROM AREAS OF LIKELY CONCENTRATED OR HIGH VELOCITY FLOWS ESPECIALLY DRAINS, WATERWAYS AND PAVED AREAS);
  - REMOVE TRAPPED SEDIMENT WHENEVER LESS THAN DESIGN CAPACITY REMAINS WITHIN THE STRUCTURE;
  - ENSURE REHABILITATED LANDS HAVE EFFECTIVELY REDUCED THE EROSION HAZARD AND TO INITIATE UPGRADING OR REPAIR AS APPROPRIATE;
  - CONSTRUCT ADDITIONAL EROSION AND/OR SEDIMENT CONTROL WORKS AS REQUIRED;
  - MAINTAIN EROSION AND SEDIMENT CONTROL MEASURES IN A FULLY FUNCTIONING CONDITION UNTIL ALL EARTHWORK ACTIVITIES ARE COMPLETED AND THE SITE IS REHABILITATED; AND
  - REMOVE TEMPORARY EROSION AND SEDIMENT CONTROL STRUCTURES AS THE LAST ACTIVITY IN THE REHABILITATION PROGRAM.
16. A SELF-AUDITING PROGRAM WILL BE ESTABLISHED BASED ON A CHECK SHEET. A SITE INSPECTION USING THE CHECK SHEET WILL BE MADE BY THE CONTRACTOR:
  - AT LEAST WEEKLY;
  - IMMEDIATELY BEFORE SITE CLOSURE;
  - IMMEDIATELY BEFORE FORECAST RAIN AND AFTER RAINFALL.
 ENTRIES WILL INCLUDE (BUT ARE NOT LIMITED TO):
  - a. THE VOLUME AND INTENSITY OF ANY RAINFALL EVENTS;
  - b. THE CONDITION AND MAINTENANCE OF ANY SOIL AND WATER MANAGEMENT PLAN WORKS;
  - c. THE CONDITION OF VEGETATION AND ANY NEED TO IRRIGATE;
  - d. THE NEED FOR DUST PREVENTION STRATEGIES; AND
  - e. ANY REMEDIAL WORKS TO BE UNDERTAKEN.
 - A SIGNED DUPLICATE OF THE CHECK SHEET SHOULD BE FORWARDED TO THE PROJECT MANAGER WEEKLY FOR THEIR INFORMATION. ALL CHECK SHEETS SHOULD BE COLLATED, KEPT ON-SITE AND MADE AVAILABLE TO ANY AUTHORISED PERSON ON REQUEST.

**SEQUENCE OF WORKS:**

1. INSTALL SOIL AND WATER MANAGEMENT MEASURES AS DETAILED.
2. DEMOLITION AS REQUIRED
3. CONSTRUCT ROADWORKS
4. REMOVE MANAGEMENT DEVICES ON SUCCESSFUL REHABILITATION.

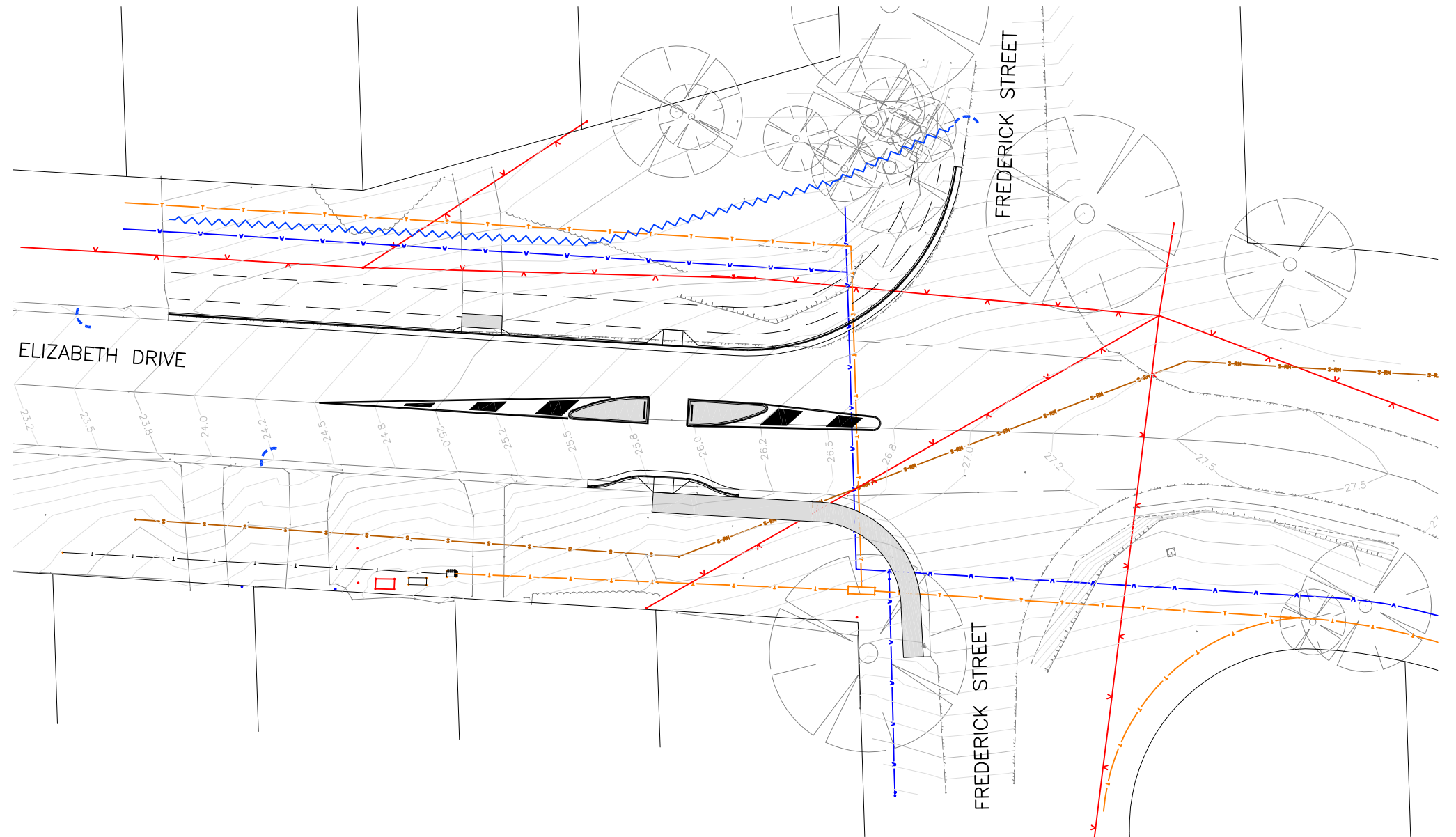

**EROSION AND SEDIMENT CONTROL PRINCIPLES PLAN**

SCALE 1:200 @ A1, 1:400 @ A3

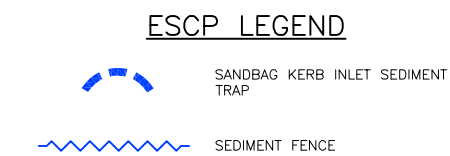
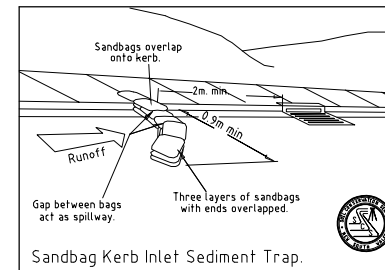
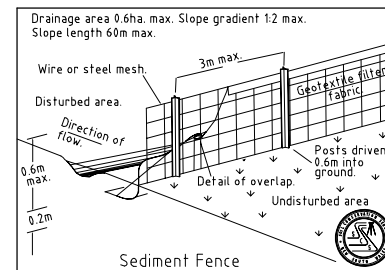

FOR DESIGN APPROVAL	FOR DESIGN APPROVAL	29/06/22
NOT FOR CONSTRUCTION	NOT FOR CONSTRUCTION	
1	FOR 80% DESIGN APPROVAL	29/06/22
ISSUE	DESCRIPTION	DATE

FOR DESIGN APPROVAL  
NOT FOR CONSTRUCTION

FOOTPRINT (NSW) PTY. LTD. AUTHORISE THE USE OF THIS DRAWING ONLY FOR THE PURPOSE DEMONSTRATED BY THE STATUS STAMP SHOWN ABOVE.

SCALES	AS NOTED
ORIGINAL	A1

SURVEYOR: KEATLEY
DATUM: AHD
AZIMUTH: MGA2020
DRAWN: AB
DESIGNED: AB
DESIGNED DATE: JUN 2022
CHECKED: AB

**footprint**  
sustainable engineering  
a. 15 meehan drive  
kiama downs nsw 2533  
p. 02 4237 6770  
m. 0430 421 661

**PROPOSED PEDESTRIAN REFUGE**  
ELIZABETH DRIVE/FREDERICK STREET, VICENTIA

EROSION AND SEDIMENT CONTROL PRINCIPLES PLAN

DRAWING NO.	2156-C203
ISSUE	1
SHEET	4 OF 8

Geelong City Council

SCC PLAN REFERENCE  
**1529.XX**

No. 462

No. 464

No. 466

No. 468

POTENTIAL LOCATION OF FUTURE SHARED USER PATH TO BE ASSESSED UNDER SEPARATE PROJECT



CONSTRUCT DRIVEWAY LABYBACK IN ACCORDANCE WITH SCC STD DWG 5104-07, INCLUDING RECONSTRUCTION OF EXISTING DRIVEWAY OVER 1.0m TO TIE INTO EXISTING IN ACCORDANCE WITH SCC STD DWG 2026-05

CONSTRUCT 1.5m WIDE KERB RAMP EACH SIDE



FREDERICK STREET



ELIZABETH DRIVE

CONSTRUCT APPROXIMATELY 67m OF BARRIER KERB AND GUTTER EXTENSION TO EXISTING. REFER TO LONGITUDINAL SECTION SHEET C205 AND CROSS SECTIONS SHEET C206

CHEVRON MARKING TO TNSW TDT 2011/01a (1.5m WIDTH AT 4.5m SPACINGS)

REMOVE 11.5m SECTION OF EXISTING KERB AND GUTTER AND CONSTRUCT 11.8m BARRIER KERB AND GUTTER TO ACCOMMODATE KERB BLISTER TO REFER TO LONGITUDINAL SECTION SHEET C205

CONSTRUCT 1.5m WIDE CONCRETE FOOTPATH WITH INTEGRAL HOB TO TOP SIDE TO BACK OF EXISTING KERB AND GUTTER IN ACCORDANCE WITH DETAIL ON SHEET C207



FREDERICK STREET

367

No. 369

No. 371

No. 373

No. 375

No. 379

No. 381

GENERAL ARRANGEMENT AND SIGNAGE AND LINEMARKING PLAN

NOTE: STREET LIGHTING IS TO BE PROVIDED IN ACCORDANCE WITH AS/NZS 1158

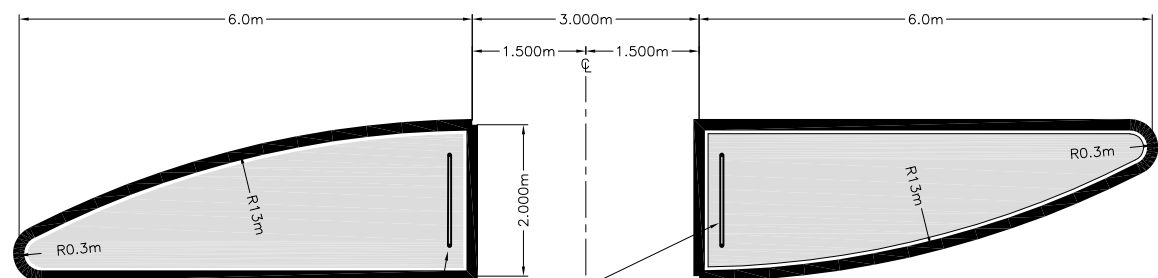

HOLDING RAIL EACH SIDE TO REFUGE ISLAND TYPICAL SECTION THIS SHEET

ALIGN CENTRE OF REFUGE ISLAND WITH CENTRE OF BACK OF KERB RAMP EITHER SIDE

REFUGE ISLAND DETAIL

SCALE 1:50 @ A1, 1:100 @ A3

R2-3(L) "KEEP LEFT" SIGN (IN FRONT) ON NOMINAL 50mm BORE GALVANISED POST, SECURED WITH POST SOCKET AS SHOWN OR AS PER HOLDING RAIL SLEEVE. ALTERNATIVELY SECURED TO SURFACE WITH BASE PLATE AND BOLT SETUP

50NB STEEL PIPE HOLDING RAIL POWDER COATED GOLDEN YELLOW

USE METAL WEDGE TO SECURE HOLDING RAIL IN STEEL PIPE SLEEVE

N25 PLAIN MASS CONCRETE INFILL

KERB FACE TO BE PAINTED WITH REFLECTIVE WHITE PAINT.

SAW CUT EXISTING AC AND REMOVE FOR KERB CONSTRUCTION. CORRECT WITH AC TO NEW KERB FACE AS REQUIRED.

65NB STEEL PIPE SLEEVE

VARIABLE (MAX 2500)

200x200 CONCRETE FOOTING

CLASS 2 REFLECTIVE TAPE DETAIL

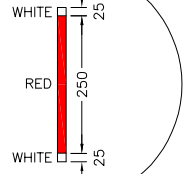

REFUGE ISLAND TYPICAL SECTION

SCALE 1:10

SIGNAGE AND LINEMARKING NOTES

- ALL SIGNAGE AND LINEMARKING TO BE INSTALLED IN ACCORDANCE WITH AS1742
- ALL REDUNDANT LINEMARKING IS TO BE REMOVED BY HIGH PRESSURE WATER BLASTING, SHOT BLASTING OR OTHER APPROVED METHODS. PAINT SHALL NOT BE USED WITHOUT THE PRIOR APPROVAL OF THE SUPERINTENDENT.
- ERECT NEW W6-1 AND SUPPLEMENTARY W8-25 SIGN ON EACH ELIZABETH DRIVE APPROACH APPROXIMATELY 80m IN ADVANCE OF PROPOSED PEDESTRIAN REFUGE.



SIGNAGE LEGEND

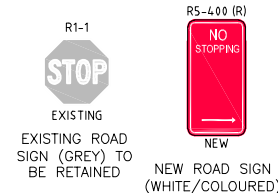

LINEMARKING LEGEND

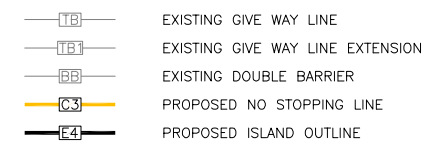

ISSUE	DESCRIPTION	DATE
1	FOR 80% DESIGN APPROVAL	29/06/22

FOR DESIGN APPROVAL  
NOT FOR CONSTRUCTION

FOOTPRINT (NSW) PTY. LTD. AUTHORISE THE USE OF THIS DRAWING ONLY FOR THE PURPOSE DEMONSTRATED BY THE STATUS STAMP SHOWN ABOVE.

SCALES	SURVEYOR: KEATLEY
AS NOTED	DATUM: AHD
ORIGINAL	AZIMUTH: MGA2020
A1	DRAWN: AB
	DESIGNED: AB
	DESIGNED DATE: JUN 2022
	CHECKED: AB

**footprint**  
sustainable engineering  
a. 15 meehan drive  
kiama downs nsw 2533  
p. 02 4237 6770  
m. 0430 421 661

**PROPOSED PEDESTRIAN REFUGE**  
ELIZABETH DRIVE/FREDERICK STREET, VICENTIA

GENERAL ARRANGEMENT AND SIGNAGE AND LINEMARKING PLAN

DRAWING NO. 2151-C204	
ISSUE. 1	
SHEET 5 OF 8	

SCC PLAN REFERENCE: 1529.XX



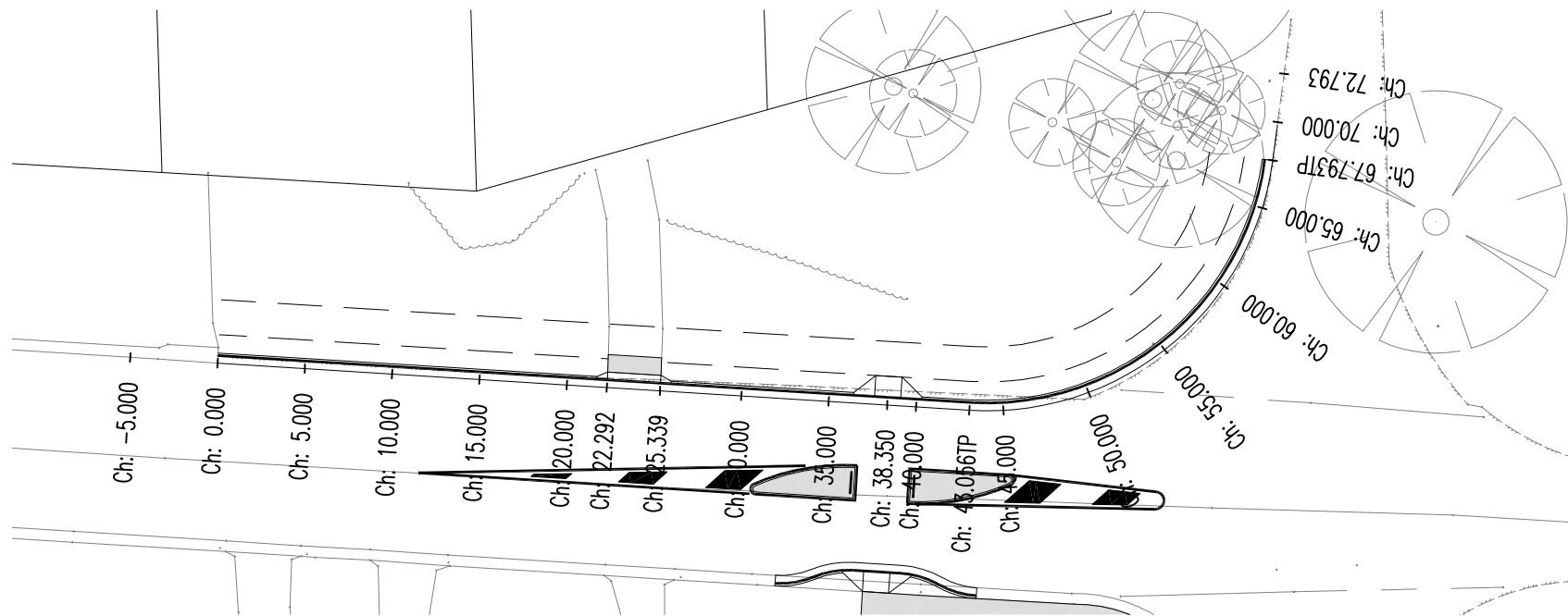

**MK01 PLAN**

SCALE 1:200 @ A1, 1:400 @ A3

4 2 0 4 8 1:200

Original sheet size A1

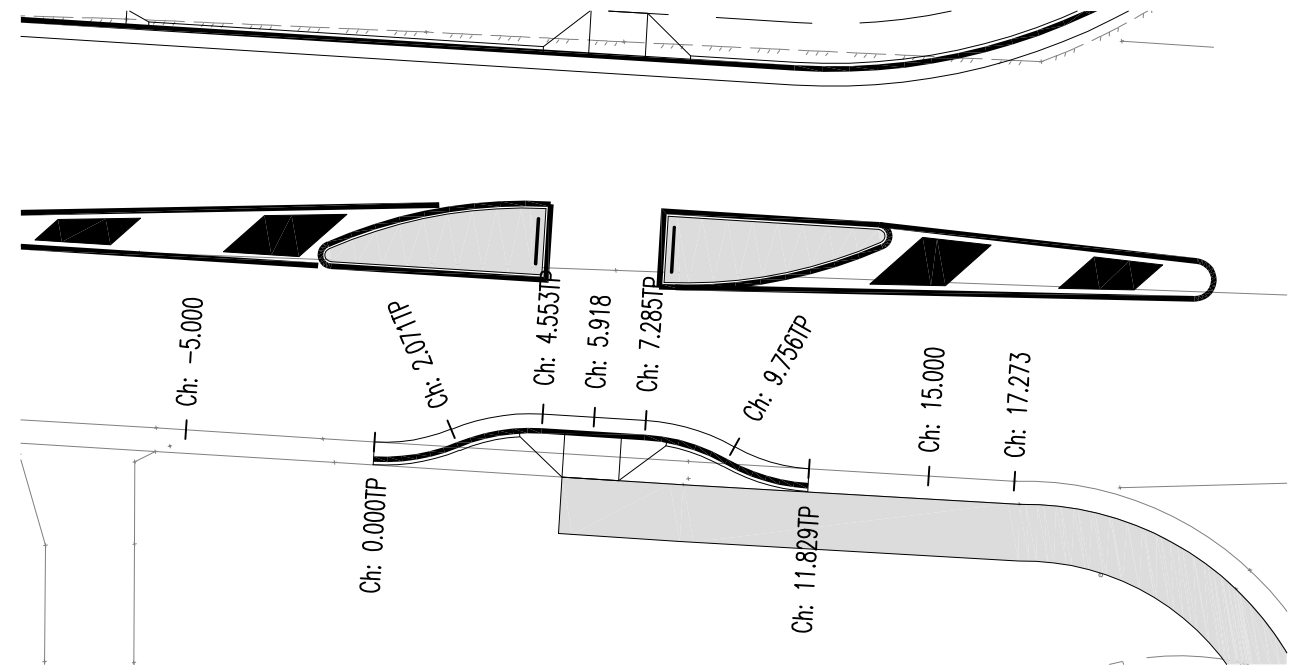

**MK02 PLAN**

SCALE 1:100 @ A1, 1:200 @ A3

4 2 0 4 8 1:200

Original sheet size A1

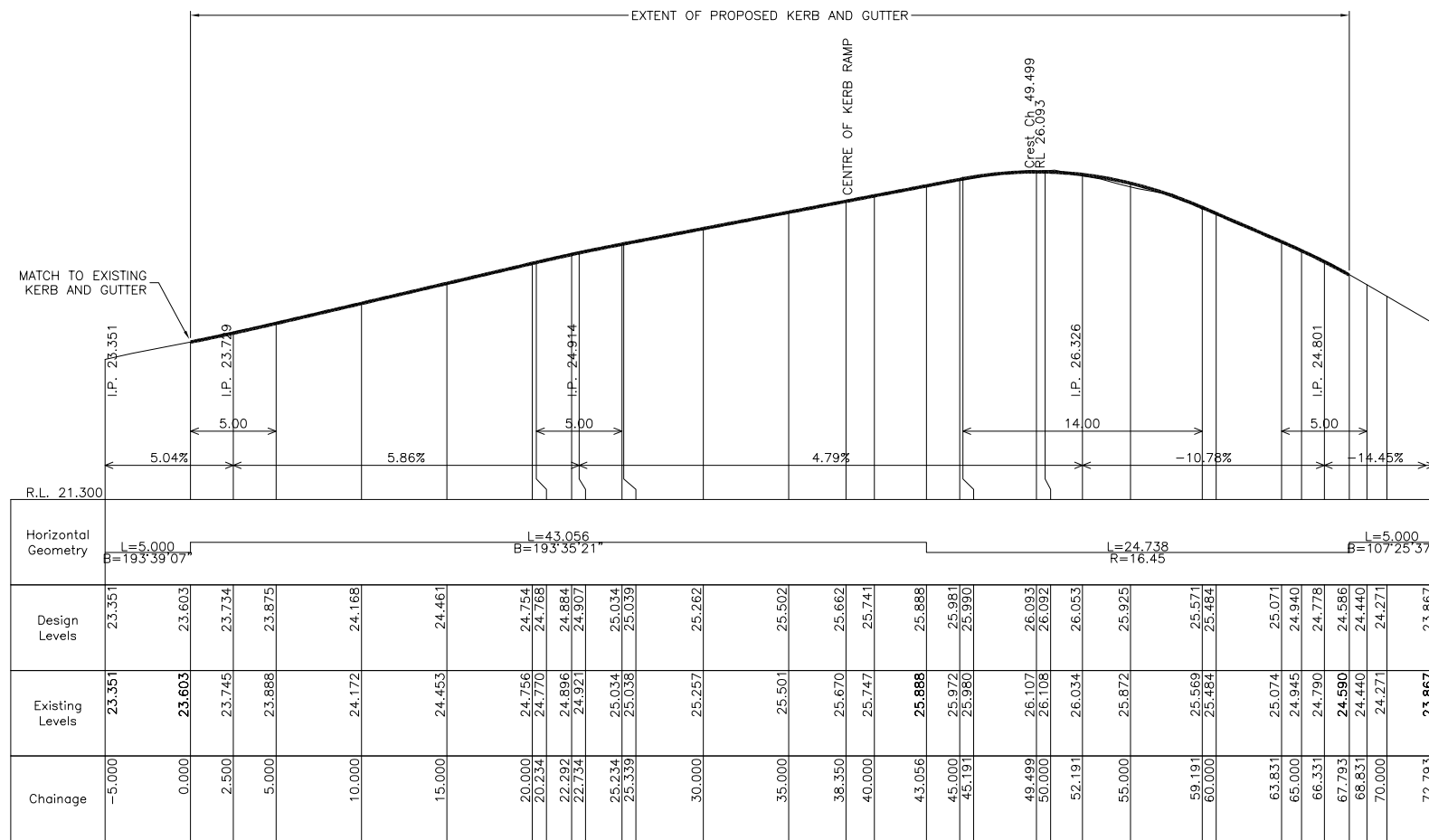

**MK01 LIP OF KERB LONGITUDINAL SECTION**

SCALES H 1:200 @ A1, 1:400 @ A3  
V 1:50 @ A1, 1:100 @ A3

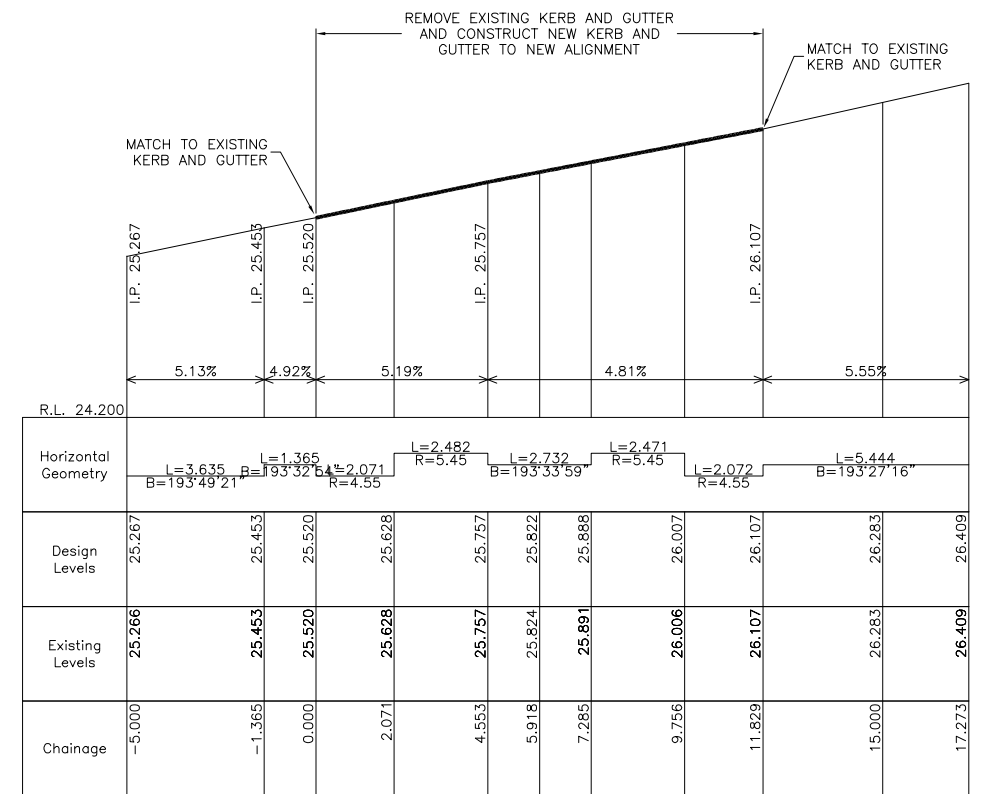

**MK02 LIP OF KERB LONGITUDINAL SECTION**

SCALES H 1:100 @ A1, 1:200 @ A3  
V 1:25 @ A1, 1:50 @ A3

ISSUE	DESCRIPTION	DATE
1	FOR 80% DESIGN APPROVAL	29/06/22

FOR DESIGN APPROVAL  
NOT FOR CONSTRUCTION

FOOTPRINT (NSW) PTY. LTD. AUTHORISE THE USE OF THIS DRAWING ONLY FOR THE PURPOSE DEMONSTRATED BY THE STATUS STAMP SHOWN ABOVE.

SCALES	SURVEYOR: KEATLEY
AS NOTED	DATUM: AHD
ORIGINAL	AZIMUTH: MGA2020
A1	DRAWN: AB
	DESIGNED: AB
	DESIGNED DATE: JUN 2022
	CHECKED: AB

**footprint**  
sustainable engineering  
a. 15 meehan drive  
kiama downs nsw 2533  
p. 02 4237 6770  
m. 0430 421 661

**PROPOSED PEDESTRIAN REFUGE**  
ELIZABETH DRIVE/FREDERICK STREET, VINCENTIA

KERB PLANS AND LONGITUDINAL SECTIONS

DRAWING NO.	ISSUE	SHEET
2151-C205	1	6 OF 8

City Council  
SCC PLAN REFERENCE  
1529.XX

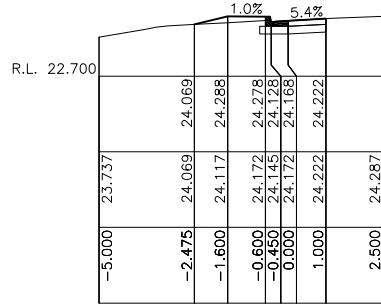

Ch 10.000

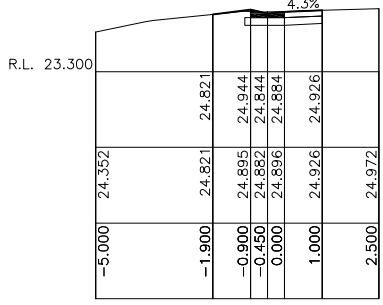

Ch 22.292

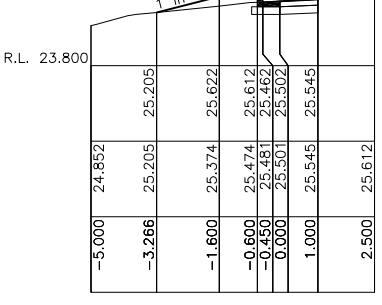

Ch 35.000

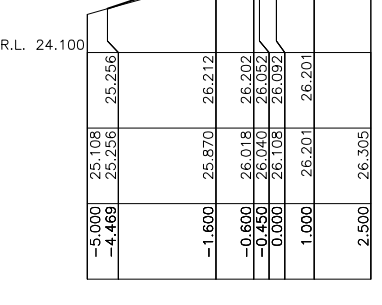

Ch 50.000

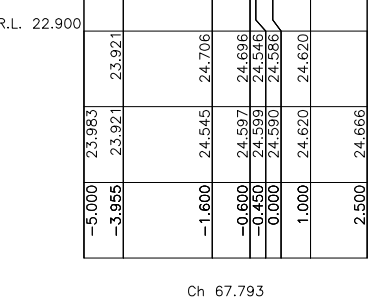

Ch 67.793

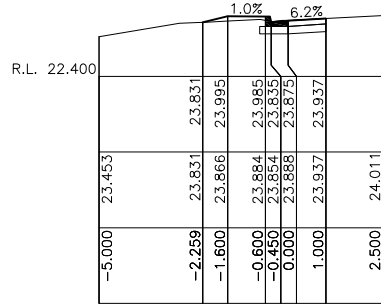

Ch 5.000

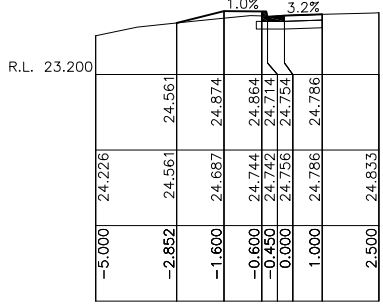

Ch 20.000

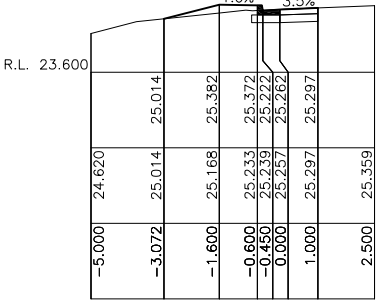

Ch 30.000

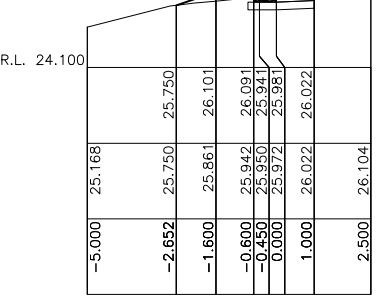

Ch 45.000

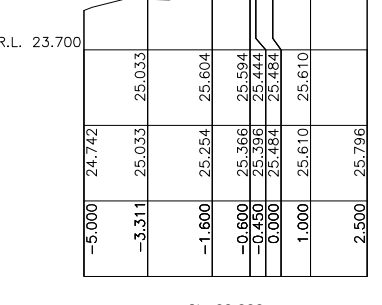

Ch 60.000

	R.L. 22.100				
Design Surface					
Existing Surface	23.170	23.605	23.723	23.713	23.726
Offset	-5.000	-2.074	-1.600	-0.600	1.000

Ch 0.000

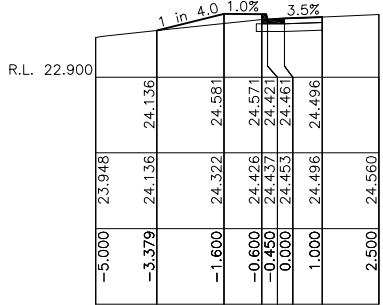

Ch 15.000

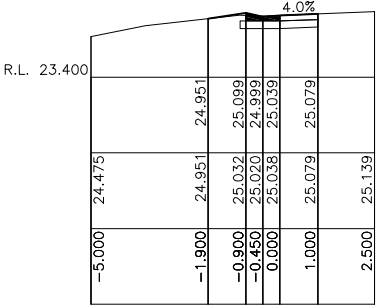

Ch 25.339

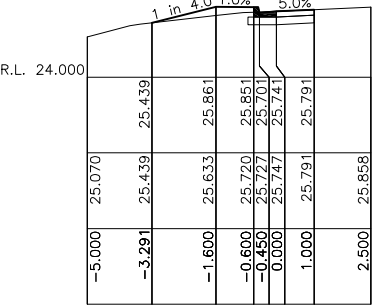

Ch 40.000

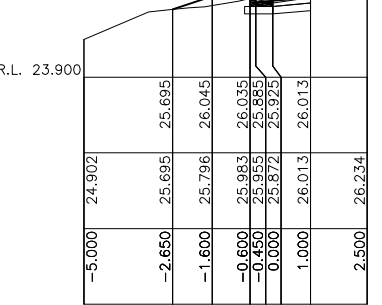

Ch 55.000

ISSUE	DESCRIPTION	DATE
1	FOR 80% DESIGN APPROVAL	29/06/22

FOR DESIGN APPROVAL  
NOT FOR CONSTRUCTION

FOOTPRINT (NSW) PTY. LTD. AUTHORISE THE USE OF THIS DRAWING ONLY FOR THE PURPOSE DEMONSTRATED BY THE STATUS STAMP SHOWN ABOVE.

SCALES	SURVEYOR: KEATLEY
AS NOTED	DATUM: AHD
ORIGINAL	AZIMUTH: MGA2020
A1	DRAWN: AB
	DESIGNED: AB
	DESIGNED DATE: JUN 2022
	CHECKED: AB

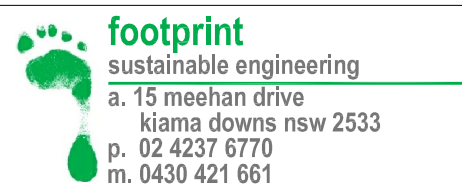

**PROPOSED PEDESTRIAN REFUGE**  
ELIZABETH DRIVE/FREDERICK STREET, VINCENTIA

MK01 CROSS SECTIONS

DRAWING NO. 2151-C206	
ISSUE 1	
SHEET 7 OF 8	

1529.XX

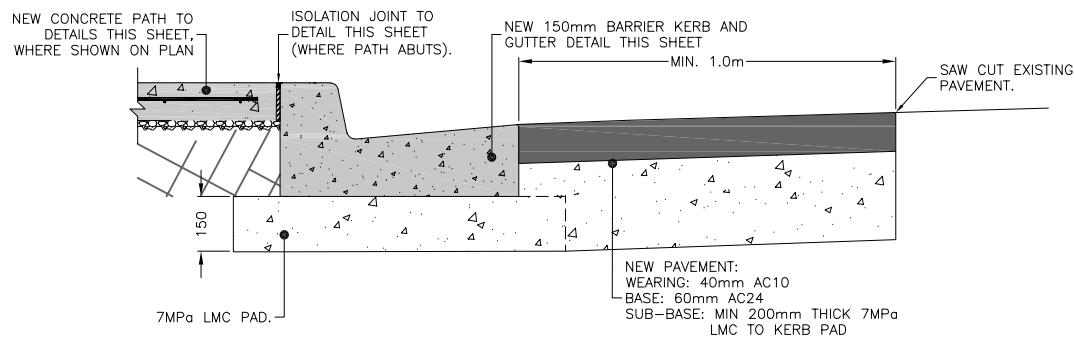

**TYPICAL KERB AND GUTTER CONSTRUCTION DETAIL**  
SCALE 1:10

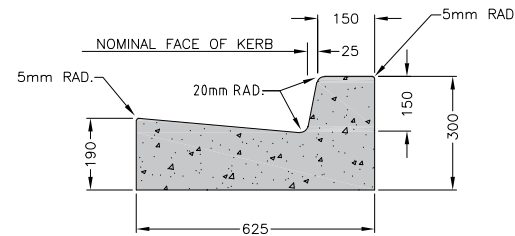

**150mm BARRIER KERB AND GUTTER DETAIL**  
SCALE 1:10

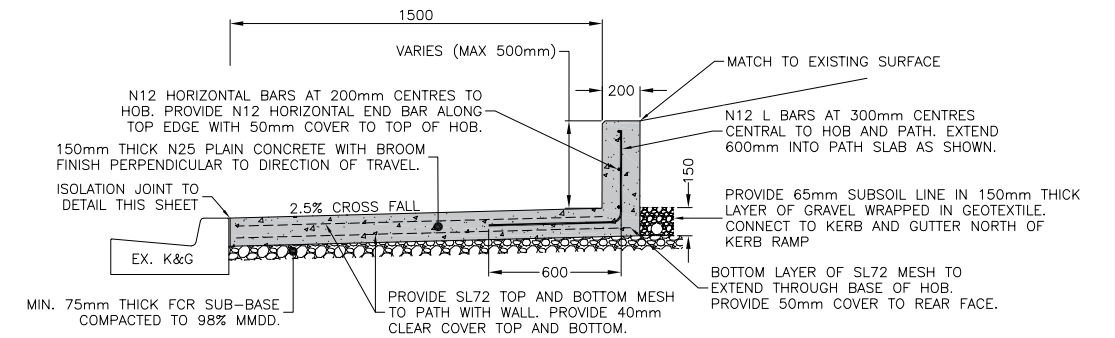

**TYPICAL FOOTPATH WITH INTEGRAL HOB DETAIL**  
SCALE 1:10

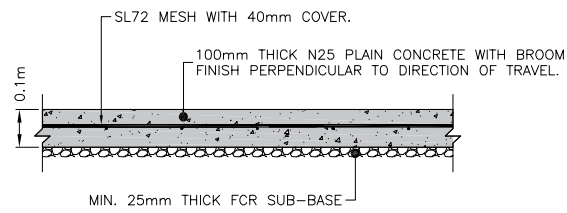

**CONCRETE PATH DETAIL**  
SCALE 1:10

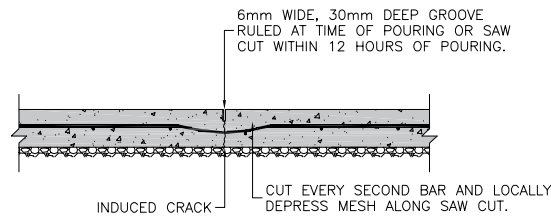

**SAW CUT CONTRACTION JOINT DETAIL**  
SCALE 1:10

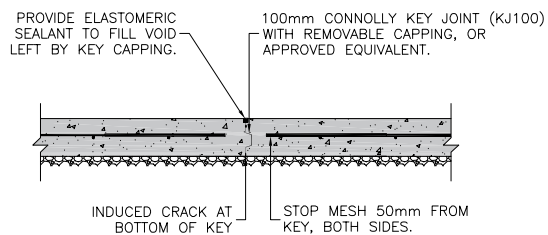

**KEY CONTRACTION JOINT DETAIL**  
SCALE 1:10

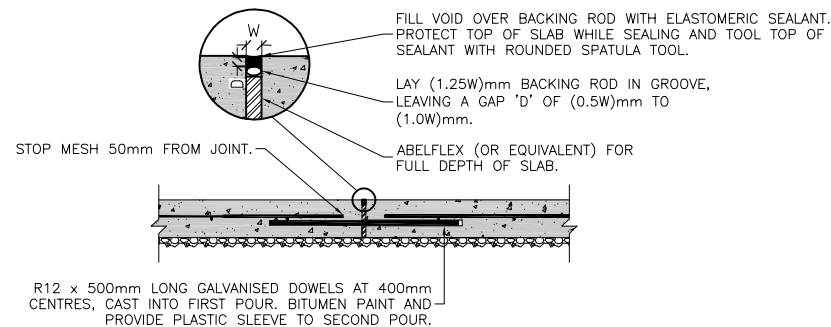

**DOWELLED EXPANSION JOINT DETAIL**  
SCALE 1:10

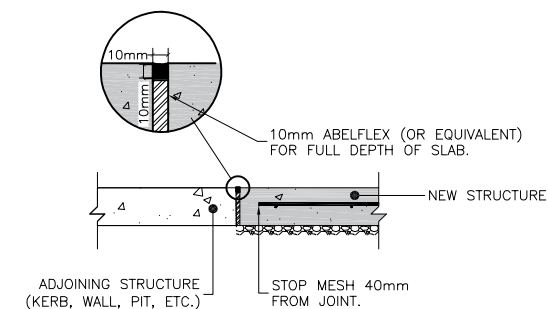

**ISOLATION JOINT DETAIL**  
SCALE 1:10

**JOINTING NOTES**

1. SAW CUT JOINTS (I.E. CONTRACTION JOINT) TO BE PLACED LATERALLY AT INTERVALS NOT EXCEEDING 1 X PATH WIDTH (MAX 4m, 1.5m TYPICAL). SAW CUTS CAN BE SUBSTITUTED WITH KEY JOINTS.
2. DOWELLED EXPANSION JOINTS OR KEY JOINTS TO BE PLACED LATERALLY AT INTERVALS NOT EXCEEDING 3 X PATH WIDTH (MAX 12m, 4.5m TYPICAL), REPLACING THE SAW CUT JOINT AT THAT INTERVAL.
3. ISOLATION JOINTS TO BE USED BETWEEN NEW STRUCTURES AND ADJOINING STRUCTURES (E.G. BETWEEN NEW SLABS AND EXISTING KERBS, PITS OR DRIVEWAYS).

ISSUE	DESCRIPTION	DATE
1	FOR 80% DESIGN APPROVAL	29/06/22

FOR DESIGN APPROVAL  
NOT FOR CONSTRUCTION

FOOTPRINT (NSW) PTY. LTD. AUTHORISE THE USE OF THIS DRAWING ONLY FOR THE PURPOSE DEMONSTRATED BY THE STATUS STAMP SHOWN ABOVE.

SCALES	SURVEYOR: KEATLEY
AS NOTED	DATUM: AHD
ORIGINAL	AZIMUTH: MGA2020
A1	DRAWN: AB
	DESIGNED: AB
	DESIGNED DATE: JUN 2022
	CHECKED: AB



**PROPOSED PEDESTRIAN REFUGE**  
ELIZABETH DRIVE/FREDERICK STREET, VINCENTIA  
CONSTRUCTION DETAILS

DRAWING NO. 2151-C207
ISSUE. 1
SHEET 8 OF 8

