A light blue stylized triangle logo, composed of a large outer triangle and a smaller inner triangle, positioned on the left side of the page, spanning across the middle and bottom horizontal sections.

SANCTUARY POINT LIBRARY

SCOPING SUMMARY REPORT

**MAY
2022**

**CLIENT
SHOALHAVEN
CITY COUNCIL**

S

Acknowledgement of Country

We acknowledge the Aboriginal and Torres Strait Islander Peoples as the traditional custodians of the land now known as Australia, and value their long, rich, cultural and spiritual connection to this land.

This is evident in the stories and ceremonies, the natural landmarks and the sacred objects embedded in the landscapes and waterways of this land.

We pay our respects to Elders past, present and emerging.

We thank in particular the traditional knowledge holders who have shared cultural knowledge and guided the development of this project: Aunty Margaret Simoes, Aunty Julie Freeman, Clive Freeman, Matt Simms, Marilyn Smart.

The Indigenous Cultural Intellectual Property shared for the purpose of this project remains the intellectual property of these knowledge holders.

Document ID

Version	Date	Prepared by
Draft	18/5/22	Soda Arts & Kianarra Coastal Connections
Final		Soda Arts & Kianarra Coastal Connections





The Project

This Scoping Summary Report has been prepared by Soda Arts Pty Ltd and Kianarra Coastal Connections as part of the Sanctuary Point Library Public Art Commissions.



The purpose of this Scoping Summary Report is to:

- Provide a high-level site and strategic context
- Summarise the insights gained during community consultation
- Outline the overarching cultural narrative proposed by the Community Key Working Group
- Identify Artistic Opportunities with the site and suggest artwork typologies, location, function and benchmark images
- Outline project Implementation, including recommended procurement models and project methodology.

The items presented in this summary must align with the Sanctuary Point Library Public Art Project Brief:

- Reflect and celebrate local First Nations art and culture
- Bring together a range of artists and artwork to form a cohesive story celebrating individual artists but ensuring it reads as an interconnected story.
- WOW moment! Follow best practice to show what is possible.
- Current Mayor wants this project to work towards a form of healing across the community and bringing out stories of Country.

Community Consultation



Community Consultation

The first stage of this project involved extensive community consultation with local First Nations community members.

A Community Key Working Group was assembled to define the cultural narrative and oversee the cultural significance of the project.

This group was lead by Aunty Margaret Simoes of Kianarra Coastal Connections.

Meetings

17 January 2022 | video conference

31 January 2022 | in person

25 February 2022 | in person

15 March 2022 | Walking on Country experience

31 March 2022 | video conference

8 April 2022 | in person

9 May 2022 | video conference

17 May 2022 | in person

Ongoing consultation with the architect and landscape architect project team.



Community Key Working Group



Aunty Julie Freeman
Wandi Wandian /
Bherwerri woman of the
Wreck Bay Aboriginal
Community with Awabakal
ancestors extending along
the Yuin nation of the
South Coast of NSW.



Clive Freeman
Traditional Owner of Wreck
Bay in the Booderee
National Park on the NSW
South Coast.



Matt Simms
Wandi Wandian man from
the Shoalhaven who
belongs to the Dharawal
and Dhurga Language
groups of the South Coast
of NSW



Marilyn Smart
Wandi Wandian woman
from the South Coast of
NSW and the Yuin Nation





Matt Simms, Djiriba Waagura
Pty Ltd, Walking on Country
experience, 15 March 2022.
Photo courtesy Ian Brewster

Walking on Country

A key recommendation from the Community Key Working Group was to take the entire project team out on Country; to see, hear and feel the cultural significance of the land on which the Sanctuary Point Library will sit.

The purpose of this day was to immerse the team - Council, the architect, the landscape architect and public art team - in a cultural experience of the Bay and Basin area. This experience became the crucial step to inform the cultural narrative of the library.

The program for the day was created by Matt Simms of Djiriba Waagura Pty Ltd. It included visiting sites of significance, a smoking ceremony, walking and sharing cultural stories.

Aunty Julie Freeman performed the Welcome to Country and shared her extensive cultural connections to Country. Clive Freeman shared his geological expertise, providing a scientific and cultural context.

Unfortunately due to the recent inclement weather, the visit to Christian's Minde was postponed. Iain Brammer of Taylor Brammer Landscape Architects was able to visit at a later date with Matt Simms.

The outcome of this experience shifted the focus of the project away from a cultural narrative expressed only through public art, to a site-wide cultural narrative expressed across the built, landscape and public art elements.





Matt Simms, Djiriba Waagura,
Walking on Country
experience, 15 March 2022.

Cultural Narrative





CULTURAL NARRATIVE

THE SALTWATER PEOPLE OF THE BAY AND BASIN AREA, & THEIR KNOWLEDGE SYSTEMS ACROSS SEA, LAND AND SKY.

SUB-THEMES

- A journey through time, sharing who 'we are and how we fit'
- This area is an important meeting point: of Dharawal and Dhurga language groups; of North and South weather systems.
- All living things are of equal value and contain knowledge - plants, animals and people
- Relevance of ancestral knowledge to our contemporary moment
- The stories and knowledge of First Nations people as part of a shared history and knowledge of humankind.

KEY WORDS

- 'True Country' - celebrate what was here, and what has been lost
- Saltwater / Water
- Knowledge, Sharing and Community

Thematic Journey

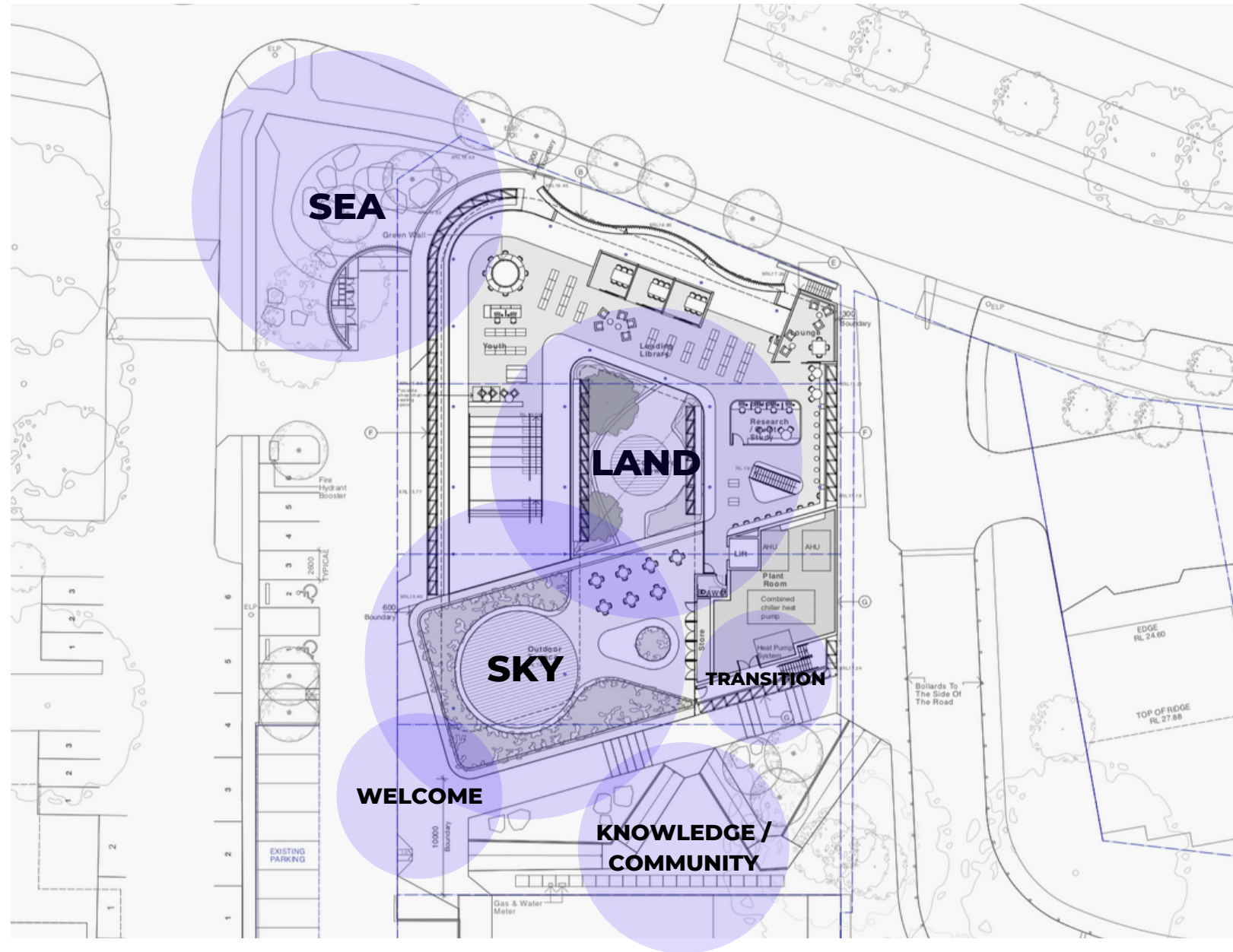



SODA ARTS

Danielle Robson
Director

Soda Arts Pty Ltd

T 0433 153 449

E danielle@sodaarts.com.au

SodaArts.com.au

connecting
artists
audiences
and ideas.



Margaret Simoes
Director

Kianarra Coastal Connections

T 0432 432 205

E kianarracc@gmail.com

DISCLAIMER: Copyright Soda Arts Pty Ltd.
This proposal is for internal use only and
is not for general or public release. No part
of this document can be reproduced or utilised
in any form without written permission from
Soda Arts Pty Ltd.

All Indigenous Cultural Intellectual Property
included in this report remains the property of
the Traditional Knowledge Holders and cannot
be used for any other purpose other than this
project.

*Copyright in benchmarking images belongs
to the artists.*