

# SHOALHAVEN HEADS LANDSCAPE MASTER PLAN - Version 2

## LANDSCAPE MASTER PLAN DRAWING LIST

Drawing No.	Drawing Title
01	Cover Sheet & Location Photographs
02	Introduction & Master Plan Philosophy
03	LEP Zonings & Census Statistics
04	Streetscape - Pathways
05	Streetscape - Trees
06	Vegetation Planting Scheme
07	Materials, Furniture & Colour Palette
08	Materials, Furniture & Colour Palette
09	Art, Placemaking & Playspace
10	Streetscape - Typical Plan & Section
11	Streetscape - Typical Plan & Section
12	Planting Details
13	Pathway & Paving Details
14	Concept Design - Main Entry
15	Concept Design - Pedestrian Crossing
16	Concept Design - Vic Zealand Reserve
17	Commercial & Community Precinct Plan
18	Concept Design - Community Precinct
19	Concept Design - Commercial Precinct 1
20	Concept Design - Commercial Precinct 2
21	Concept Design - Jerry Bailey Oval
22	Concept Design - CH Gumley Reserve
23	Concept Design - Curtis Park Reserve
24	Concept Design - River Road Reserve
25	Concept Design - River Boat Ramps & Reserves
26	Concept Design - Pepper Reserve

**LEGEND**  
Extent of Master Plan



LOCALITY PLAN



PREPARED BY: SHOALHAVEN CITY COUNCIL  
A joint project of City Futures Directorate & City Lifestyles Directorate.

**Shoalhaven**  
City Council  
Trim File No.: 46953E  
Drawing No.: 5267\_01A  
Approval Date 30/03/2022  
Version Number: 02



## LOCATION PHOTOGRAPHS

## EXISTING FEATURES OF SHOALHAVEN HEADS



Beach Activities



Pump Track



Vineyards & Wineries



Wild Life



Seafood



Sunset over the oyster beds by Andy Hutchinson



Sunset over Shoalhaven River

## INTRODUCTION

Purpose of this Landscape Master Plan is to review and revise the previous Shoalhaven Heads Landscape Master Plan completed in 2014 and endorsed by Council. This revised documentation includes projects completed since that time and new proposed projects which have emerged through community consultation and collaboration with Council.

The Landscape Master Plan will continue to provide an overarching approach to the development of the built environment and soft landscape of the village of Shoalhaven Heads. It is intended to be used as a guide to assist in more detailed design work which may arise in the future.

The 2021 Landscape Master Plan includes;

- Local Government Environmental Zoning (refer to LEP2014) & census statistics (refer to Shoalhaven 2020 data).
- Pedestrian Access & Mobility Plan (updated date March 2021) sheet 04.
- Streetscape Tree Planting Plan dated June 2021 sheet 05.
- Vegetation Planting Scheme dated June 2021 sheet 06.
- Materials, Furniture and Colour Palette dated June 2021 sheets 07 & 08.
- Art, Placemaking & Playspace dated June 2021 page 09.

## MASTER PLAN PHILOSOPHY

The Shoalhaven Heads village can be found on the northern fringe of the Shoalhaven region. It is approximately 406ha in size and as at 30th June 2020 the population is around 3247.

The vehicular entrance to the town can be either off Gerroa Road (aka the *Sand Track*) or Shoalhaven Heads Road. However, for walkers and cyclists there are many sandy walking tracks through National Parks to the Shoalhaven Beach foreshore or the Shoalhaven River. Whichever entry route you choose the 'Heads topography is typically flat with a comfortable easy grade for cyclists and walkers to explore the town centre and surrounds.

The local population is comprised of young families, retirees, professionals, tradesfolk, artists, musicians, gardeners, sporting fans and community minded people who come together in a vibrant celebration of what makes a town great.

This document helps to frame future open space and streetscape development whilst ensuring the spirit of Shoalhaven Heads and the community are fully included.



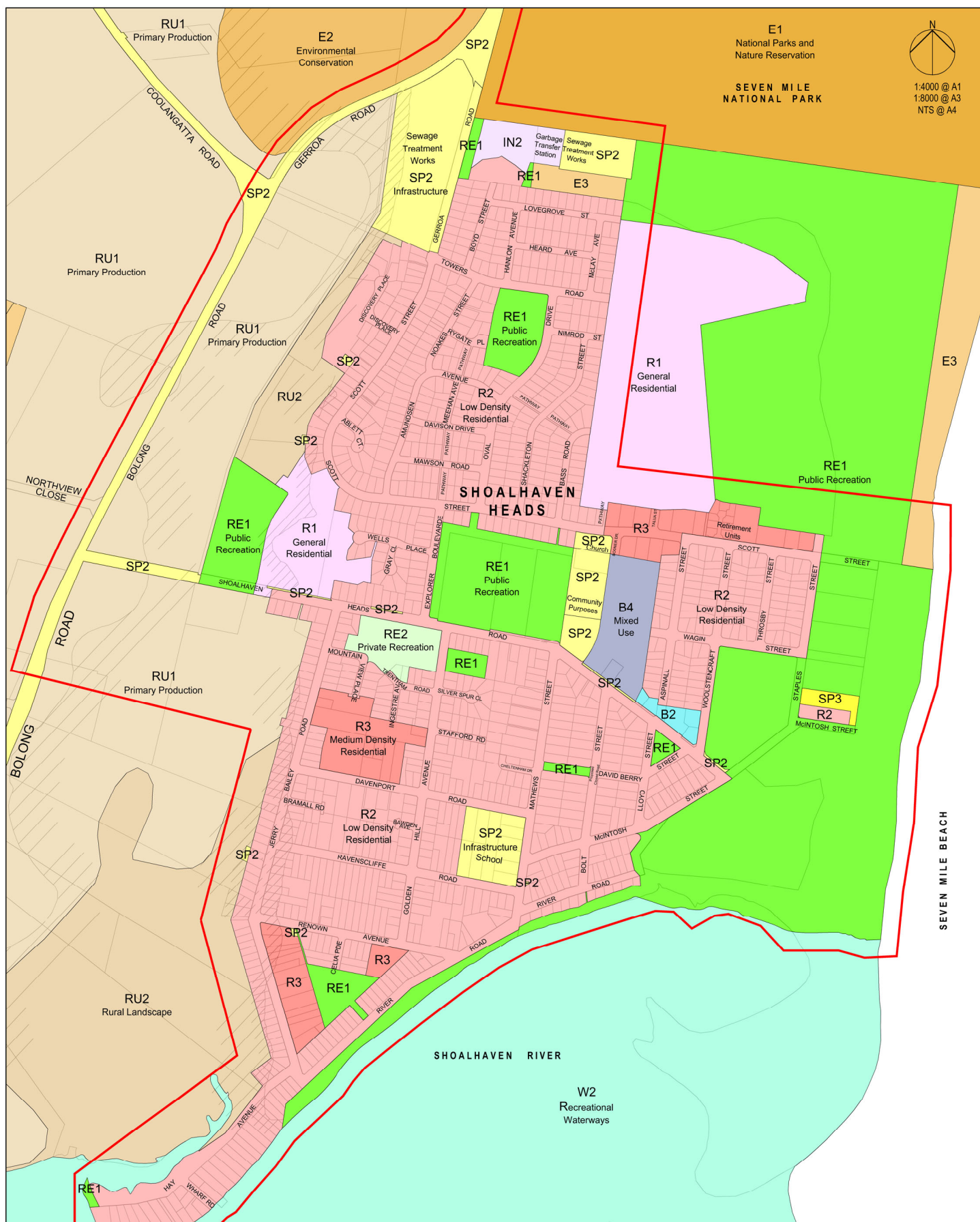

#### LEP 2014 LAND ZONING - LEGEND

B2 Local Centre	R3 Medium Density Residential
B4 Mixed Use	RE1 Public Recreation
E1 National Parks and Nature Reserves	RE2 Private Recreation
E2 Environmental Conservation	RU1 Primary Production
E3 Environmental Management	RU2 Rural Landscape
IN2 Light Industrial	SP2 Infrastructure
R1 General Residential	SP3 Tourist
R2 Low Density Residential	W2 Recreational Waterways

#### LEGEND

Extent of Master Plan

Total Area of Shoalhaven Heads is 406 ha

#### CENSUS 2016 SHOALHAVEN HEADS STATISTICS

People 3,059 (2020 ABS - 3,247)

Male 49.4%

Female 50.6%

Median age 56

Families 834

Average children per family 1.7

All private dwellings 1,703

Average people per household 2.1

Average motor vehicles per dwelling 1.5

**Shoalhaven**  
City Council

Trim File No.: 46953E

Drawing No.: 5267\_03A

Approval Date 30/03/2022

Version Number: 02

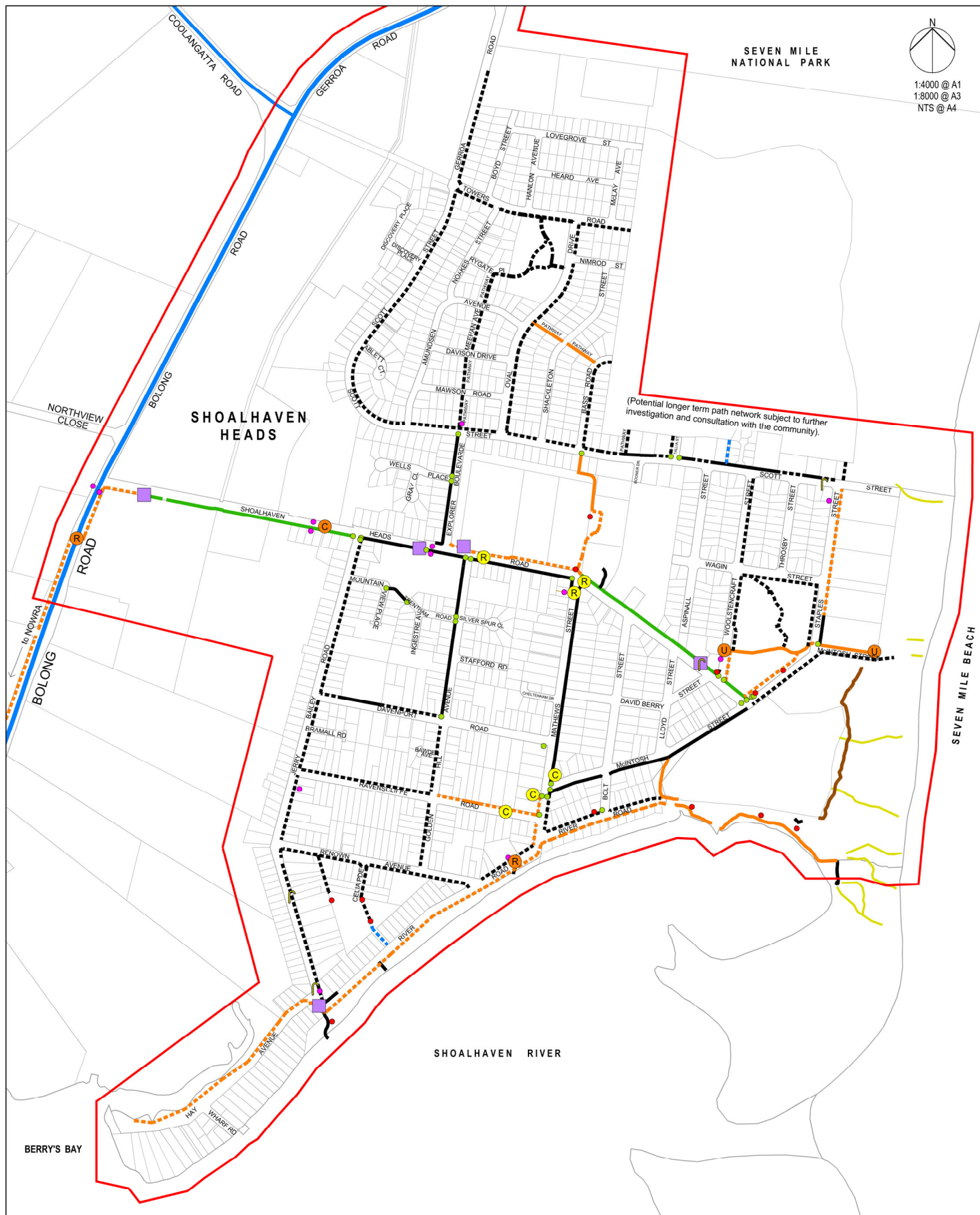

1:4000 @ A1  
1:8000 @ A3  
NTS @ A4

#### PEDESTRIAN ACCESS MOBILITY PLAN (August 2021) - LEGEND

<b>Features</b>				
Existing Bus Shelter	Existing J-Pole	Existing TSN	Existing Bike Rack	Existing Kerb Ramp
<b>Proposed Crossings</b>				
Pedestrian Refuge	Raised Crossing	Unmarked Crossing		
<b>Existing Crossings</b>				
Children Crossing	Blister	Pedestrian Refuge		
<b>Paths, Tracks and Cycleways</b>				
Existing Footpath	Existing Footpath to be Upgraded	Existing Shared Path	Existing on Road Cycling	Existing Bushwalk
Existing Beach Track	Proposed Footpath	Proposed Shared Path	Proposed on Road Cycling	

Note: All footpath widths to be determined following further investigation and approvals.

#### LEGEND

Extent of Master Plan

**Shoalhaven**  
City Council

Trim File No.: 46953E  
Drawing No.: 5267\_03A  
Approval Date 30/03/2022  
Version Number: 02



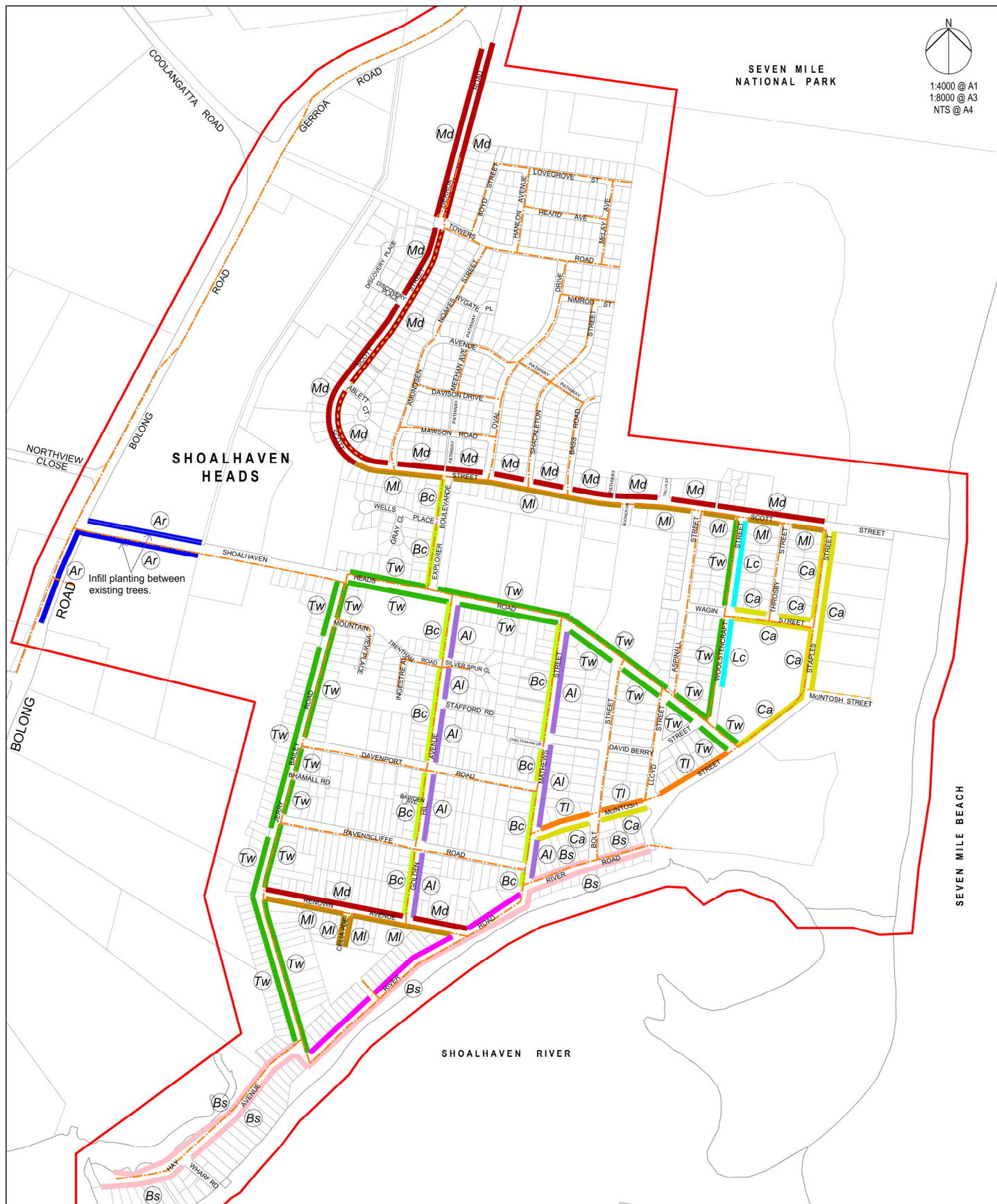

#### LEGEND - STREETScape - TREE SPECIES

<span style="color: blue;">—</span> (Ar) <i>Aurantiarca rhombifolia</i> (syn <i>Pittosporum rhombifolia</i> )	<span style="color: orange;">—</span> (TI) <i>Tristanopsis laurina</i>
<span style="color: green;">—</span> (Tw) <i>Tristanopsis 'Luscious' - Watergum</i>	<span style="color: magenta;">—</span> (Bi) <i>Banksia integrifolia</i>
<span style="color: yellow;">—</span> (Bc) <i>Backhousia citriodora</i>	<span style="color: pink;">—</span> (Bs) <i>Banksia serrata</i>
<span style="color: purple;">—</span> (Al) <i>Acmena luehmannii</i>	<span style="color: brown;">—</span> (Mi) <i>Melaleuca linifolia</i>
<span style="color: cyan;">—</span> (Lc) <i>Lophostemon confertus - Brushbox</i>	<span style="color: red;">—</span> (Md) <i>Melaleuca decora</i>
<span style="color: yellow;">—</span> (Ca) <i>Cupaniopsis anarcardiodes - 'Tuckeroo'</i>	

#### LEGEND

- Extent of Master Plan
- - - Existing Street Lights & Overhead Power Lines
- - - Existing Street Lights & Underground Services

NOTE: Tree location in accordance with Austroads 'Safe Road Design Principles'. Refer to Vegetation - Trees (sheet 06), Streetscape - Typical Plans & Sections (sheets 12 & 13) and Planting Details (sheet 14).





*Auranthocarpus rhombifolia*



*Tristania 'Luscious' Water Gum*



*Backhousia citriodora*



*Acmena luehmannii*



*Melaleuca decora*



*Banksia integrifolia*



*Cupaniopsis anardiodora 'Tuckeroo'*



*Tristania laurina*

## VEGETATION PLANTING SCHEME

### Street Trees - Selection Principles

- Street trees to be Australian native species &/or cultivar.
- Select trees for appropriate height under powerlines in accordance with 'Essential Energy' - "Plan Before You Plant" - guide to planting and managing trees near powerlines.
- Contribute to the unity of the Shoalhaven Heads streetscape in terms of scale, correct choice for growing conditions, be hardy and resistant to dry seasons.
- Be an appropriate selection for the location by considering existing infrastructure & services, driveways, footpaths, bus stops, shop awnings and drainage lines.
- Consider the lifespan of the tree, the mature height and width of the canopy, the maintenance and establishment requirements.

### Tree Spacing Guide

- Small trees - up to 4m at maturity, plant @ minimum 7m centres.
- Medium trees - up to 7m at maturity, plant @ minimum 10m centres.
- Large trees - up to 15 - 20m high at maturity, plant @ 20m centres or as specimen trees.

SMALL TREES	MEDIUM TREES	LARGE TREES
Suitable for street trees where overhead wires occur.	Suitable for street trees where no overhead wires are present. Suitable for parks and carparks.	Suitable for large parks and edge of existing vegetation.
<i>Tristania 'Luscious'</i>	<i>Cupaniopsis anardiodora</i>	<i>Lophostemon confertus</i>
<i>Tristania laurina</i>	<i>Acmena luehmannii</i>	<i>Banksia integrifolia</i>
<i>Backhousia citriodora</i>	<i>Melaleuca decora</i>	<i>Acacia binervata</i>
<i>Melaleuca linariifolia</i>	<i>Auranthocarpus rhombifolia</i>	<i>Angophora floribunda</i>
	<i>Allocasuarina littoralis</i>	<i>Aracaria heterophylla</i>
	<i>Banksia serrata</i>	<i>Melaleuca quinquenervia</i>
	<i>Hymenosporum flavum</i>	<i>Toona australis</i>
	<i>Hibiscus tiliaceus</i>	<i>Corymbia maculata</i>
	<i>Eleocarpus reticulatus</i>	
refer to Shoalhaven Species List for Shoalhaven Heads <a href="http://sccintranet/portals/0/documents/cso/treespecies/ShoalhavenHeads.pdf">http://sccintranet/portals/0/documents/cso/treespecies/ShoalhavenHeads.pdf</a>		

### Shrubs and Grasses

SHRUBS	GRASSES & STRAPPY LEAFED PLANTS	CLIMBERS & SCRAMBLERS	EXOTIC ACCENT PLANTS
<i>Eremophila glabra prostrata</i>	<i>Anigozanthus hybrids &amp; cultivars</i>	<i>Hibbertia scandens</i>	<i>Aloe hybrid 'Sea Urchin'</i>
<i>Grevillea sp.</i>	<i>Liriope muscari 'Silverlawn'</i>	<i>Carpobrotus sp.</i>	<i>Aloe hybrid 'Mighty Coral'</i>
<i>Liriope sp.</i>	<i>Liriope muscari 'Amethyst'</i>	<i>Hardenbergia violacea &amp; cultivars</i>	<i>Aloe hybrid 'Mighty Gold'</i>
<i>Lomandra sp.</i>	<i>Carex appressa</i>	<i>Kennedia rubicunda</i>	<i>Nandina 'Flirt'</i>
<i>Rhagodia spinescens 'Aussie Flat Bush'</i>	<i>Crinum pedunculatum</i>	<i>Westringia 'Low Horizon'</i>	<i>Lorepetalum 'Purple Pixie'</i>
<i>Westringia sp.</i>	<i>Dianella caerulea &amp; cultivars</i>	<i>Grevillea 'Royal Rambler'</i>	<i>Rhoeo</i>
<i>Acacia longifolia subsp. longifolia</i>	<i>Dianella revoluta</i>		<i>Strelitzia reginae</i>
<i>Banksia ericifolia subsp. ericifolia</i>	<i>Doryanthes excelsa</i>		
<i>Callistemon sp.</i>	<i>Ficinia nodosa</i>		
<i>Correa alba</i>	<i>Gahnia clarkei</i>		
<i>Correa reflexa</i>	<i>Lomandra cultivars</i>		
<i>Grevillea sp.</i>	<i>Macrozamia communis</i>		
<i>Hakea dactyloides</i>	<i>Isolepis nodosa</i>		
<i>Hibbertia scandens</i>			
<i>Rhagodia spinescens 'Aussie Flat Bush'</i>			

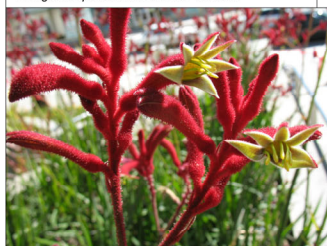

*Anigozanthus 'Big Red'*



*Westringia 'Aussie Box'*



*Carpobrotus glaucescens 'Rambler'*

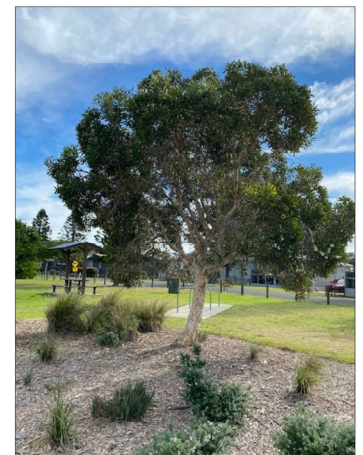

*Melaleuca linariifolia*

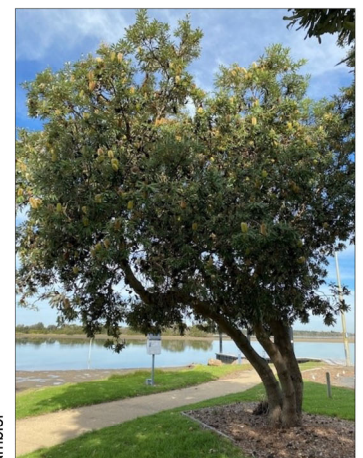

*Banksia serrata*



## MATERIALS, FURNITURE AND COLOUR PALETTE

The materials and colour palette endorsed in Shoalhaven Heads Landscape Masterplan Version 1 (D18/424672) is to be carried through in the current Landscape Masterplan Version 2 with some subtle refinement.

**Pathways:** see *Pedestrian Access Mobility Plan (March 2021) - sheet 04* for additional information.

A hierarchy of pathways extending throughout Shoalhaven Heads with various widths, oxides and treatments to signify major pathways from lesser footpaths.

- Streetscape adjacent to commercial zone
  - 3m wide - kerb to boundary, full depth oxide concrete with masonry paver decorative margins.
 Refer to *Shoalhaven Development Control Plan - Chapter G18 Streetscape Design for Town and Village Centres - Streetscape Technical Manual*.
- Major Pathways
  - 2.5m wide Shared User Path typically with addition of full depth oxide.
- Park Pathways
  - 2m to 2.5m wide for parks, beaches, riverfront, sporting fields and carparks using full depth oxide and / or plain concrete.
- Minor Pathways
  - 1.2m to 1.5m wide for residential areas typically using plain concrete.



Pathway - full depth oxide  
Colour: sandstone

### Street and Park Furniture:

Street Furniture Australia is an approved Procurement Contractor - LGP308-02

#### Colours:



Lober Red  
Satin YG154A

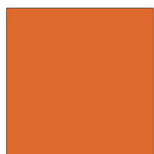

Sensation Orange  
Gloss YF049A

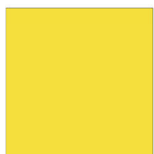

Brilliant Yellow  
Gloss YE087A



Viper Green  
Gloss YK051A



Bondi Blue  
Gloss YJ046A



Palladium Silver  
Satin GY184C



Telemagenta Pink  
Jotun Telemagenta Gloss RAL4010

#### SFA Mall Seat with armrests

- Code CMM7
- Frame - Palladium Silver, surface mounted
- Legs arch shaped
- Armrests (2 off) elliptical arm using Palladium Silver / Stainless Steel
- Batons and baton ends - aluminium powder coated in colours specified.



#### SFA Mall Bench with armrests

- Code CMM402
- Frame - Palladium Silver, surface mounted
- Legs arch shaped
- Armrests (2 off) elliptical arm using Palladium Silver / Stainless Steel
- Batons and baton ends - aluminium powder coated in colours specified.



#### Beach Furniture: SFA Mall Curved Bench (combination of Extended S-shape, C-shape, S-shape)

- Code CMM-M803
- Frame - Palladium Silver
- Legs arch shaped
- Batons and baton ends - aluminium powder coated in colours specified.

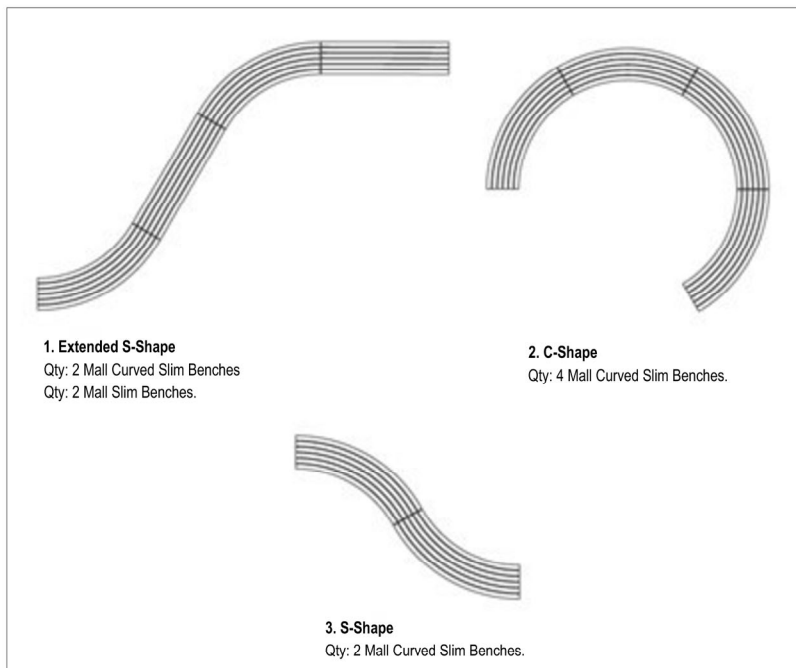



#### SFA Mall DDA Accessible Picnic Setting with Mall Slim Bench

- Table Code CMM605-DDA
- Frame - Mercury Silver
- Legs - post surface mounted
- Batons and baton ends - aluminium powder coated in colours specified.



#### Landmark Peninsula Series Picnic Shelters

- Code K302 4m x 4m up to K308 10m x 8m (K304 10m x 4m shown)
- Timber supports sub-surface mounted, fixings stainless steel
- Roof 'Colorbond' "Surfist".



#### Notice Board

- Custom designed
- Powder coated in colours specified.



#### Cora Bike Rack

- Code CBR4B
- Stainless Steel with base plate for surface mount.



#### Christie BBQ

- Double stainless steel BBQ plate
- DDA compliant cabinet.



#### SFA 240lt Bin Enclosure with curved roof

- Code WBE F240BAT + curved roof + adjustable feet
- Frame - Mercury Silver
- Aluminium powder coated in colours specified.



#### Landmark Angelsea Series Fish Cleaning Station

- Code K190
- Timber supports sub-surface mounted.
- Roof 'Colorbond' "Surfist".



#### SFA Arqua Drinking Fountain (DDA compliant)

- Code - Arqua Dog Bubbler DF4-DB
- Powder coated in colours specified.

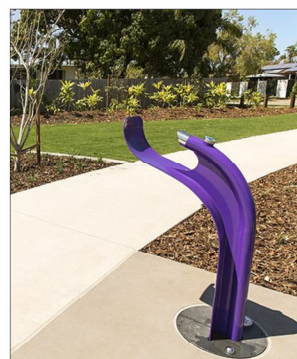

#### Encat 'Pipeline Pete' Beach Shower

- Marine grade Stainless Steel, surface mount
- Anti vandal shower rose
- Water saving timed flow button.



**Shoalhaven**  
City Council

Trim File No.: 46953E  
Drawing No.: 5267\_06A  
Approval Date 30/03/2022  
Version Number: 02



## ART, PLACEMAKING & PLAYSPACE

The opportunities for art and placemaking in Shoalhaven Heads are varied and plentiful. From blank walls on the public and privately owned buildings where consent is required before any work commences through to community members bringing life into tired street furniture and shelter sheds, the Shoalhaven Heads residents have embraced the concept of making the 'Heads' a visually exciting place to visit and live. Ideas to spark interest in developing projects have been included below.

### Surf Club House Murals:



### Sculpture for Parks, Riverfront and Beach:



### Playzones & Recreational Escape Zones:



Adventure Play Area (Jerry Bailey Reserve eastern side of Pump Track)

Sandstone Sculpture Climbing Garden (Jerry Bailey Reserve near sandstone circle meeting place)

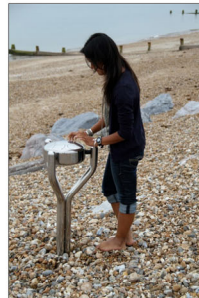

Music Play (Jerry Bailey Reserve near Learn to Ride Zone)



Multi-Sports Cage (Jerry Bailey Reserve near Skate Park)



Outdoor Fitness Equipment (Vic Zealand & Jerry Bailey Reserve)



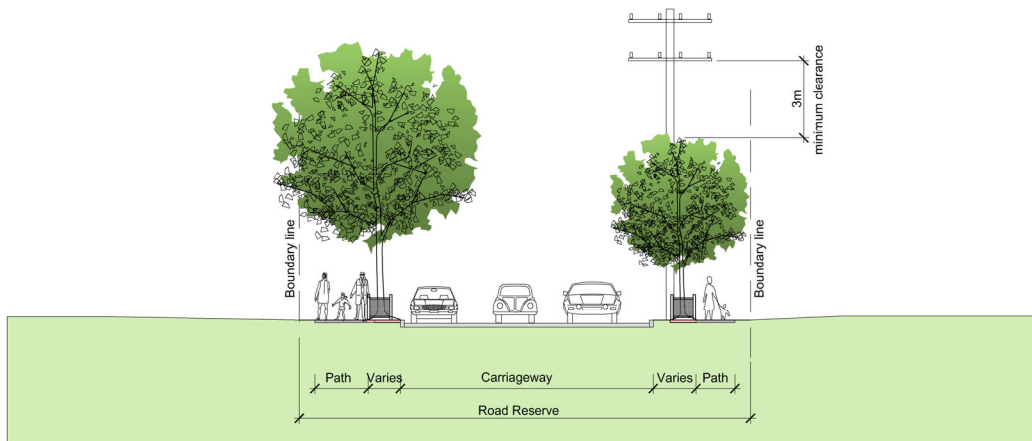

**LOCAL STREET TREE PLANTING IN VERGE - CONCEPT DETAIL SECTION**

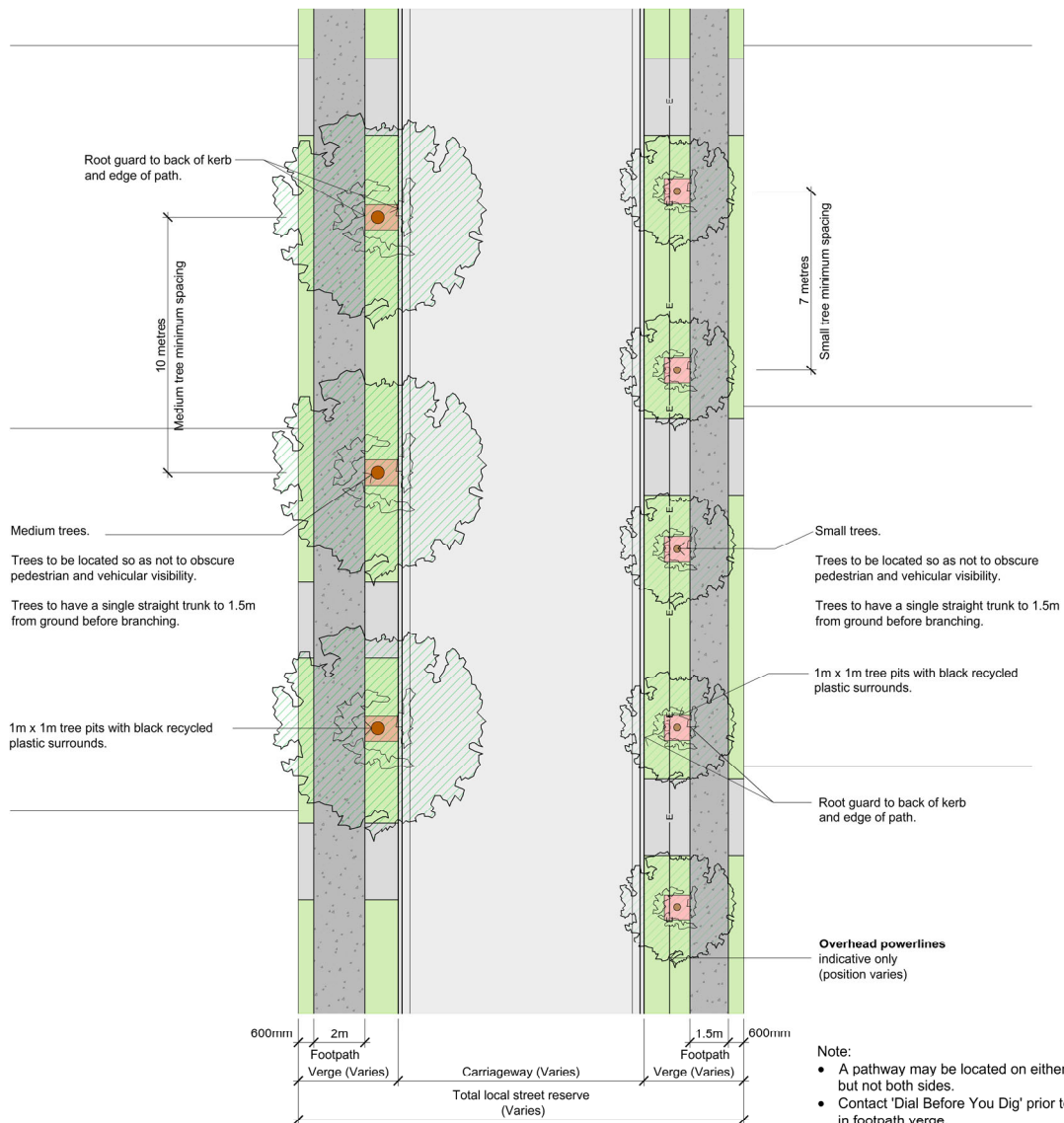

**TYPICAL LOCAL STREET TREE PLANTING IN VERGE - CONCEPT DETAIL PLAN**  
(TYPE 1, 2 & 3 TREE PLANTING)



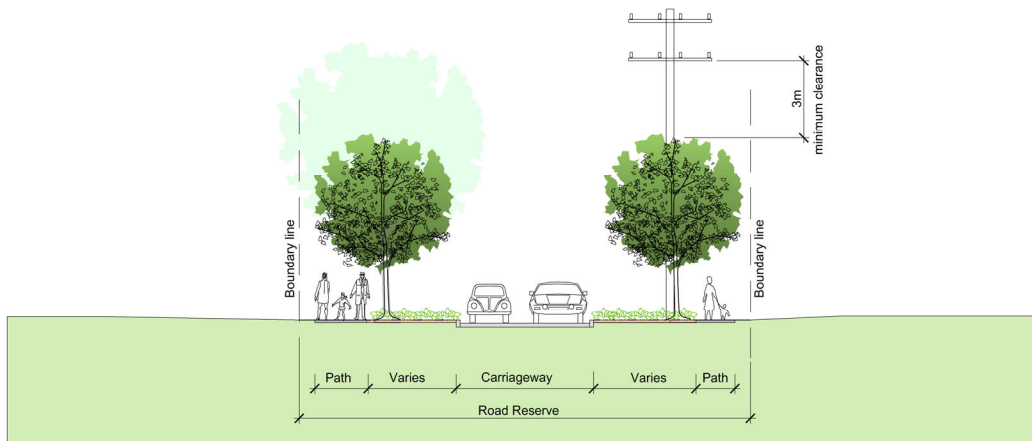

**LOCAL STREET TREE PLANTING IN ROAD BLISTER - CONCEPT DETAIL SECTION**

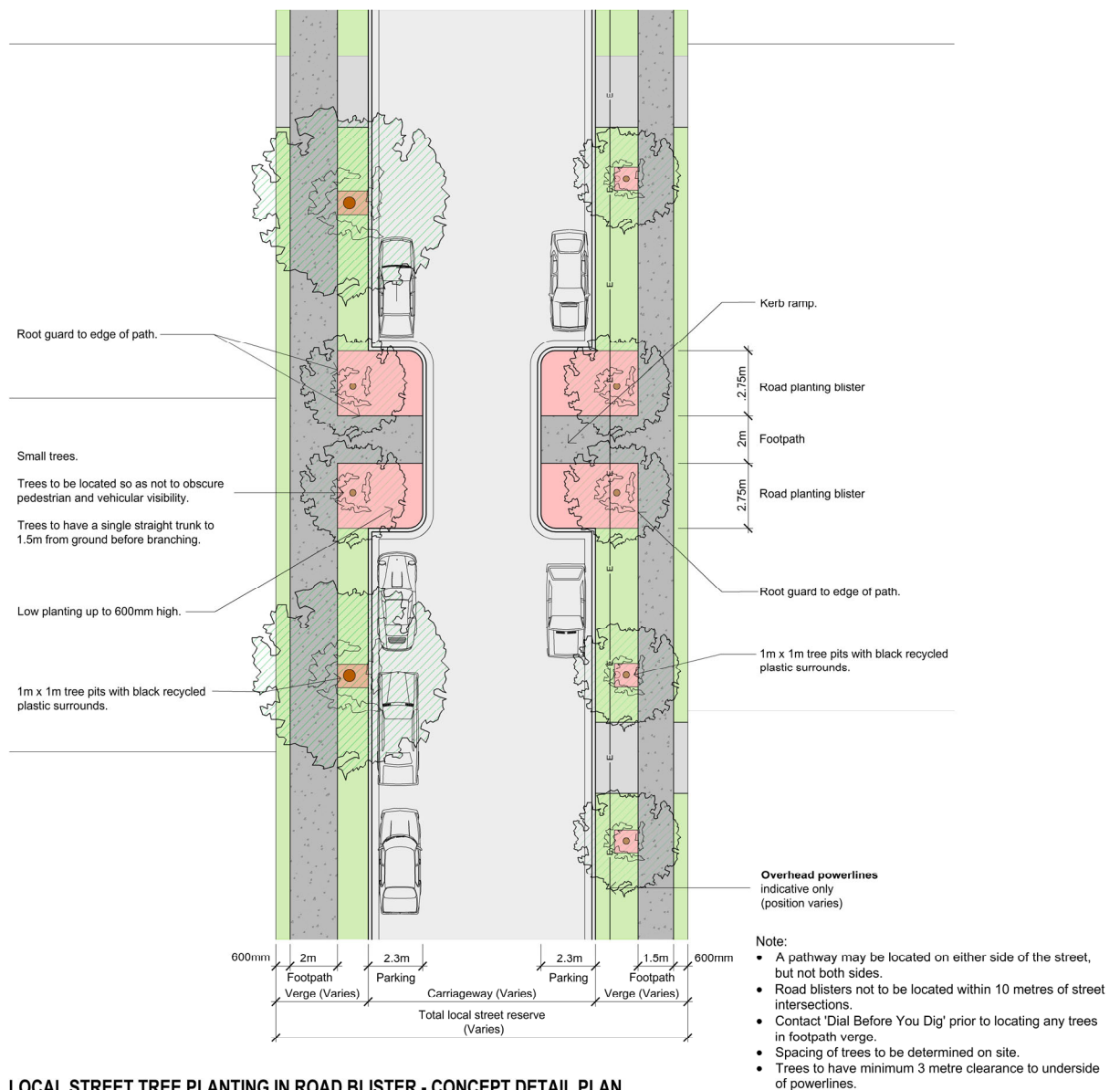

**LOCAL STREET TREE PLANTING IN ROAD BLISTER - CONCEPT DETAIL PLAN**  
(TYPE 4 TREE PLANTING)



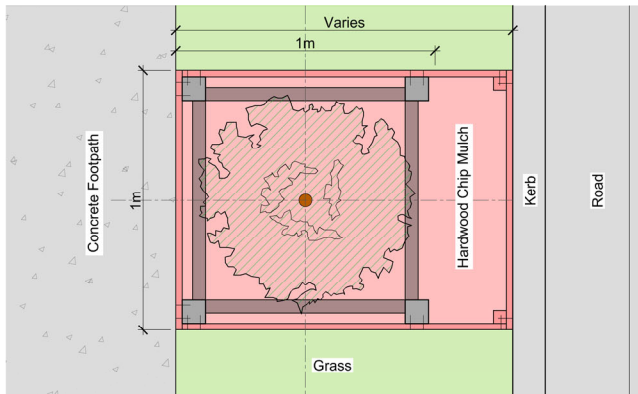

PLAN

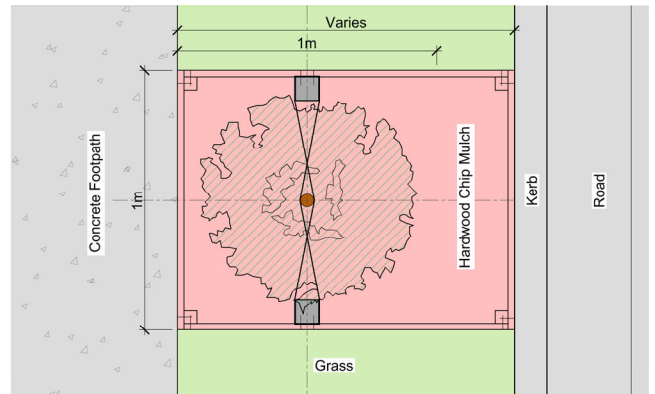

PLAN

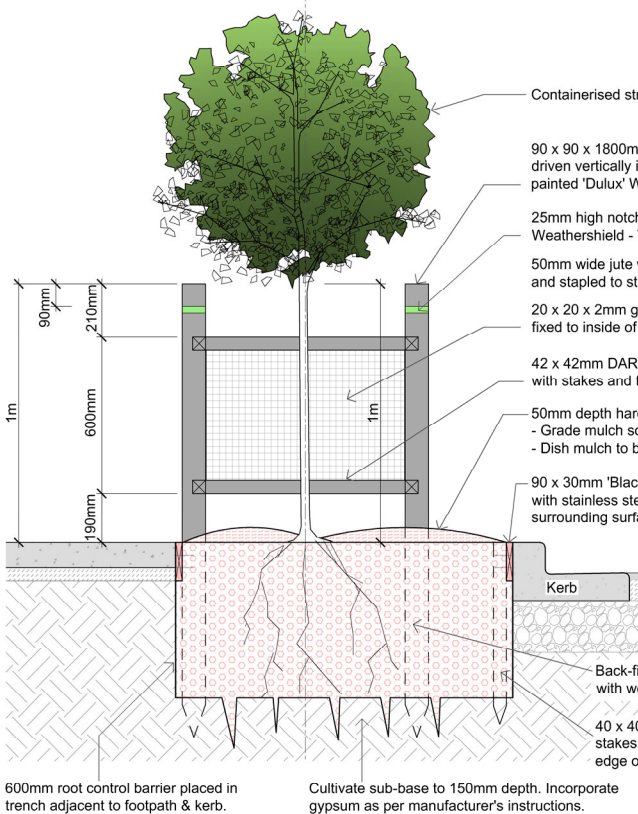

SECTION

TYPE 1 - PLANTING IN GRASS VERGE (SHOALHAVEN HEADS ROAD)

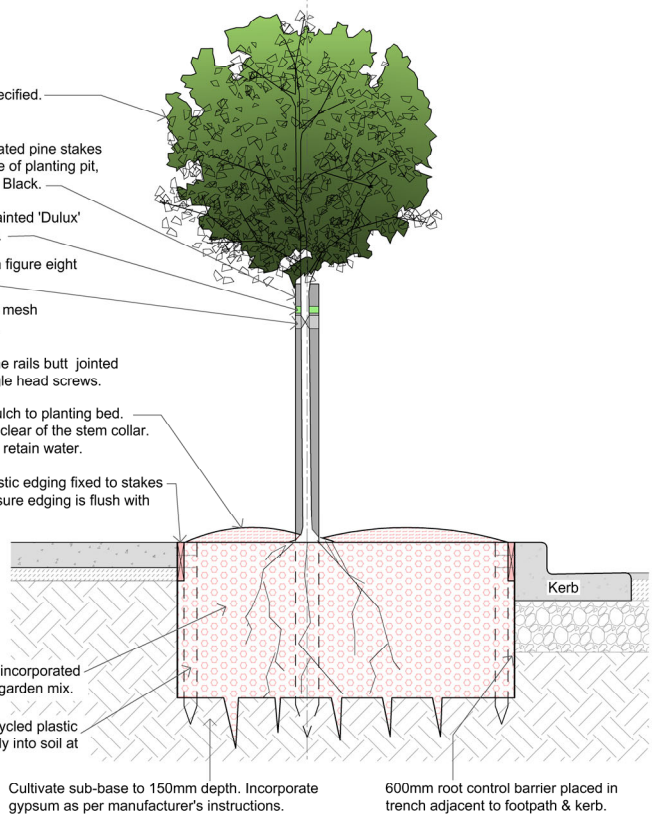

SECTION

TYPE 2 - PLANTING IN GRASS VERGE / ROAD BLISTER



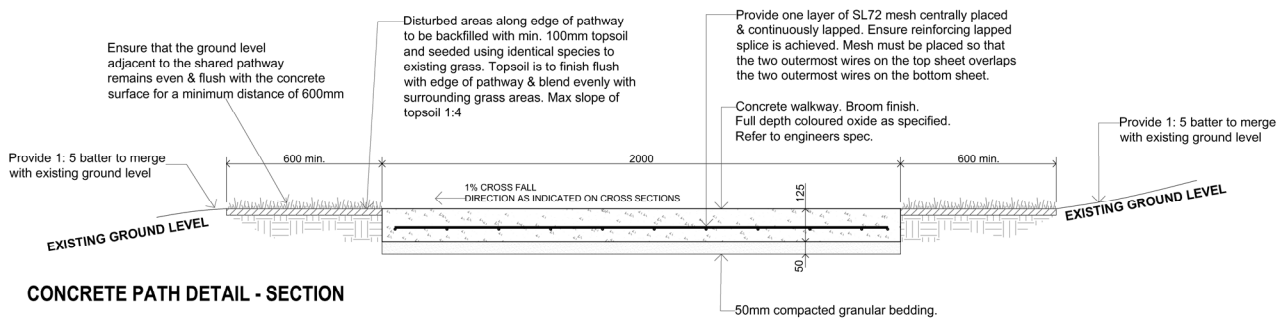

## CONCRETE PATH DETAIL - SECTION

### Typical Notes:

Concrete 32mpa concrete (due to colour)  
Provide full depth colour oxide with a maximum 20mm aggregate size as specified.  
Colour: Sandstone

Broom finish. Ensure minimum slip resistance of R10 is achieved.

Finish concrete flush with adjoining surfaces.

Provide expansion joints at 6m intervals or as indicated on plans.  
Provide contraction joints at 3m intervals or as indicated on plans. These cuts should be made within 12hrs of concrete placement or as soon as the concrete is strong enough to support the sawing equipment.

Typically 1% cross falls or as indicated on plans / cross section.

All dimensions are in millimeters unless noted otherwise.

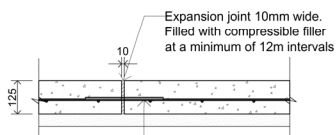

Dowel Galvanised and fixed. Centrally located. 300 long at 300 centres. Dowels must be supported in a way that no steel crosses the joint except for the dowel.

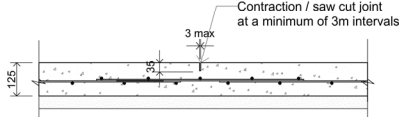

## CONCRETE PATH EXPANSION JOINT DETAIL

## CONCRETE PATH CONTRACTION JOINT DETAIL

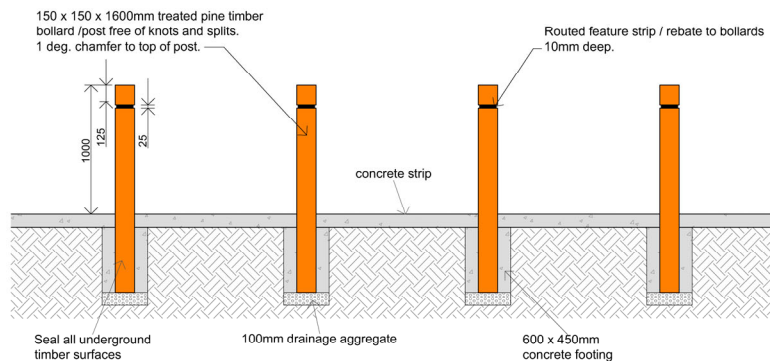
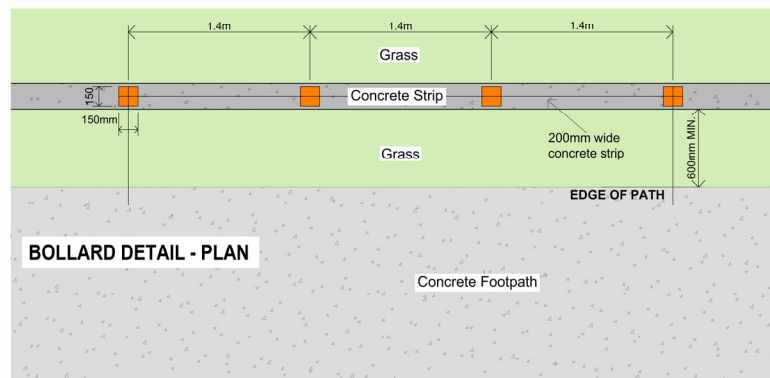

### Timber Bollard Notes:

Install bollards a minimum distance of 1m from edge of pathway.  
All cut edges (including ends of posts) should be resealed with "protum reseat" prior to staining. Coat all timber with watty! "forestwood - sagebrush". The stain must be an oil based product to adhere to the reseat. Recoat yearly to maintain colour.



Example of Preferred Bollard Treatment On Shared User Pathways

### Bollards in Shared User Pathways:

If bollards are used on Shared User Pathways, they must;

- Be properly marked with reflective tape.
- Have suitable unbroken centreline linemarking.
- Provide adequate clearances from the bollards for riders and pedestrians.
- Not be used within a path travel lane.





Existing Dairy Shed - Artwork painting



Garden bed with sandstone edging



Proposed town banners



Tree lined entry street



Existing village entry sign

(A possible village entry sign on the northern village entrance could be considered in the future, subject to community consultation, design and council approval).

#### LEGEND

- Medium street trees (no overhead wires) - at 10m minimum spacings.
- Small street trees - at 7m minimum spacings
- Existing trees.
- Proposed shared user pathway.
- Existing pathway.
- Garden Bed Entry - Westringia 'Aussie Box' at 400mm spacings & Lomandra 'Crackerjack' at 400mm spacings.

#### LEGEND

- Existing Street Lights & Overhead Power Lines
- Existing Street Lights & Underground Services

**NOTE:**  
Location and layout of pedestrian thresholds and bus stop is in draft format only. Detailed design to conform with Austroads guidelines and Shoalhaven City Council's DCP100 following input from Traffic Unit.  
Tree location in accordance with Austroads 'Safe Road Design Principles'.  
Refer to Streetscape - Pathways (sheet 04), Vegetation Planting Scheme (sheet 06), Streetscape Typical Plans & Sections (sheets 10 & 11), Planting Details (sheet 12) and Pathway & Paving Details (sheet 13).

**Shoalhaven**  
City Council

Trim File No.: 46953E  
Drawing No.: 5267\_14A  
Approval Date 30/03/2022  
Version Number: 02



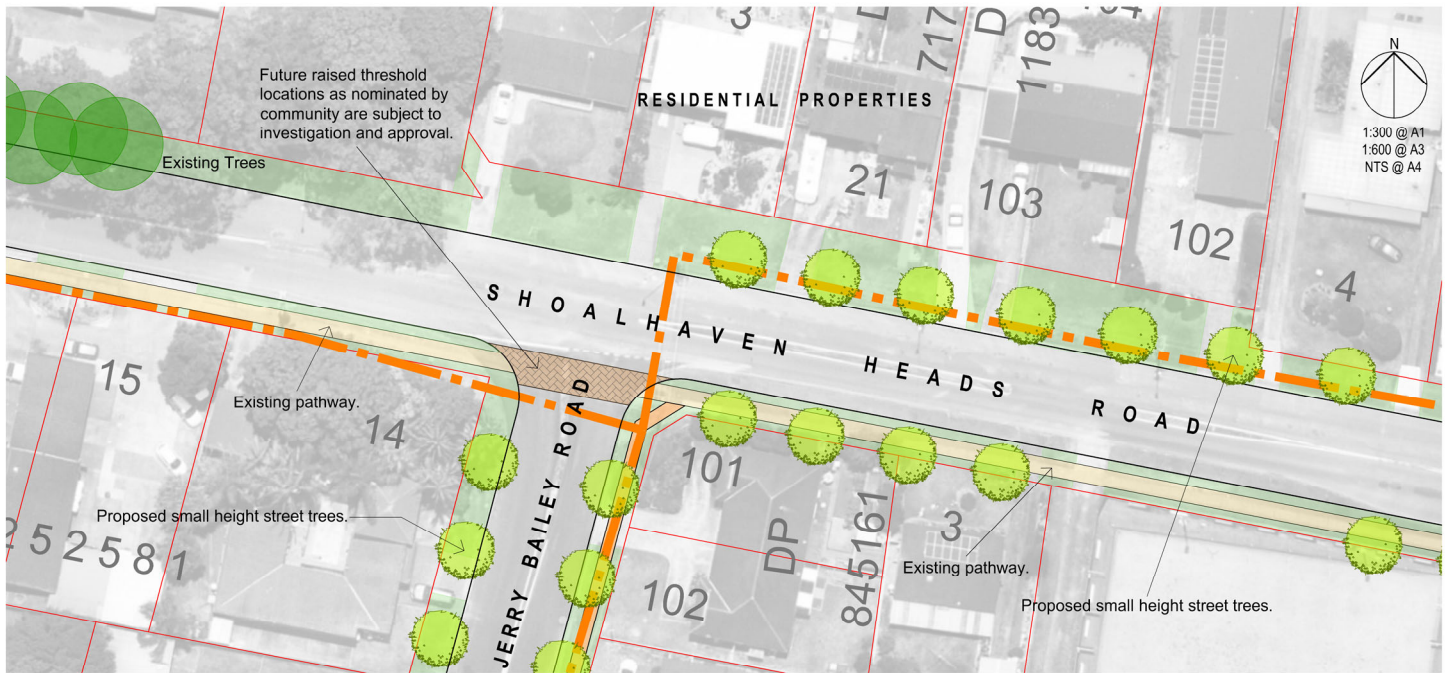

PEDESTRIAN CROSSING LOCATION - AREA 1

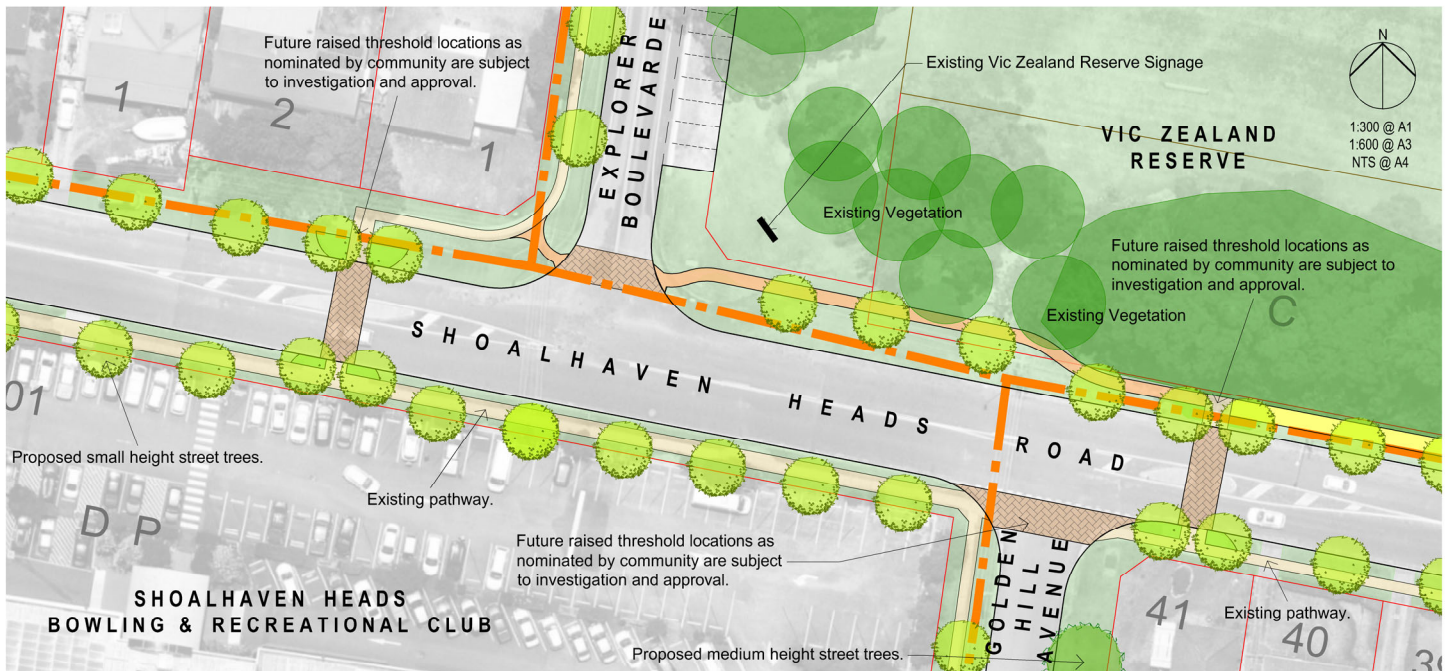

PEDESTRIAN CROSSING LOCATION - AREA 2

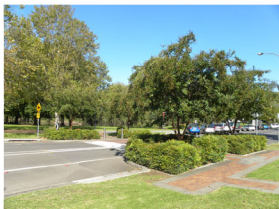

Landscaped pedestrian threshold



Pedestrian threshold bollards



Landscaped pedestrian threshold



Landscaped pedestrian threshold



#### LEGEND

- Medium street trees (no overhead wires) - at 10m minimum spacings.
- Small street trees - at 7m minimum spacings
- Existing trees.
- Proposed shared user pathway.
- Proposed pathway.
- Existing pathway.
- Future pedestrian crossing / raised threshold locations as nominated by community, subject to investigation and approval.

#### LEGEND

- Existing Street Lights & OverheadPower Lines
- Existing Street Lights & Underground Services

**NOTE:**  
Location and layout of pedestrian thresholds and bus stop is in draft format only. Detailed design to conform with Austroads guidelines and Shoalhaven City Council's DCP100 following input from Traffic Unit.  
Tree location in accordance with Austroads 'Safe Road Design Principles'.  
Refer to Streetscape - Pathways (sheet 04), Vegetation Planting Scheme (sheet 06), Streetscape Typical Plans & Sections (sheets 10 & 11), Planting Details (sheet 12) and Pathway & Paving Details (sheet 13).

**Shoalhaven**  
City Council

Trim File No.: 46953E  
Drawing No.: 5267\_14A  
Approval Date 30/03/2022  
Version Number: 02





Active recreation



Pathway to activate recreational area



Proposed outdoor fitness equipment station

#### LEGEND

- Medium street trees (no overhead wires) - at 10m minimum spacings.
- Small street trees - at 7m minimum spacings
- Existing trees.
- Proposed shared user pathway.
- Proposed pathway.
- Existing pathway.
- Future pedestrian crossing / raised threshold locations as nominated by community, subject to investigation and approval.

**NOTE:**  
Location and layout of pedestrian thresholds and bus stop is in draft format only. Detailed design to conform with Austroads guidelines and Shoalhaven City Council's DCP100 following input from Traffic Unit.  
Tree location in accordance with Austroads 'Safe Road Design Principles'.  
Refer to Streetscape - Pathways (sheet 04), Vegetation Planting Scheme (sheet 06), Streetscape Typical Plans & Sections (sheets 10 & 11), Planting Details (sheet 12) and Pathway & Paving Details (sheet 13).

#### LEGEND

- Existing Street Lights & Overhead Power Lines
- Existing Street Lights & Underground Services

**Shoalhaven**  
City Council

Trim File No.: 46953E  
Drawing No.: 5267\_14A  
Approval Date 30/03/2022  
Version Number: 02





Art / Banners / Lighting



Shared user pathway along green spine precinct



Green spine precinct



Outdoor dining spaces

#### LEGEND

- Medium street trees (no overhead wires) - at 10m minimum spacings.
- Small street trees - at 7m minimum spacings
- Existing trees.
- Proposed shared user pathway.
- Proposed pathway.
- Existing pathway.

#### LEGEND

- Existing Street Lights & Overhead Power Lines
- Existing Street Lights & Underground Services

**NOTE:**  
Draft plans on community and commercial land (public & private) are indicative of potential should development occur. The diagrams are also to assist in upgrading infrastructure.  
Location and layout of pedestrian thresholds and bus stop is in draft format only. Detailed design to conform with Austroads guidelines and Shoalhaven City Council's DCP100 following input from Traffic Unit.  
Tree location in accordance with Austroads 'Safe Road Design Principles'.  
Refer to Streetscape - Pathways (sheet 04), Vegetation Planting Scheme (sheet 06), Streetscape Typical Plans & Sections (sheets 10 & 11), Planting Details (sheet 12) and Pathway & Paving Details (sheet 13).

**Shoalhaven**  
City Council

Trim File No.: 46953E  
Drawing No.: 5267\_14A  
Approval Date 30/03/2022  
Version Number: 02





Parents meeting area

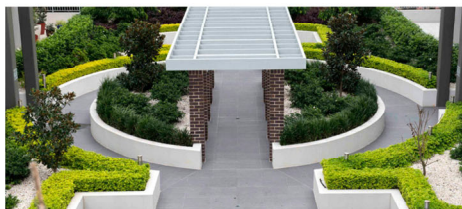

Formal entry statement to the community centre



Paving treatment

#### LEGEND

- Medium street trees (no overhead wires) - at 10m minimum spacings.
- Small street trees - at 7m minimum spacings
- Existing trees.
- Proposed shared user pathway.
- Proposed pathway.
- Existing pathway.

#### LEGEND

- Existing Street Lights & Overhead Power Lines
- Existing Street Lights & Underground Services

**NOTE:**  
Draft plans on community and commercial land (public & private) are indicative of potential should development occur. The diagrams are also to assist in upgrading infrastructure. Location and layout of pedestrian thresholds and bus stop is in draft format only. Detailed design to conform with Austroads guidelines and Shoalhaven City Council's DCP100 following input from Traffic Unit. Tree location in accordance with Austroads 'Safe Road Design Principles'. Refer to Streetscape - Pathways (sheet 04), Vegetation Planting Scheme (sheet 06), Streetscape Typical Plans & Sections (sheets 10 & 11), Planting Details (sheet 12) and Pathway & Paving Details (sheet 13).

**Shoalhaven**  
City Council

Trim File No.: 46953E  
Drawing No.: 5267\_14A  
Approval Date 30/03/2022  
Version Number: 02



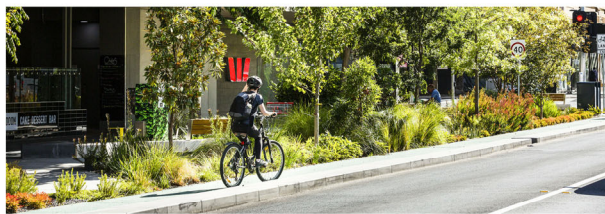

Shared user pathway along green spine precinct



Landscaping embellishments including street furniture and bin enclosures



#### LEGEND

- Medium street trees (no overhead wires) - at 10m minimum spacings.
- Small street trees - at 7m minimum spacings
- Existing trees.
- Proposed shared user pathway.
- Proposed pathway.
- Existing pathway.

#### LEGEND

- Existing Street Lights & OverheadPower Lines
- Existing Street Lights & Underground Services

**NOTE:**  
Draft plans on community and commercial land (public & private) are indicative of potential should development occur. The diagrams are also to assist in upgrading infrastructure.  
Location and layout of pedestrian thresholds and bus stop is in draft format only. Detailed design to conform with Austroads guidelines and Shoalhaven City Council's DCP100 following input from Traffic Unit.  
Tree location in accordance with Austroads 'Safe Road Design Principles'.  
Refer to Streetscape - Pathways (sheet 04), Vegetation Planting Scheme (sheet 06), Streetscape Typical Plans & Sections (sheets 10 & 11), Planting Details (sheet 12) and Pathway & Paving Details (sheet 13).

**Shoalhaven**  
City Council

Trim File No.: 46953E  
Drawing No.: 5267\_14A  
Approval Date 30/03/2022  
Version Number: 02





Existing retail precinct upgrade



Mural for rear or side of building



Integration of trees in road verge



Community gathering space

#### LEGEND

- Medium street trees (no overhead wires) - at 10m minimum spacings.
- Small street trees - at 7m minimum spacings
- Existing trees.
- Proposed shared user pathway.
- Proposed pathway.
- Existing pathway.
- Future pedestrian crossing / raised threshold locations as nominated by community, subject to investigation and approval.

#### LEGEND

- Existing Street Lights & OverheadPower Lines
- Existing Street Lights & Underground Services

**NOTE:**  
Location and layout of pedestrian thresholds and bus stop is in draft format only. Detailed design to conform with Austroads guidelines and Shoalhaven City Council's DCP100 following input from Traffic Unit.  
Tree location in accordance with Austroads 'Safe Road Design Principles'.  
Refer to Streetscape - Pathways (sheet 04), Vegetation Planting Scheme (sheet 06), Streetscape Typical Plans & Sections (sheets 10 & 11), Planting Details (sheet 12) and Pathway & Paving Details (sheet 13).

**Shoalhaven**  
City Council  
Trim File No.: 46953E  
Drawing No.: 5267\_14A  
Approval Date 30/03/2022  
Version Number: 02









Gumley Reserve playground



Viewing platform & walkway upgrade

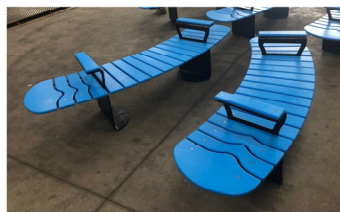

Picnic area upgrade (furniture & bins)



Proposed pathway upgrade

#### LEGEND

- Medium street trees (no overhead wires) - at 10m minimum spacings.
- Small street trees - at 7m minimum spacings
- Existing trees.
- Proposed shared user pathway.
- Proposed pathway.
- Existing pathway.
- Future pedestrian crossing / raised threshold locations as nominated by community, subject to investigation and approval.

#### LEGEND

- Existing Street Lights & OverheadPower Lines
- Existing Street Lights & Underground Services

**NOTE:**  
Location and layout of pedestrian thresholds and bus stop is in draft format only. Detailed design to conform with Austroads guidelines and Shoalhaven City Council's DCP100 following input from Traffic Unit.  
Tree location in accordance with Austroads 'Safe Road Design Principles'.  
Refer to Streetscape - Pathways (sheet 04), Vegetation Planting Scheme (sheet 06), Streetscape Typical Plans & Sections (sheets 10 & 11), Planting Details (sheet 12) and Pathway & Paving Details (sheet 13).

**Shoalhaven**  
City Council  
Trim File No.: 46953E  
Drawing No.: 5267\_14A  
Approval Date 30/03/2022  
Version Number: 02









River Road Reserve jetty



Shared user pathway



Fitness equipment



Amenities building mural

#### LEGEND

- Medium street trees (no overhead wires) - at 10m minimum spacings.
- Small street trees - at 7m minimum spacings
- Existing trees.
- Proposed shared user pathway.
- Proposed pathway.
- Existing pathway.

#### LEGEND

- Existing Street Lights & OverheadPower Lines
- Existing Street Lights & Underground Services

#### NOTE:

River Road Reserve landscape installation is complete. Periodic maintenance and repair / replacement is to be undertaken by the District Engineer.

Tree location in accordance with Austroads 'Safe Road Design Principles'.

Refer to Streetscape - Pathways (sheet 04), Vegetation Planting Scheme (sheet 06), Streetscape Typical Plans & Sections (sheets 10 & 11), Planting Details (sheet 12) and Pathway & Paving Details (sheet 13).

**Shoalhaven**  
City Council

Trim File No.: 46953E  
Drawing No.: 5267\_14A  
Approval Date 30/03/2022  
Version Number: 02





Existing street tree - *Banksia serrata*



River Road viewing platform



River Road stairway platform



Proposed street trees - *Banksia integrifolia*

- LEGEND**
- Medium street trees (no overhead wires) - at 10m minimum spacings.
  - Small street trees - at 7m minimum spacings
  - Existing trees.
  - Proposed shared user pathway.
  - Proposed pathway.
  - Existing pathway.
  - Future pedestrian crossing / raised threshold locations as nominated by community, subject to investigation and approval.

- LEGEND**
- Existing Street Lights & Overhead Power Lines
  - Existing Street Lights & Underground Services

**NOTE:**  
 River Road Jetty landscape installation is complete. Periodic maintenance and repair / replacement is to be undertaken by the District Engineer.  
 Tree location in accordance with Austroads 'Safe Road Design Principles'.  
 Refer to Streetscape - Pathways (sheet 04), Vegetation Planting Scheme (sheet 06), Streetscape Typical Plans & Sections (sheets 10 & 11), Planting Details (sheet 12) and Pathway & Paving Details (sheet 13).

**Shoalhaven City Council**  
 Trim File No.: 46953E  
 Drawing No.: 5267\_14A  
 Approval Date 30/03/2022  
 Version Number: 02





Existing Adventure Matrix



Existing Meeting Place

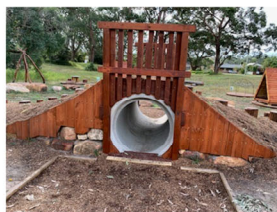

Existing Nature Playground



#### LEGEND

- Medium street trees (no overhead wires) - at 10m minimum spacings.
- Small street trees - at 7m minimum spacings
- Existing trees.
- Proposed shared user pathway.
- Proposed pathway.
- Existing pathway.

#### LEGEND

- Existing Street Lights & Overhead Power Lines
- Existing Street Lights & Underground Services

**NOTE:**  
Tree location in accordance with Austroads 'Safe Road Design Principles'.  
Refer to Streetscape - Pathways (sheet 04), Vegetation Planting Scheme (sheet 06), Streetscape Typical Plans & Sections (sheets 10 & 11), Planting Details (sheet 12) and Pathway & Paving Details (sheet 13).

**Shoalhaven**  
City Council  
Trim File No.: 46953E  
Drawing No.: 5267\_14A  
Revision Date: 12/10/2021  
Version Number: 02