

SITE LOCATION PLAN - N.T.S

DOLPHIN POINT RD. TREE PLANTING CONCEPT DESIGN

DOLPHIN POINT RD.
DOLPHIN POINT, NSW

FOR INFORMATION

NO.	TITLE	REV
LA000	COVER PAGE	C
LA001	SITE PLAN	C
LA002	PLANTING PLAN - A	C
LA003	PLANTING PLAN - B	C
LA004	PLANTING PLAN - C	C
LA005	LANDSCAPE DETAILS	C

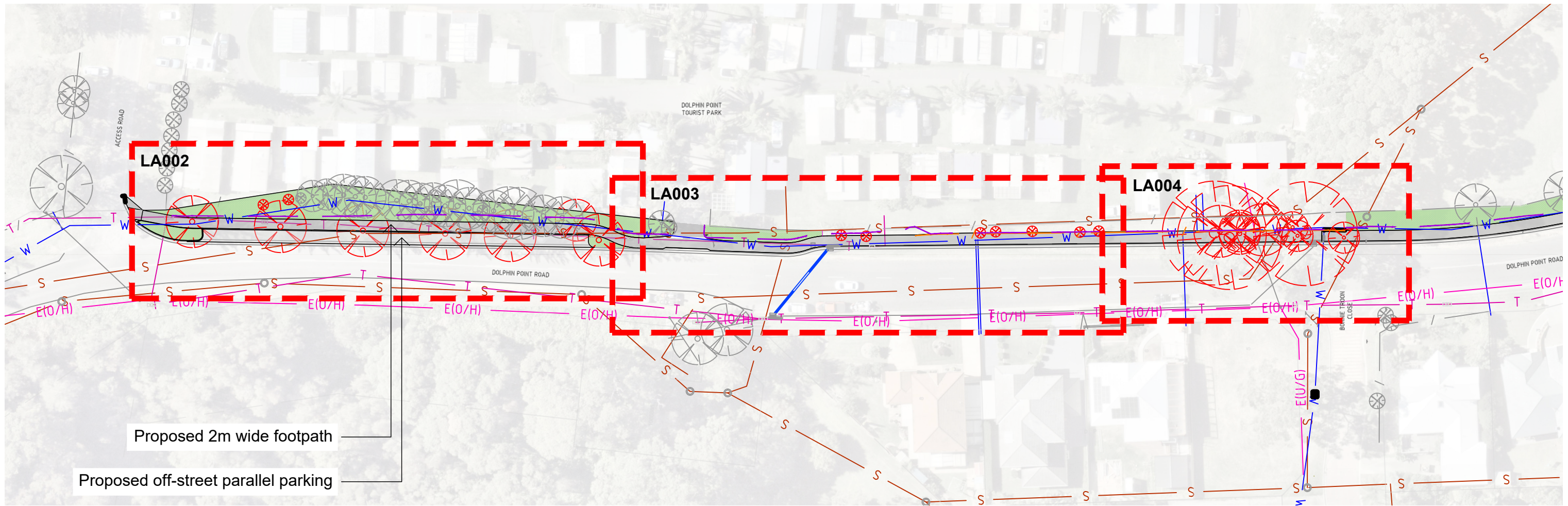

LEGEND

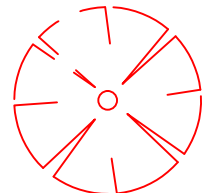
- E(O/H) — Overhead power line
- E(U/G) — Underground power line
- S — Sewer services
- W — Water services
- T — Telstra services
-  Existing trees to be retained and protected in accordance with AS 4970-2009
-  Existing trees to be removed

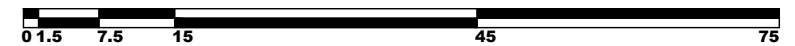

29/05/2025 9:07 AM
 DRAWN BY: BD
 CHECKED BY: JS
 APPROVED BY: PD

[REV#]	[DESCRIPTION]	[DATE]
A	Concept Planting Plan	30/05/2025
B	Changes Applied	02/06/2025
C	Changes Applied	17/06/2025

STATUS	TRIM REFERENCE	PLAN REFERENCE	SURVEYED BY
CONCEPT DESIGN	68997E	5590	AB

GENERAL NOTES

The Builder shall check all dimensions and levels on site prior to construction. Notify any errors, discrepancies or omissions to the architect. Refer to written dimensions only. Do not scale drawings. Drawings shall not be used for construction purposes until issued for construction. This drawing reflects a design by Shoalhaven City Council and is to be used only for work when authorised in writing by Shoalhaven City Council.

All boundaries and contours are subject to survey drawing. All levels to Australian Height Data. It is the contractors responsibility to confirm all measurements on site and locations of any services prior to work on site.

All documents here within are subject to Australian Copyright Laws.

PROJECT NAME
DOLPHIN POINT RD. TREE PLANTING

PROJECT ADDRESS
DOLPHIN POINT RD. DOLPHIN POINT NSW

CLIENT
CITY SERVICES, SHOALHAVEN CITY COUNCIL



[SCALE] 1:750 @ A3 [DWG] LA001 [REV] C

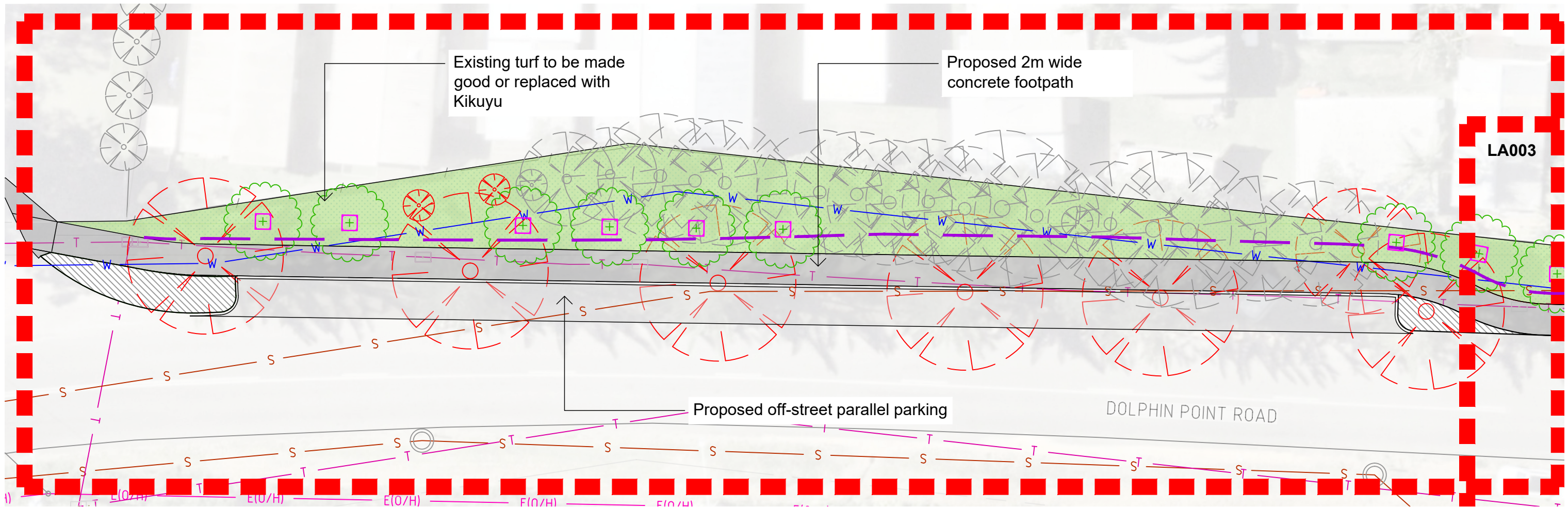

LEGEND

- Overhead power line
- Underground power line
- Sewer services
- Water services
- Telstra services

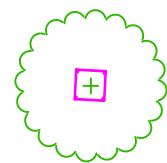

Proposed *Cupaniopsis anacardioides* (Tuckeroo) with timber edging
Refer landscape detail B on LA005



Proposed *Grevillea johnsonii x wilsonii* 'Bonfire' with understorey planting
Refer to landscape detail A on LA005



Proposed *Callistemon viminalis* 'Prolific' with understorey planting
Refer to landscape detail A on LA005



Proposed *Lomandra confertifolia* 'Little Pal' @ 3/m²

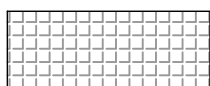

Proposed *Lomandra longifolia* 'Tanika' @ 1/m²



Proposed retaining wall

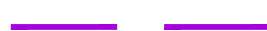

New extent of earth batter



Proposed timber edging

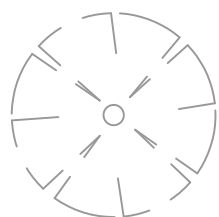

Existing trees to be retained and protected in accordance with AS 4970-2009

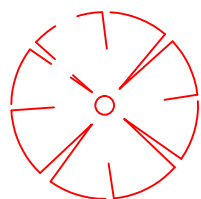

Existing trees to be removed



29/05/2025 9:07 AM
DRAWN BY: BD
CHECKED BY: JS
APPROVED BY: PD

[REV#]	[DESCRIPTION]	[DATE]
A	Concept Planting Plan	30/05/2025
B	Changes Applied	02/06/2025
C	Changes Applied	17/06/2025

STATUS	TRIM REFERENCE	PLAN REFERENCE	SURVEYED BY
CONCEPT DESIGN	68997E	5590	AB

GENERAL NOTES

The Builder shall check all dimensions and levels on site prior to construction. Notify any errors, discrepancies or omissions to the architect. Refer to written dimensions only. Do not scale drawings. Drawings shall not be used for construction purposes until issued for construction. This drawing reflects a design by Shoalhaven City Council and is to be used only for work when authorised in writing by Shoalhaven City Council.

All boundaries and contours are subject to survey drawing. All levels to Australian Height Data. It is the contractors responsibility to confirm all measurements on site and locations of any services prior to work on site. All documents here within are subject to Australian Copyright Laws.

PROJECT NAME

DOLPHIN POINT RD. TREE PLANTING

PROJECT ADDRESS

DOLPHIN POINT RD. DOLPHIN POINT NSW

CLIENT

CITY SERVICES, SHOALHAVEN CITY COUNCIL



PLANTING PLAN - A

[SCALE] 1:250 @ A3 [DWG] LA002

[REV] C

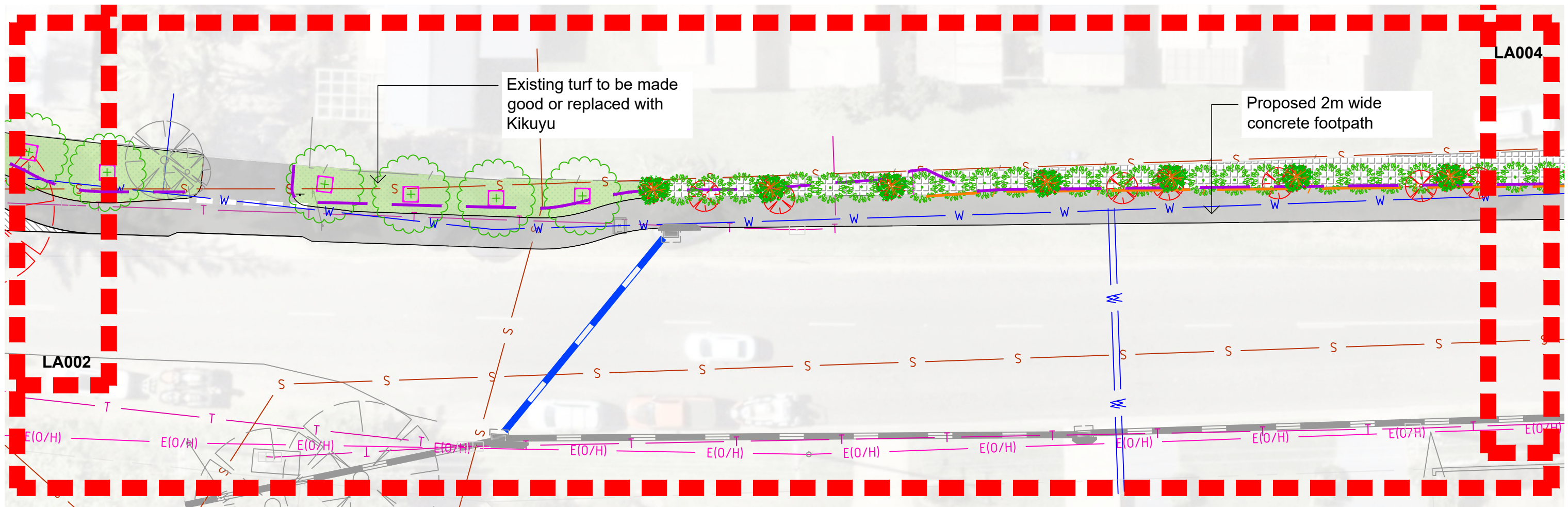

LEGEND

- E(O/H) Overhead power line
- E(U/G) Underground power line
- S Sewer services
- W Water services
- T Telstra services

- Existing trees to be retained and protected in accordance with AS 4970-2009
- Existing trees to be removed

- Proposed Cupaniopsis anacardioides (Tuckeroo) with timber edging
Refer landscape detail B on LA005
- Proposed Grevillea johnsonii x wilsonii 'Bonfire' with understorey planting
Refer to landscape detail A on LA005
- Callistemon viminalis 'Prolific' with understorey planting
Refer to landscape detail A on LA005
- Proposed Lomandra confertifolia 'Little Pal' @ 3/m²
- Proposed Lomandra longifolia 'Tanika' @ 1/m²
- Proposed retaining wall
- New extent of earth batter
- Proposed timber edging



29/05/2025 9:07 AM
DRAWN BY: BD
CHECKED BY: JS
APPROVED BY: PD

[REV#]	[DESCRIPTION]	[DATE]
A	Concept Planting Plan	30/05/2025
B	Changes Applied	02/06/2025
C	Changes Applied	17/06/2025

STATUS	TRIM REFERENCE	PLAN REFERENCE	SURVEYED BY
CONCEPT DESIGN	68997E	5590	AB

GENERAL NOTES

The Builder shall check all dimensions and levels on site prior to construction. Notify any errors, discrepancies or omissions to the architect. Refer to written dimensions only. Do not scale drawings. Drawings shall not be used for construction purposes until issued for construction. This drawing reflects a design by Shoalhaven City Council and is to be used only for work when authorised in writing by Shoalhaven City Council.

All boundaries and contours are subject to survey drawing. All levels to Australian Height Data. It is the contractors responsibility to confirm all measurements on site and locations of any services prior to work on site.

All documents here within are subject to Australian Copyright Laws.

PROJECT NAME
DOLPHIN POINT RD. TREE PLANTING

PROJECT ADDRESS
DOLPHIN POINT RD. DOLPHIN POINT NSW

CLIENT
CITY SERVICES, SHOALHAVEN CITY COUNCIL

PLANTING PLAN - B

[SCALE] **1:250 @ A3** [DWG] **LA003** [REV] **C**

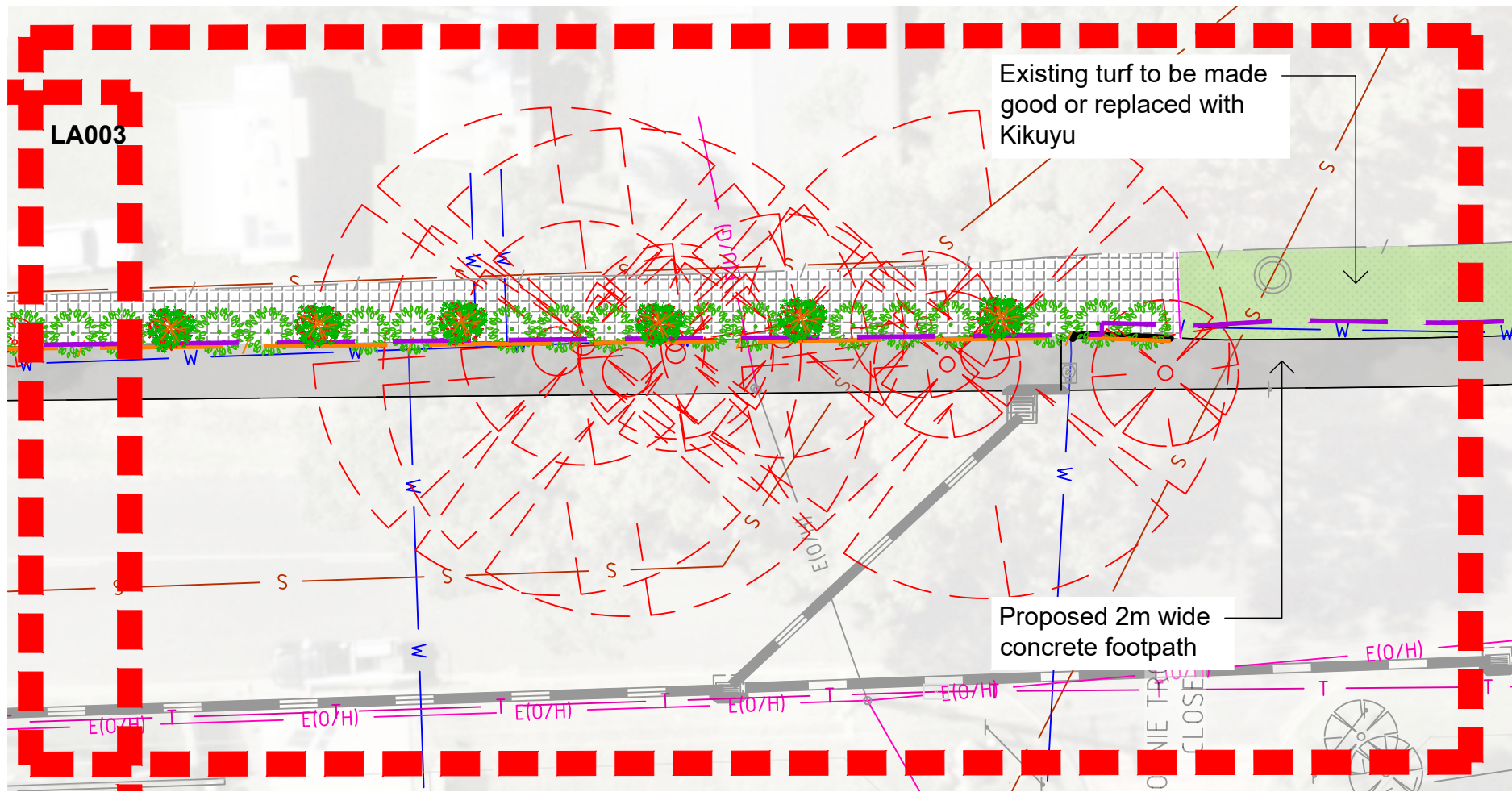

Callistemon viminalis 'Prolific'



Cupaniopsis anacardioides (Tuckeroo)



Grevillea johnsonii x wilsonii 'Bonfire'



Lomandra confertifolia 'Little Pal'



Lomandra longifolia 'Tanika'

LEGEND

- E(0/H) Overhead power line
- E(U/G) Underground power line
- S Sewer services
- W Water services
- T Telstra services

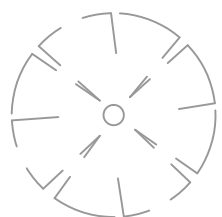

Existing trees to be retained and protected in accordance with AS 4970-2009

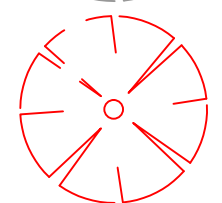

Existing trees to be removed

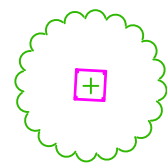

Proposed Cupaniopsis anacardioides (Tuckeroo) with timber edging
Refer landscape detail B on LA005



Proposed Grevillea johnsonii x wilsonii 'Bonfire' with understorey planting
Refer to landscape detail A on LA005



Proposed Callistemon viminalis 'Prolific' with understorey planting
Refer to landscape detail A on LA005



Proposed Lomandra confertifolia 'Little Pal' @ 3/m²

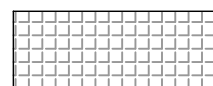

Proposed Lomandra longifolia 'Tanika' @ 1/m²



Proposed retaining wall



New extent of earth batter



Proposed timber edging

DOLPHIN POINT RD. PLANT SCHEDULE						
SYMBOL	BOTANICAL NAME	COMMON NAME	QUANTITY	POT SIZE	MATURE SIZE (H x W)	SPACING
Ca	Cupaniopsis anacardioides	Tuckeroo	11	70L	7m x 5m	As show n
Cav P	Callistemon viminalis 'Prolific'	Bottlebrush	13	400mm	5m x 3m	As show n
Gj B	Grevillea johnsonii x wilsonii 'Bonfire'	Grevillea Bonfire	38	400mm	2m x 2m	As show n
Loc LP	Lomandra confertifolia 'Little Pal'	Lomandra Little Pal	105	200mm	0.5m x 0.5m	3/m ²
LoI T	Lomandra longifolia 'Tanika'	Lomandra Tanika	208	200mm	0.6 x 0.6	1/m ²

[REV#]	[DESCRIPTION]	[DATE]
A	Concept Planting Plan	30/05/2025
B	Changes Applied	02/06/2025
C	Changes Applied	17/06/2025

STATUS	TRIM REFERENCE	PLAN REFERENCE	SURVEYED BY
CONCEPT DESIGN	68997E	5590	AB

GENERAL NOTES

The Builder shall check all dimensions and levels on site prior to construction. Notify any errors, discrepancies or omissions to the architect. Refer to written dimensions only. Do not scale drawings. Drawings shall not be used for construction purposes until issued for construction. This drawing reflects a design by Shoalhaven City Council and is to be used only for work when authorised in writing by Shoalhaven City Council.

All boundaries and contours are subject to survey drawing. All levels to Australian Height Data. It is the contractors responsibility to confirm all measurements on site and locations of any services prior to work on site.

All documents here within are subject to Australian Copyright Laws.

PROJECT NAME

DOLPHIN POINT RD. TREE PLANTING

PROJECT ADDRESS

DOLPHIN POINT RD. DOLPHIN POINT NSW

CLIENT

CITY SERVICES, SHOALHAVEN CITY COUNCIL



PLANTING PLAN - C



[SCALE] 1:250 @ A3 [DWG] LA004

[REV] C

NOTES

- Give all plants a thorough soaking at the time of planting with 'Seasol' and again 7 days later
- Water twice weekly until established

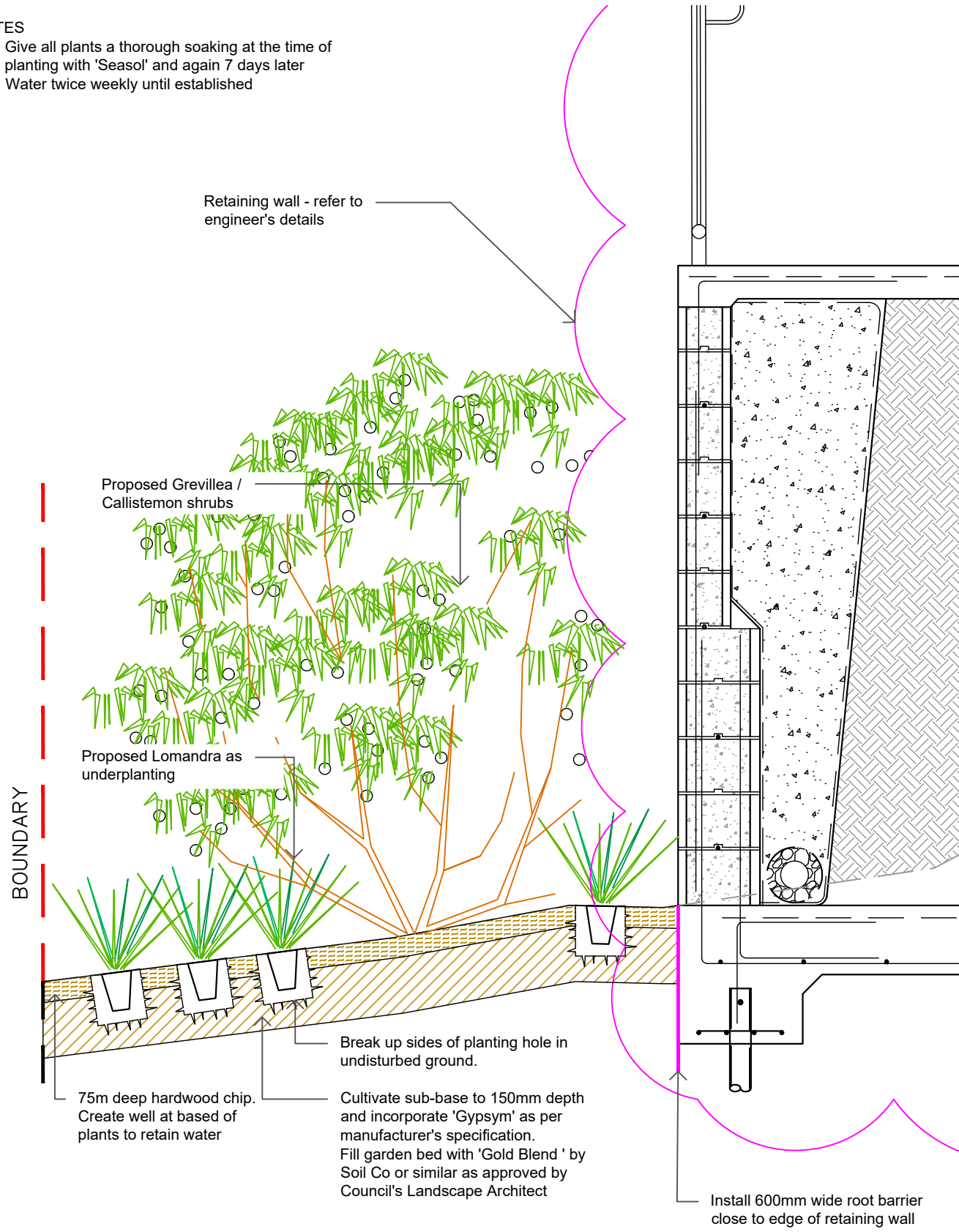

DETAIL - A
TREE PLANTING WITH ROOT BARRIER
SHEET LA005
SCALE 1:20

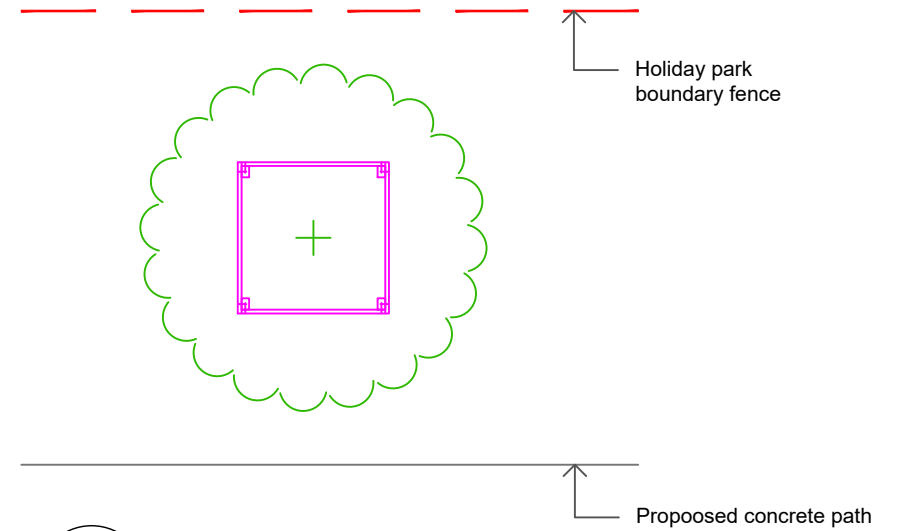

DETAIL - B
TREE PLANTING WITH ROOT BARRIER
SHEET LA005
SCALE 1:50

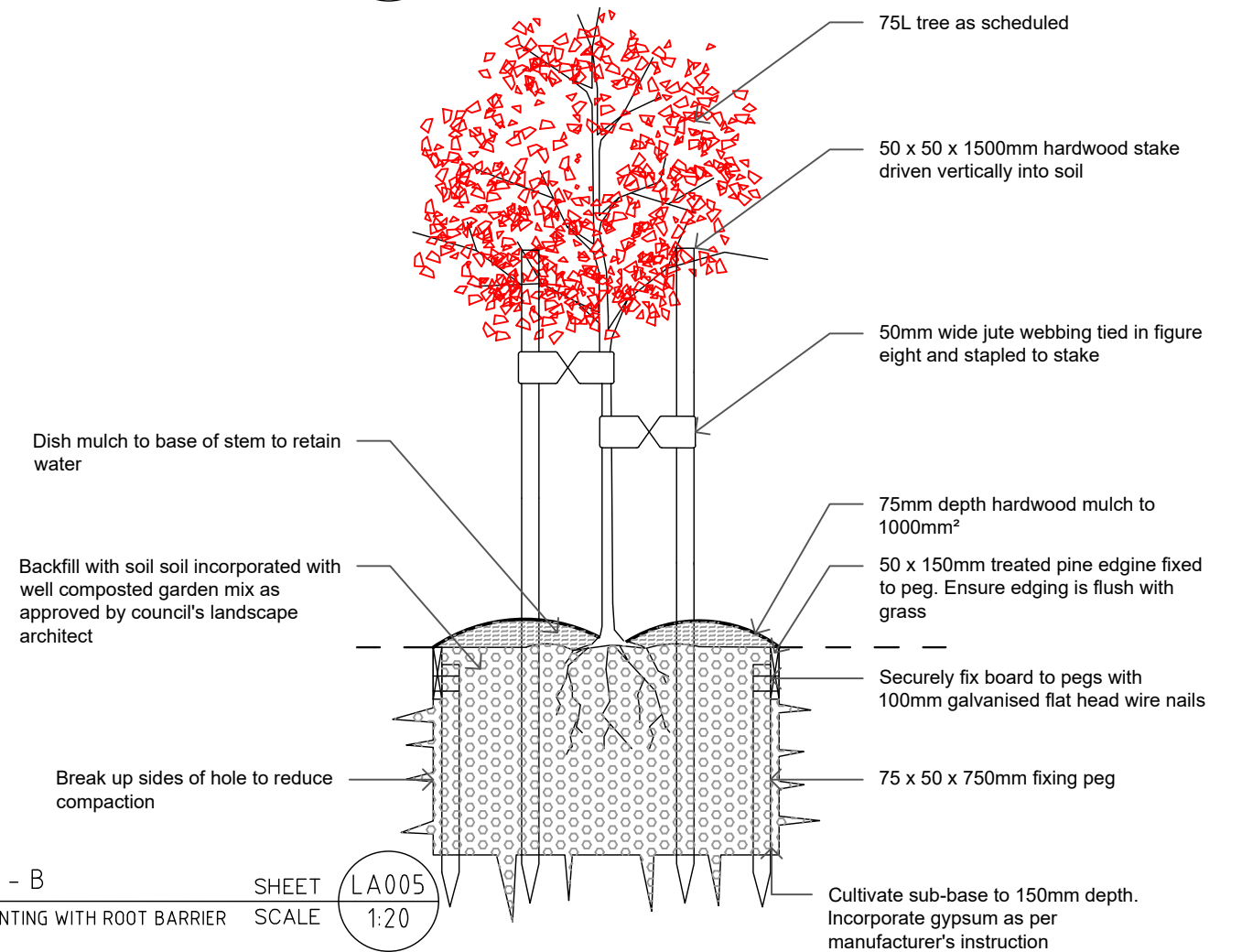

DETAIL - B
TREE PLANTING WITH ROOT BARRIER
SHEET LA005
SCALE 1:20



29/05/2025 9:07 AM
DRAWN BY: BD
CHECKED BY: JS
APPROVED BY: PD

[REV#]	[DESCRIPTION]	[DATE]
A	Concept Planting Plan	30/05/2025
B	Changes Applied	02/06/2025
C	Changes Applied	17/06/2025

STATUS	TRIM REFERENCE	PLAN REFERENCE	SURVEYED BY
CONCEPT DESIGN	68997E	5590	AB

GENERAL NOTES

The Builder shall check all dimensions and levels on site prior to construction. Notify any errors, discrepancies or omissions to the architect. Refer to written dimensions only. Do not scale drawings. Drawings shall not be used for construction purposes until issued for construction. This drawing reflects a design by Shoalhaven City Council and is to be used only for work when authorised in writing by Shoalhaven City Council.

All boundaries and contours are subject to survey drawing. All levels to Australian Height Data. It is the contractors responsibility to confirm all measurements on site and locations of any services prior to work on site.

All documents here within are subject to Australian Copyright Laws.

PROJECT NAME
DOLPHIN POINT RD. TREE PLANTING

PROJECT ADDRESS
DOLPHIN POINT RD. DOLPHIN POINT NSW

CLIENT
CITY SERVICES, SHOALHAVEN CITY COUNCIL

LANDSCAPE DETAILS

[SCALE] **AS SHOWN** [DWG] **LA005** [REV] **C**