

Mains Program PACKAGE 1

MAPS

SHOALHAVEN WATER

Contents

#1A – Cnr Coonemia Rd & Currarong Rd along Currarong Rd to Pump Station 6	3
#1B - Approximately 3.6km along Currarong Road From Pump Station 6 towards Lighthouse Rd.	4
#1C - Currarong from Nowra Rd, Fishery Rd to Piscator Ave, Piscator Ave to Crookhaven St.	5
#1D – Not Used	5
#1E - Crookhaven St to Reservoir (TM15)	6
#1F – From Callala Bay Rd along bushfire easement to 53 Stott St (CALBUSH2).....	6
#1G - From Lennox Rd down King Georges St to Centre St (TM12)	7
#1H – From Centre St along King Georges St to Sir Henry Cres to Nelson Beach	8
#1I – Culburra Rd/ Mayfield	9
#1J – Ryans Lane	10
#1K – Apperleys Lane	11
#1L – Bournes Lane	12
#1M – Woodstock Rd Milton	13
#1N – Croziers Rd Water Main Duplication	14
#1O – Kangaroo Valley Reservoir Water Main Duplication	15
#1P – Currarong Water Main Duplication	16
#1Q – Berry from pump station to Res KV Rd (TM50)	17
#1R – Kangaroo Valley Road (TM 50).....	18
#1S – Croobyar Road	19

#1A – Cnr Coonemia Rd & Currarong Rd along Currarong Rd to Pump Station 6



#1B - Approximately 3.6km along Currarong Road From Pump Station 6 towards Lighthouse Rd.

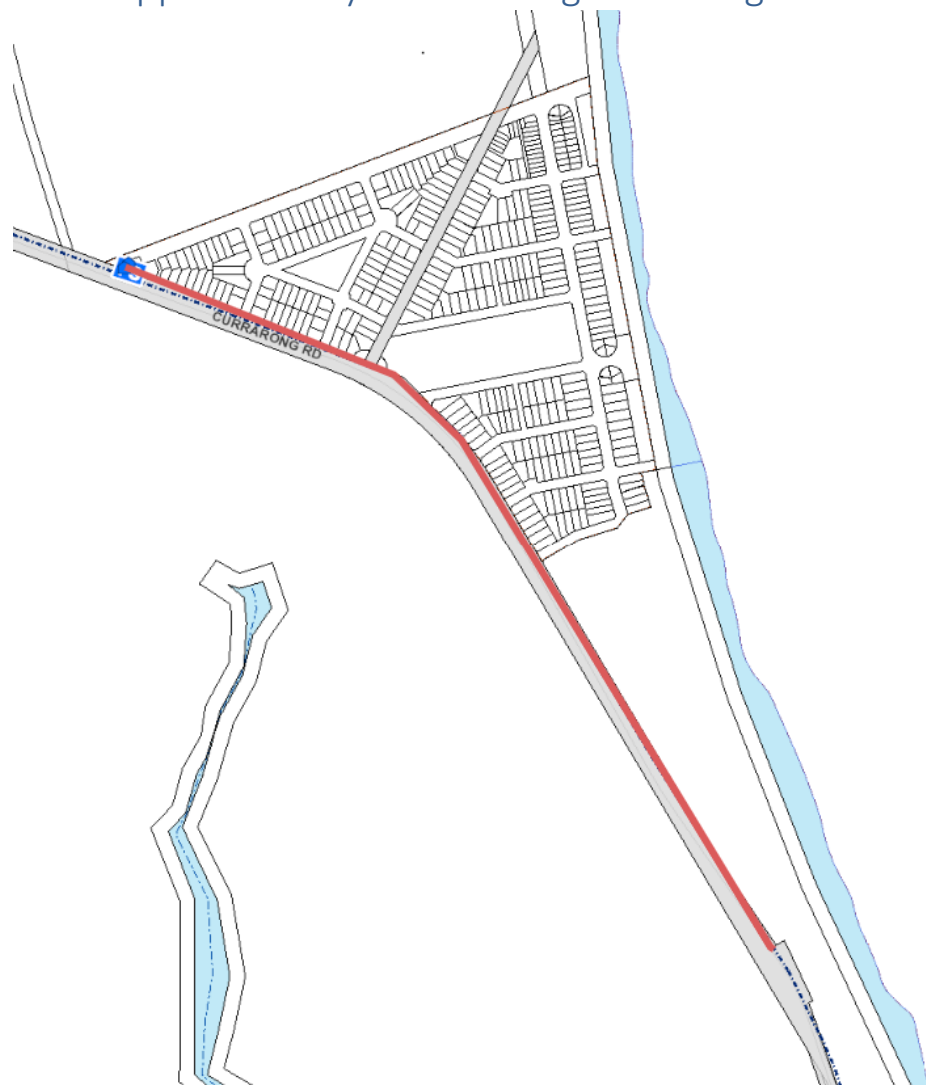

#1C - Currarong from Nowra Rd, Fishery Rd to Piscator Ave, Piscator Ave to Crookhaven St.

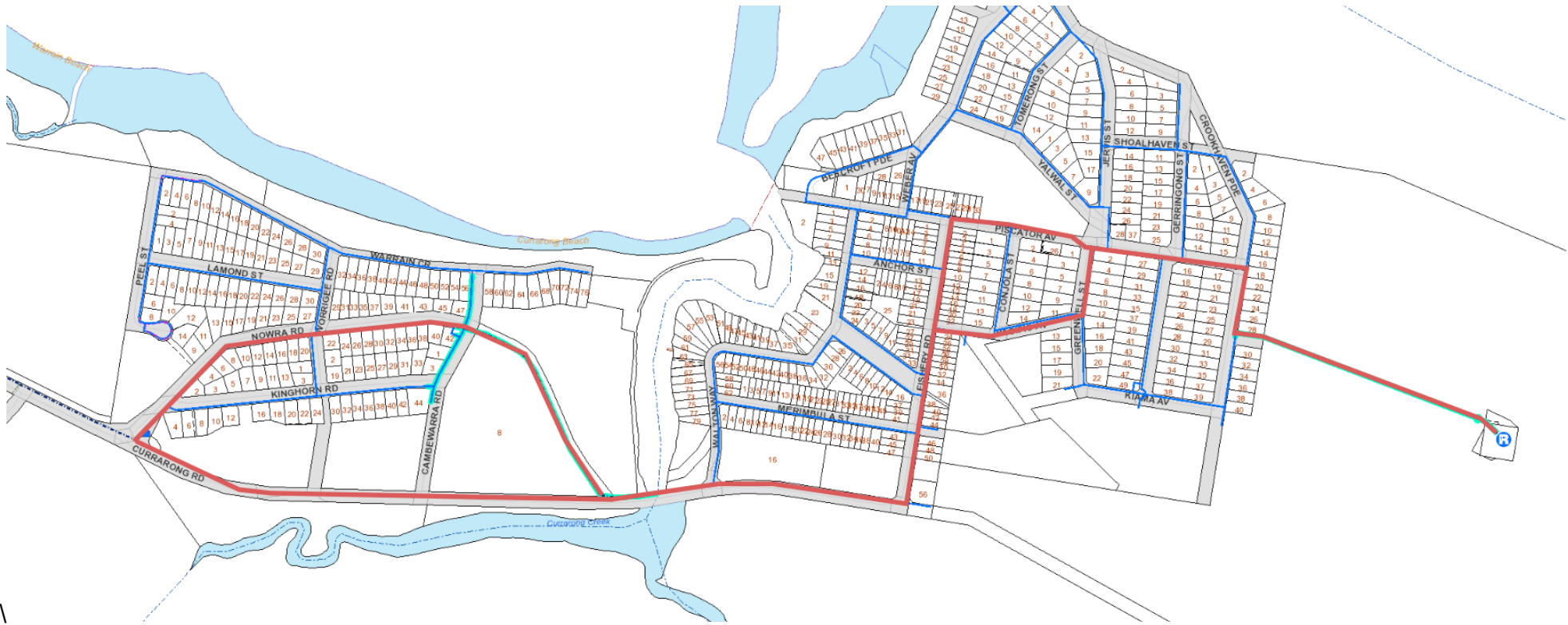

#1D — Not Used

#1E - Crookhaven St to Reservoir (TM15)



#1F – From Callala Bay Rd along bushfire easement to 53 Stott St (CALBUSH2)

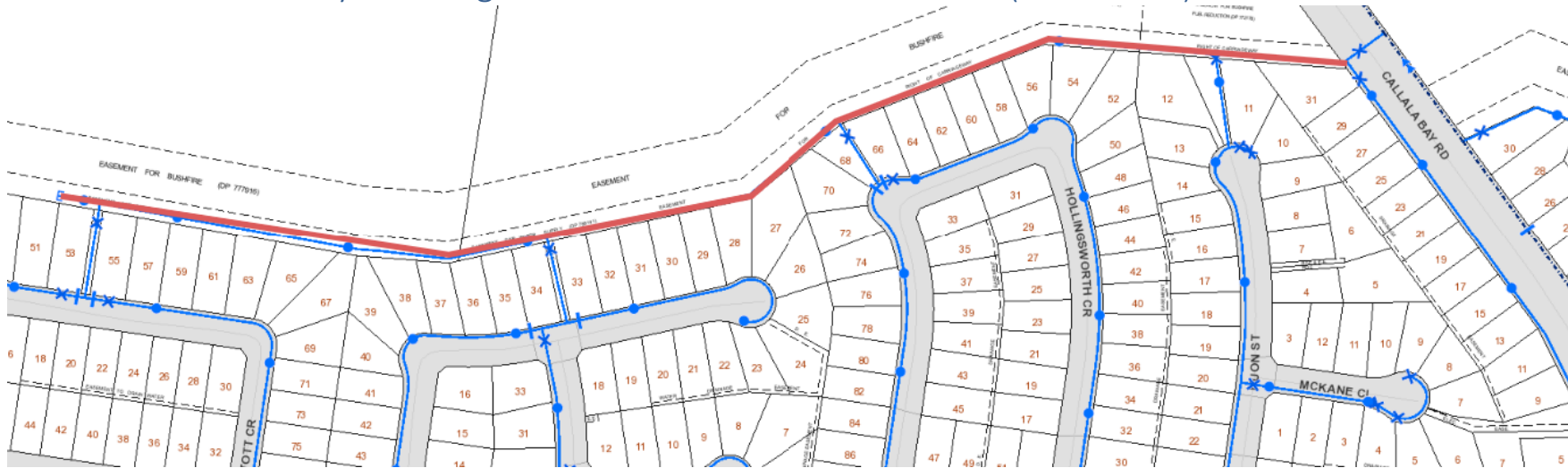

#1G - From Lennox Rd down King Georges St to Centre St (TM12)

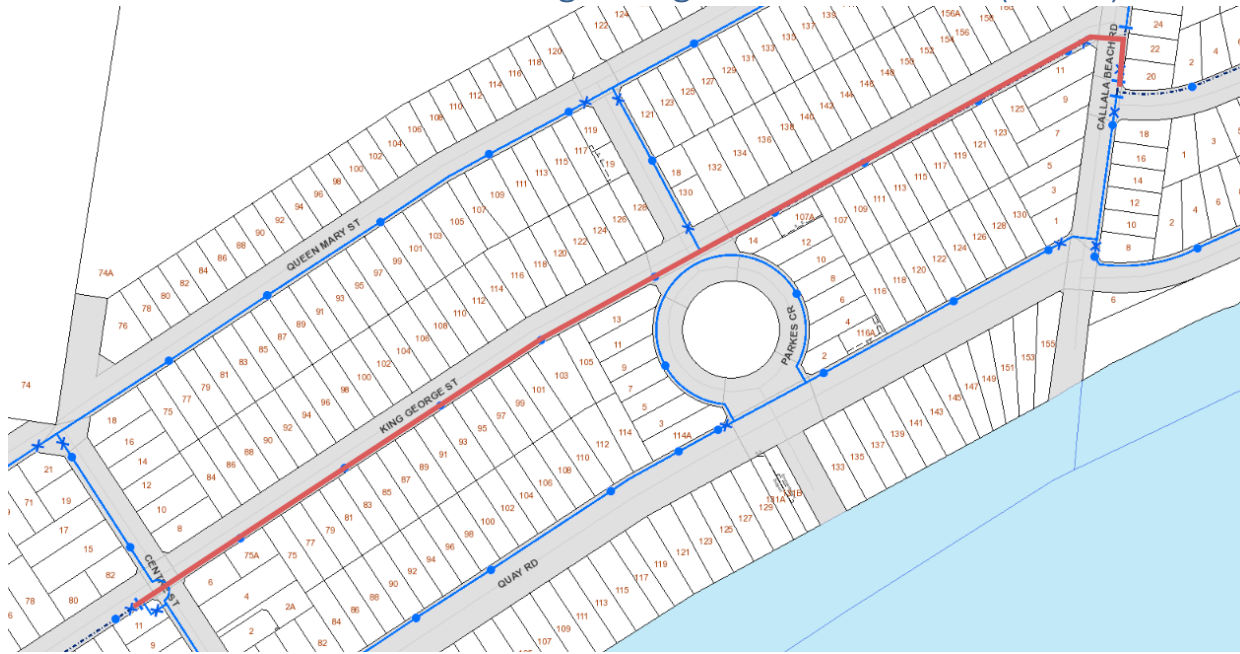

#1H – From Centre St along King Georges St to Sir Henry Cres to Nelson Beach

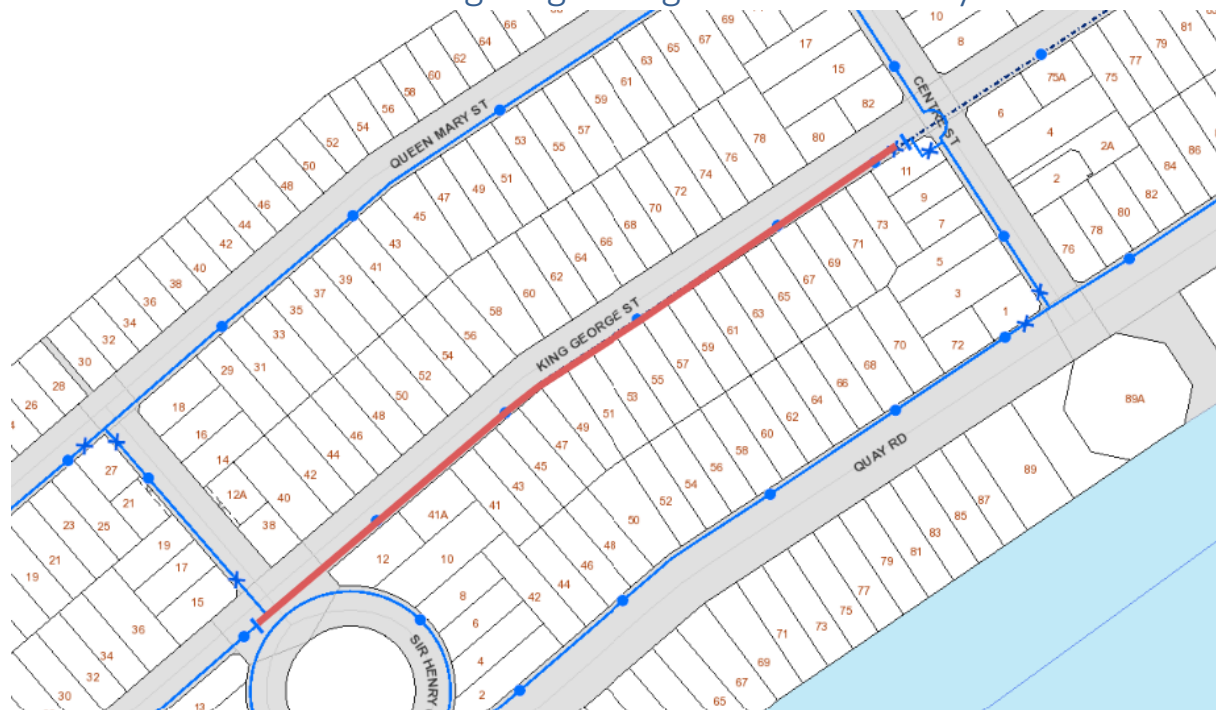

#1I – Culburra Rd/ Mayfield

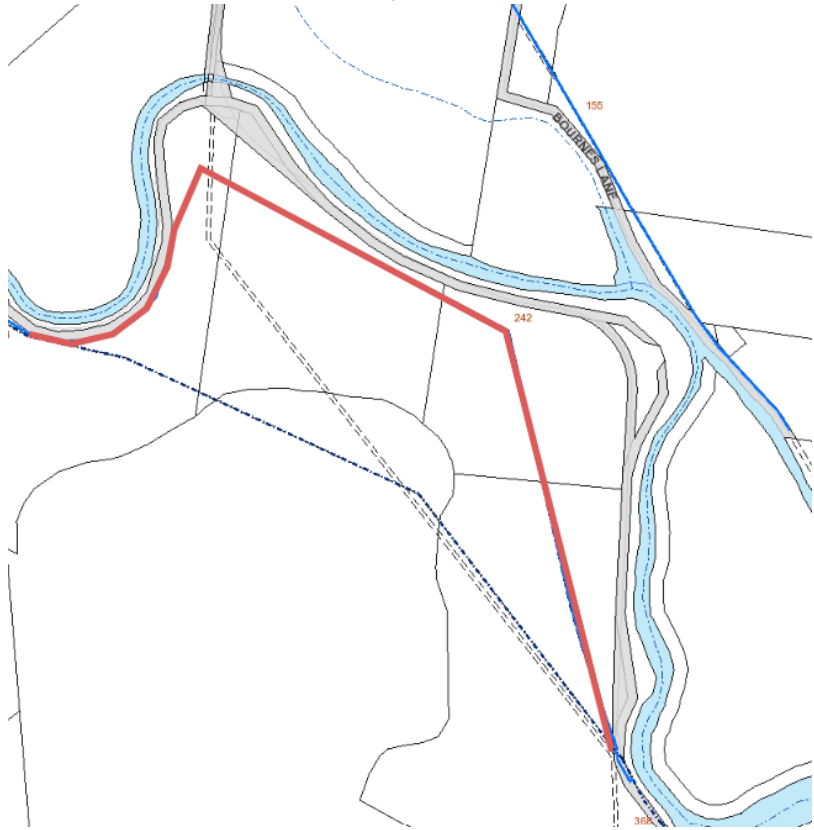

#1J – Ryans Lane

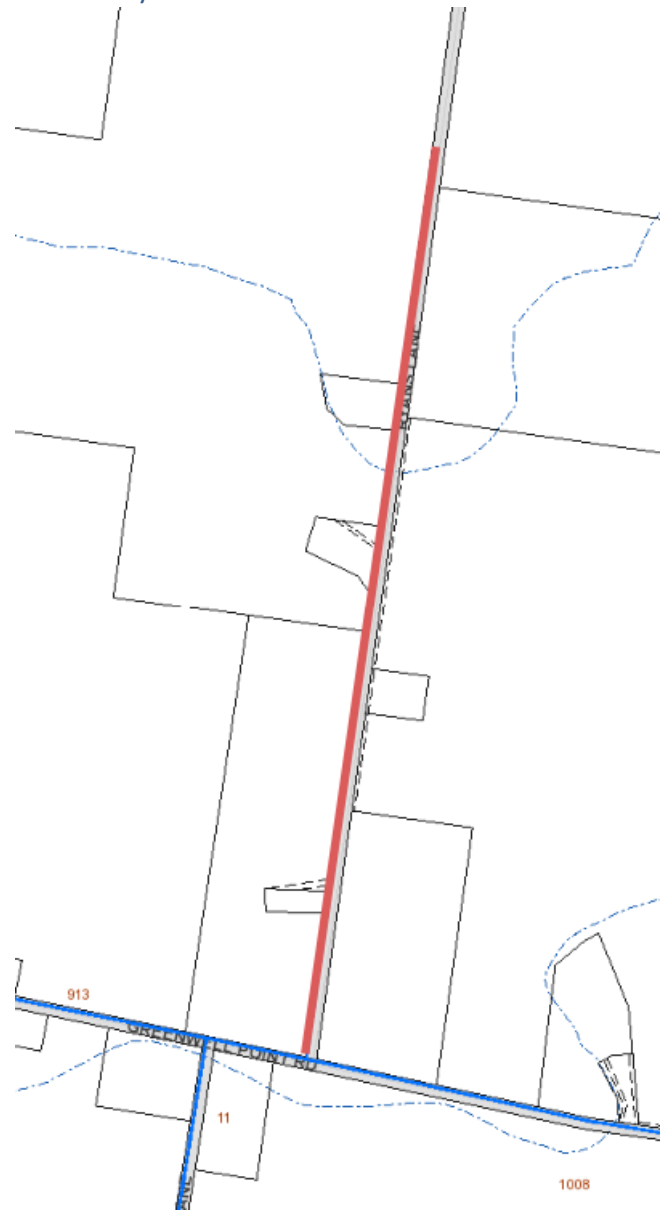

#1K – Apperleys Lane

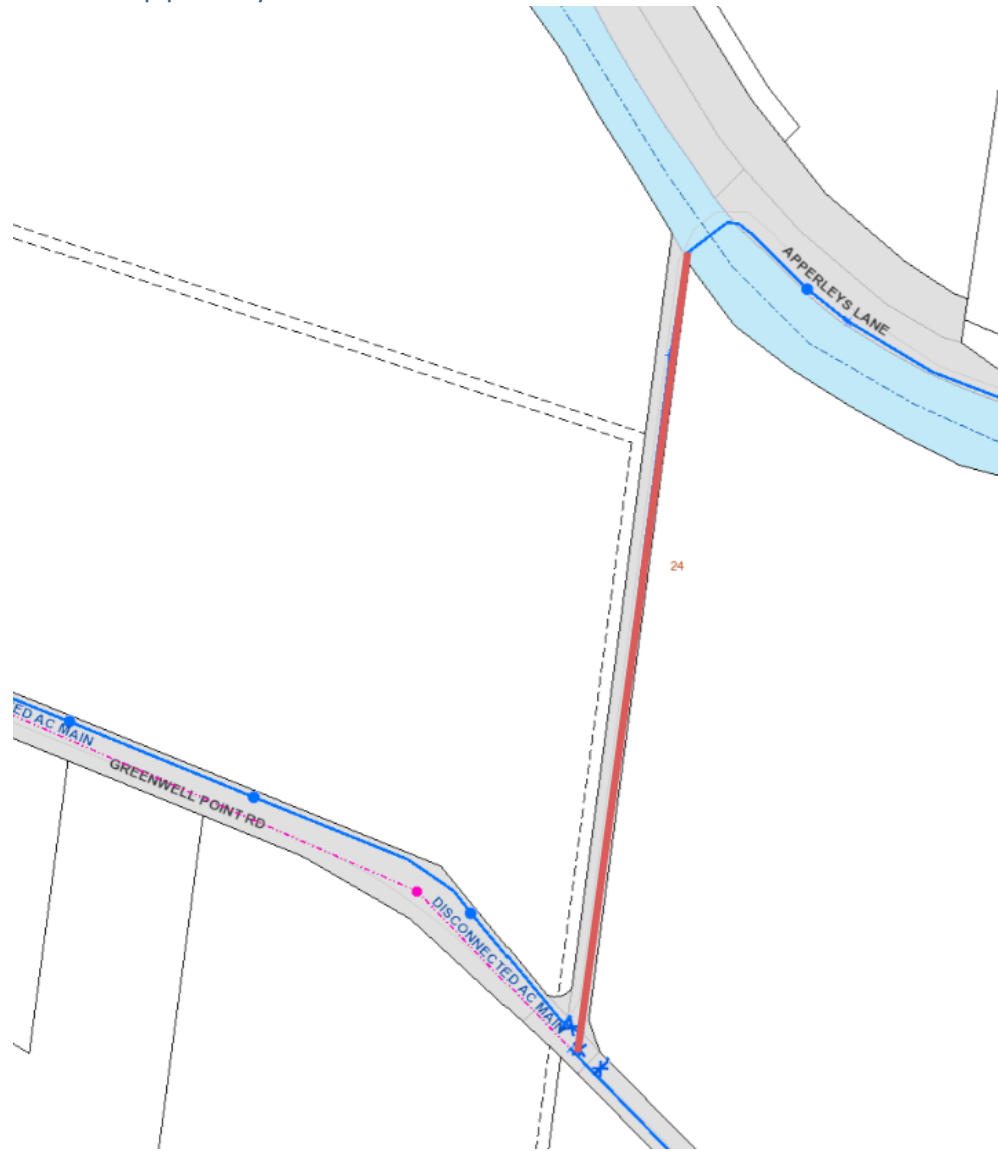

#1L – Bournes Lane



#1M – Woodstock Rd Milton

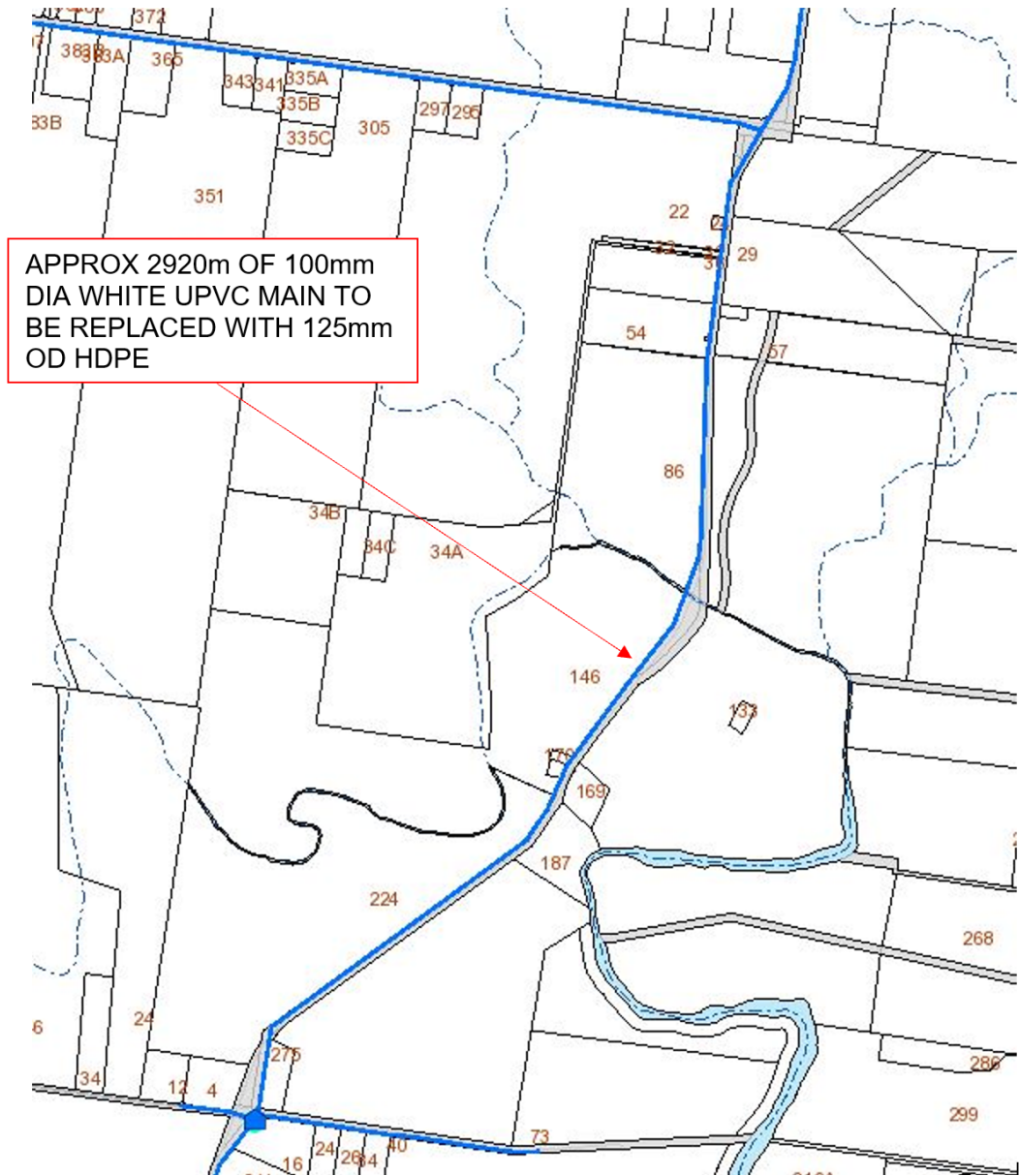

#1N – Croziers Rd Water Main Duplication

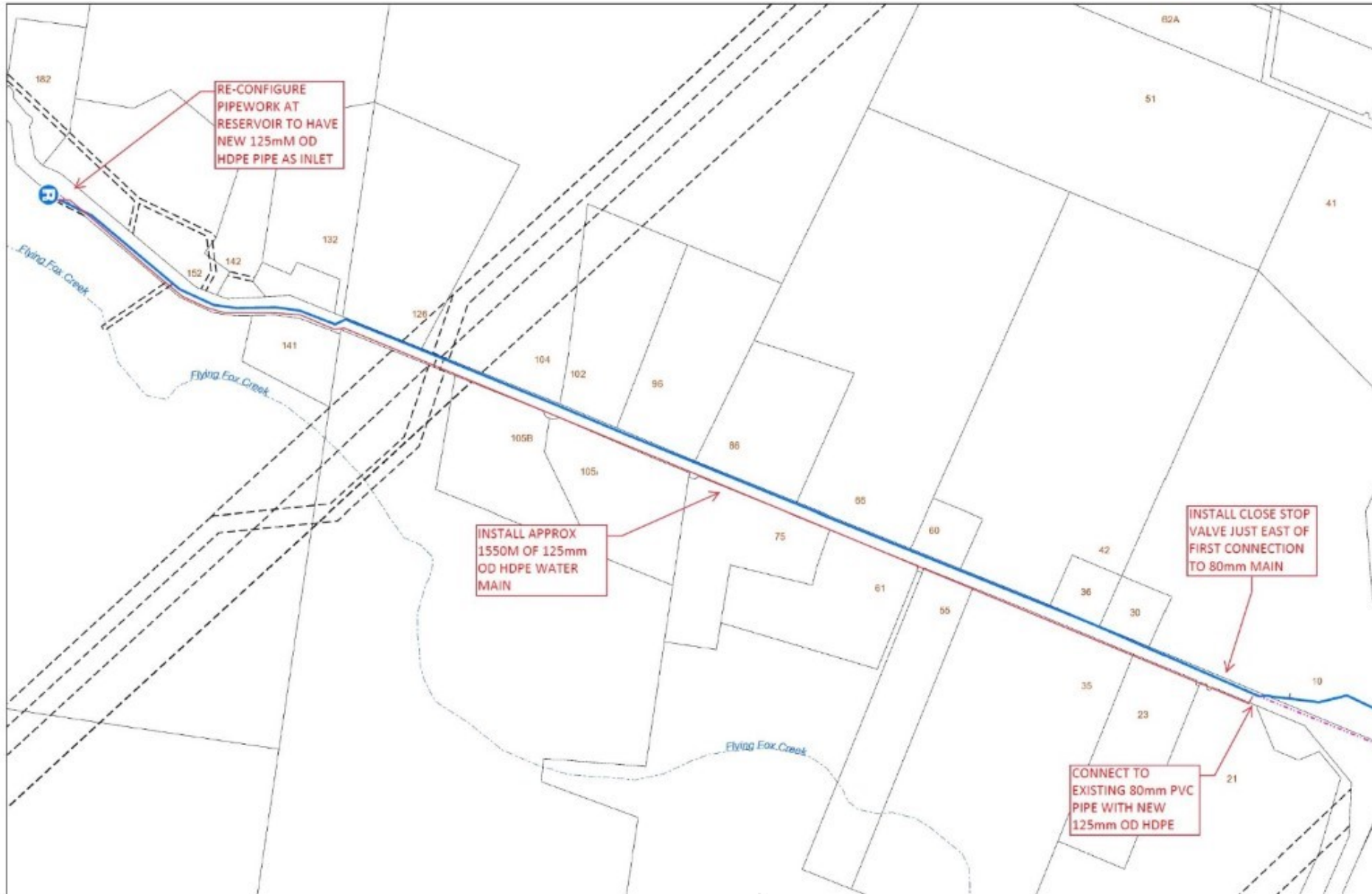

#10 – Kangaroo Valley Reservoir Water Main Duplication

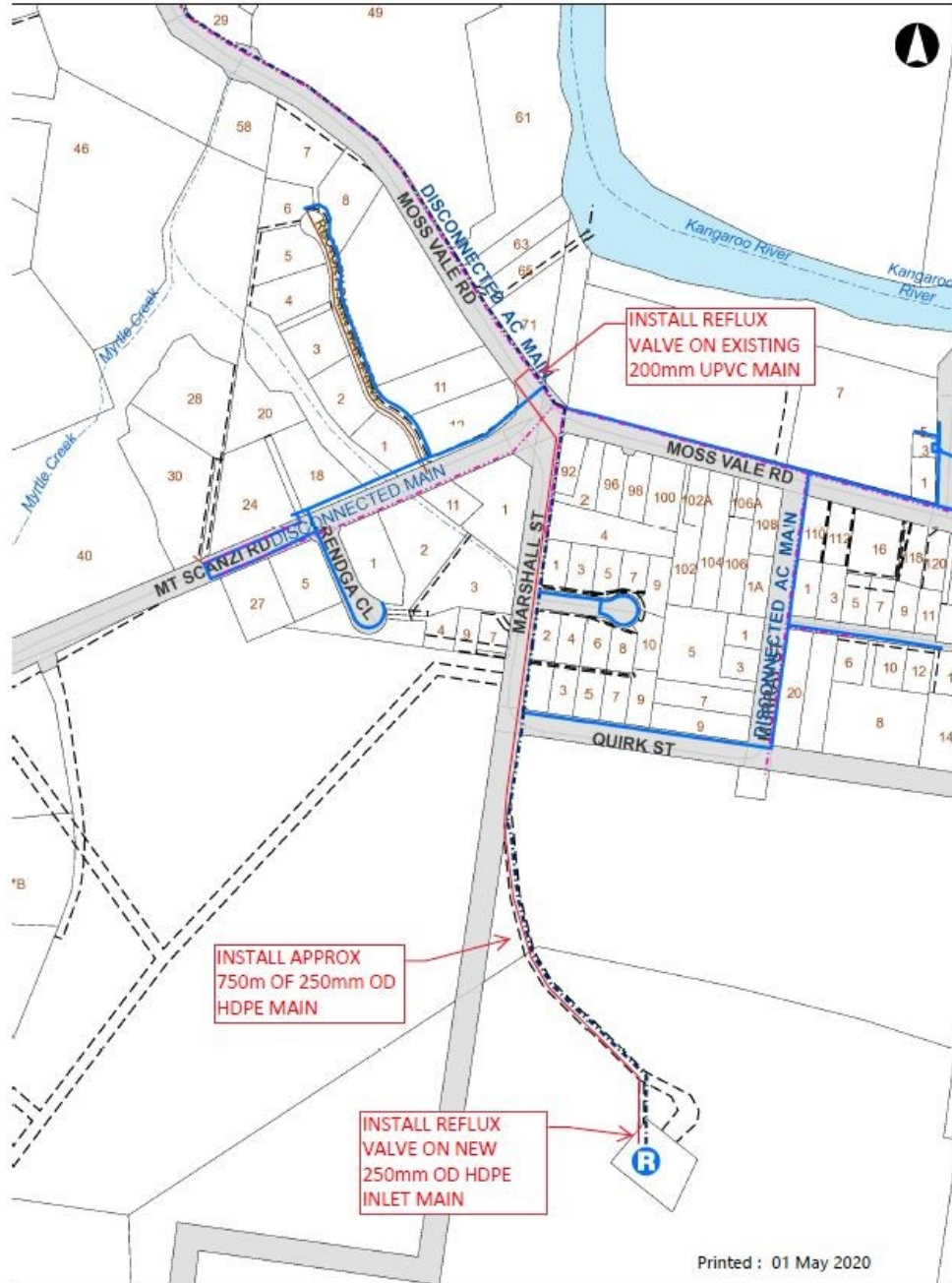

#1P – Currarong Water Main Duplication

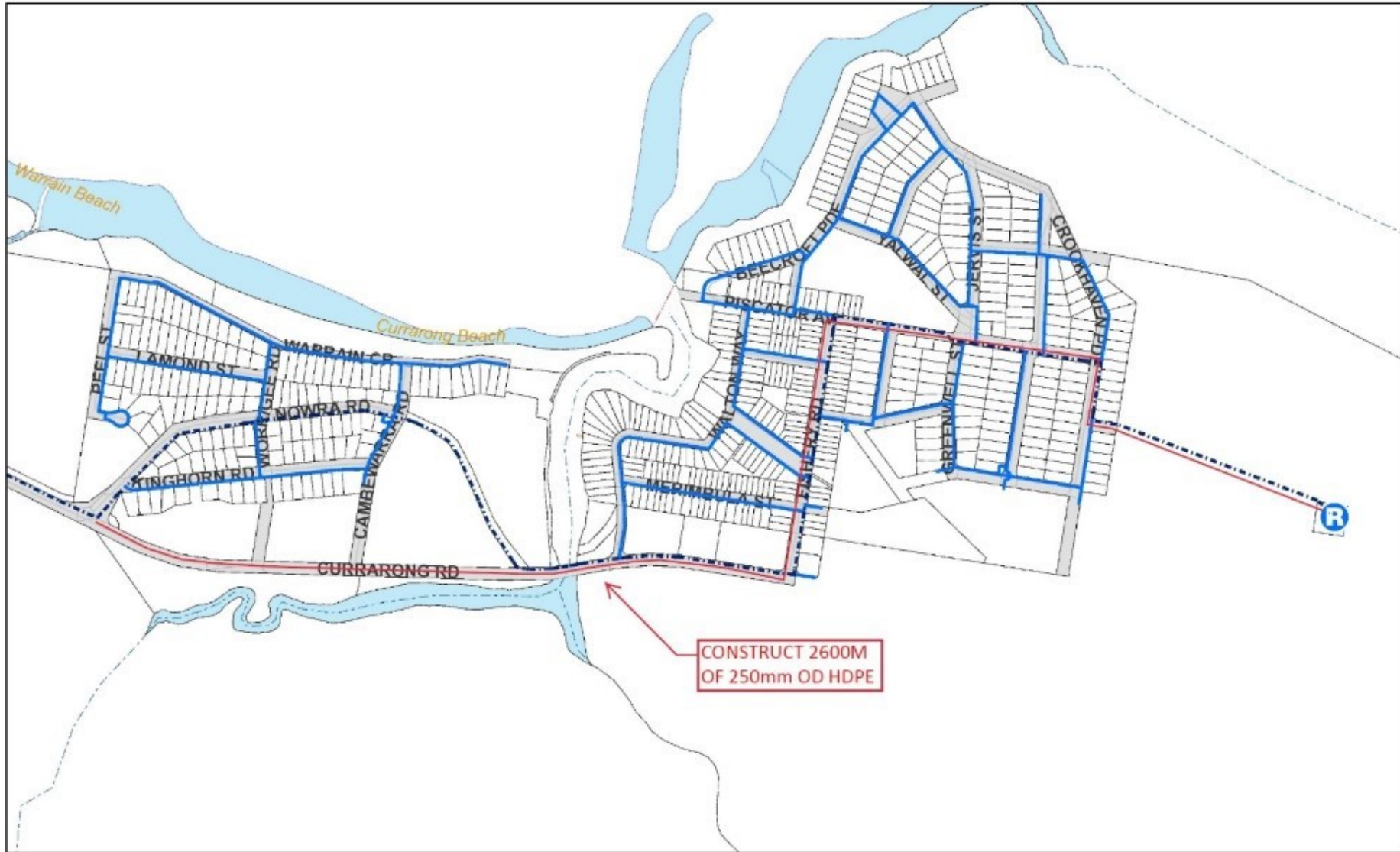

#1Q – Berry from pump station to Res KV Rd (TM50)

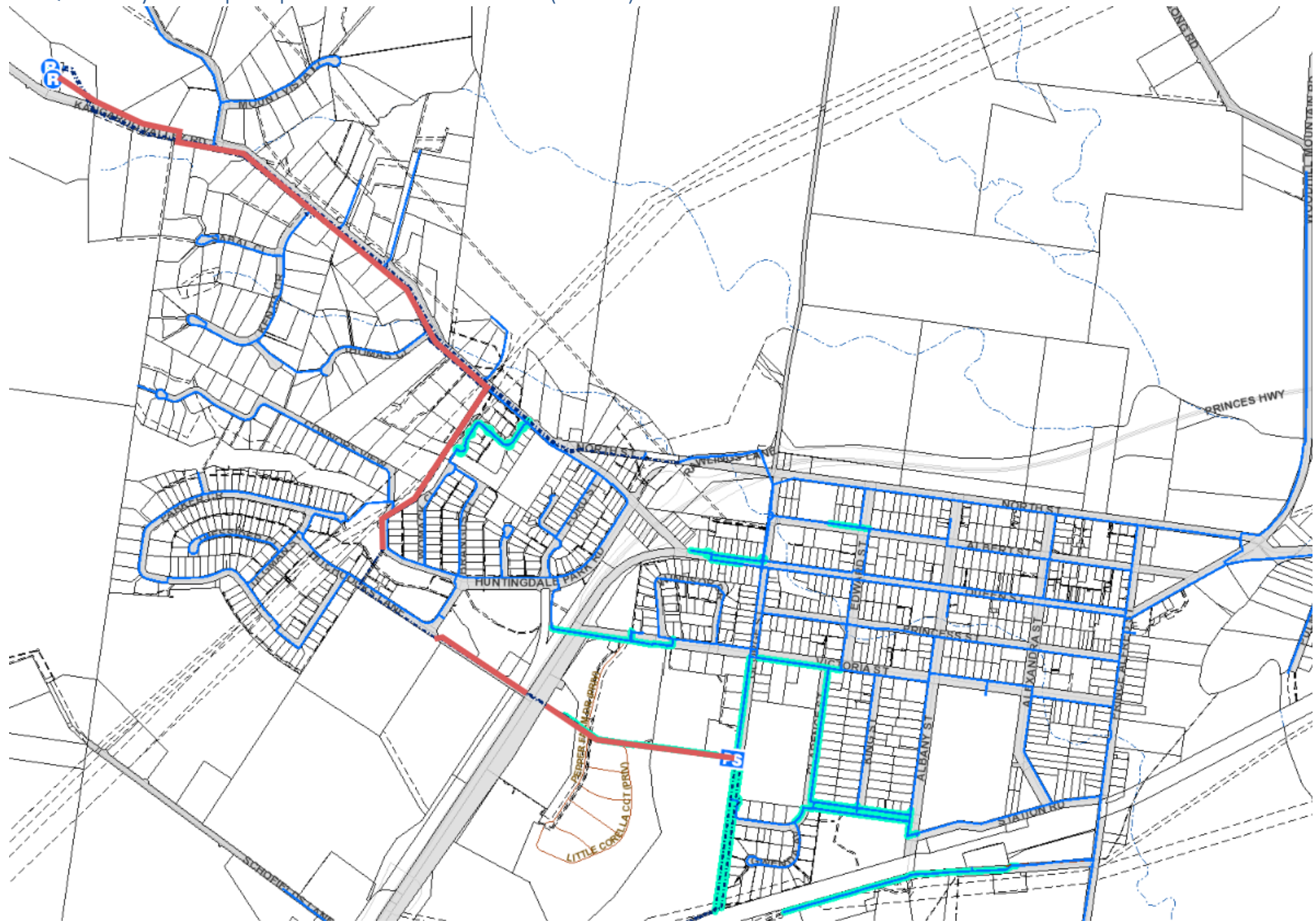

#1R – Kangaroo Valley Road (TM 50).

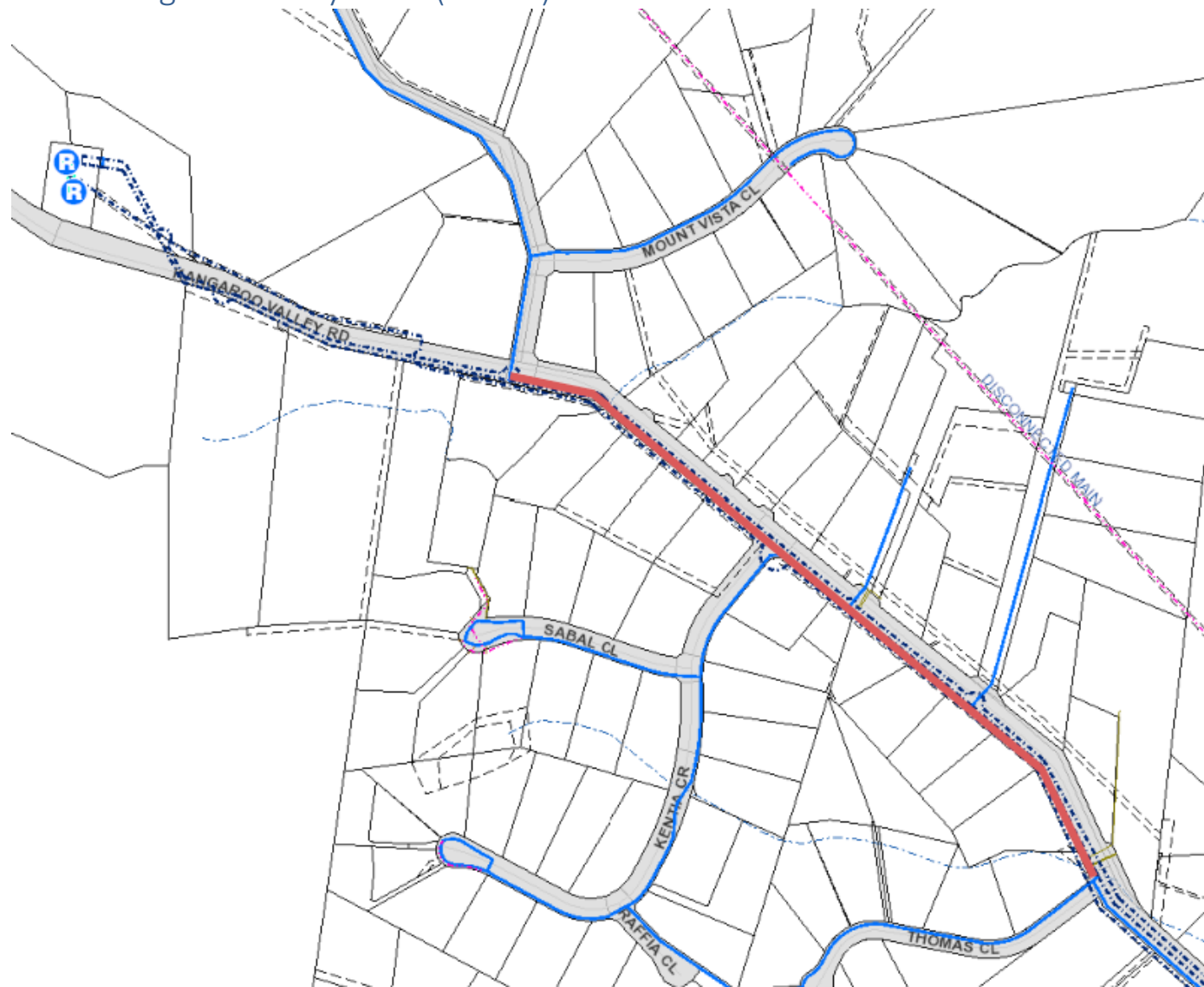

#1S – Croobyar Road

